

# SPECIFICATIONS – MOTOR PUMPS: PB18-LE

## Use Your Engine on our PB18 Pump



Waterous has made available our PB18 Series Portable Pumps without engines. This will enable you to mate the PB18 pump with the engine of your choice using an SAE J609 mounting flange with a special shaft arrangement (see next page).

All models are available with a Waterous hand primer or exhaust primer. (Note: Exhaust primer available for Briggs & Stratton V-Twin engines only). Other optional discharge valves, elbows and fittings are available as listed under each model name.

**Waterous offers a 90-day warranty on the PB18-LE models, unless the pump components have been modified in any way.**

### Models:

#### ***PB18-2515-LE Pump Specifications:***

**Type:**

Combination

**Intake:**

2-1/2 inch female NPT

**Optional Discharge:**

- Ball valve with 1-1/2 inch male NH thread (2515B)
- Ball valve with 1-1/2 inch female NPT (2515B)
- 1-1/2 inch female NPT (2515F) (No Ball Valve)

#### ***PB18-3030-LE Pump Specifications:***

**Type:**

Transfer - Supply

**Intake:**

3 inch female NPT

**Optional Discharge:**

- 3 inch female NPT with check valve (3030C)
- 3 inch female NPT, forward facing, no check valve (3030E)

### Accessories:

Primer - Exhaust type or manual hand type

#### ***PB18-4025-LE Pump Specifications:***

**Type:**

Transfer - Supply

**Intake:**

4 inch male, British round thread with cap and chain

**Optional Discharge:**

- 2-1/2 inch British instantaneous coupling with ball valve
- High-strength stainless steel.

#### ***PB18-G2015-LE Pump Specifications:***

**Type:**

Wildland - Attack

**Gear Case:**

Two-gear speed increaser utilizing high strength aluminum alloy case, helical cut, hardened steel gears and anti-friction bearings throughout.

**Intake:**

2 inch female NPT.

**Optional Discharge:**

- Ball valve with 1-1/2 inch female NPT (G2015B)
- 1-1/2 inch female NPT, no ball valve (G2015F)

### Fuel Tank:

#### ***Available for use in the USA:***

OEM must supply fuel tank. Use only EPA certified fuel system components that meet current low evaporative requirements. Contact Waterous for recommended fuel tank suppliers.

#### ***Available for use outside USA:***

Integral 3 gallon (11 liter) fuel tank with fuel level gauge.

### Industry-Leading Sales and Support

When you purchase Waterous equipment, not only do you get quality products, you get quality service. Our expert service technicians are the best in the business and they are always happy to answer any service questions you might have.

#### **Sales/Applications Assistance**

Phone: 651-450-5234 (Press 3)  
pumpsales@waterousco.com

#### **Service Assistance**

Phone: 651-450-5200  
Fax: 800-488-1228  
service@waterousco.com

**SPECIFICATIONS – MOTOR PUMPS: PB18-LE**

**Required Engine Mounting Configuration**

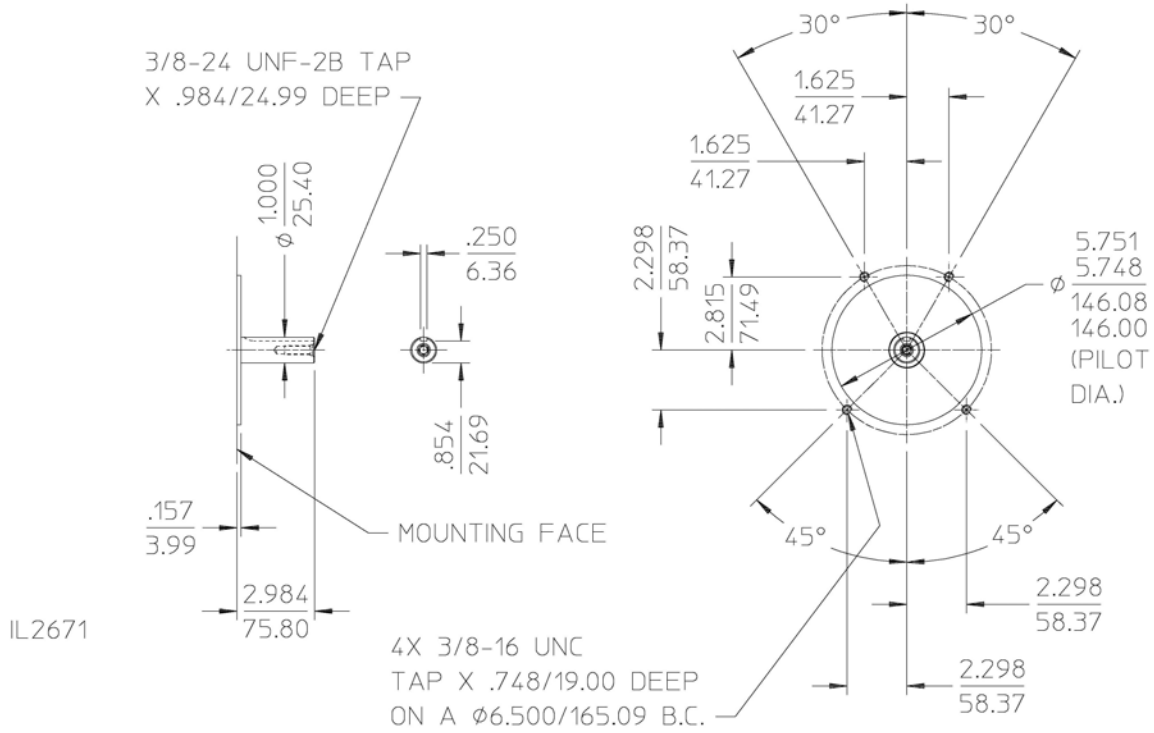

**Pump Dimensions**

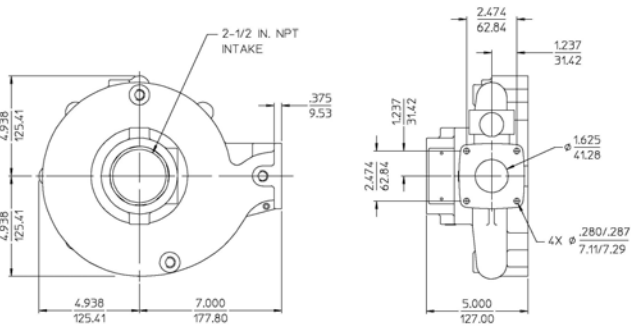

**MODEL PB18-2515-LE**

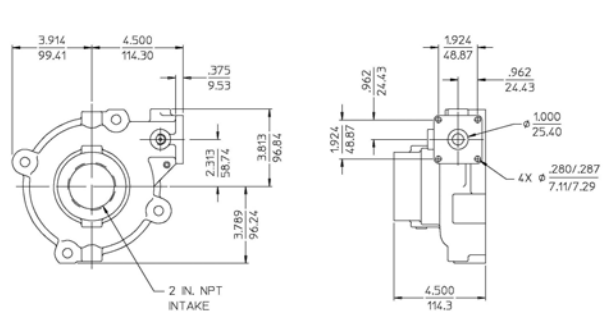

**MODEL PB18-G2015-LE**

IL2678

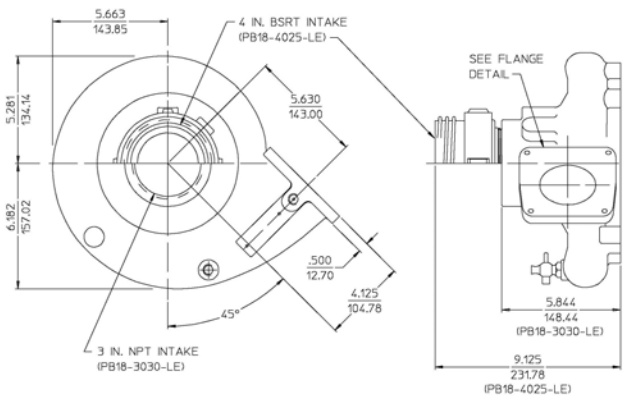

**MODEL PB18-3030-LE & PB18-4025-LE**

ALL DIMENSIONS SHOWN IN INCH/MILLIMETER  
( INCH  
MILLIMETER )