

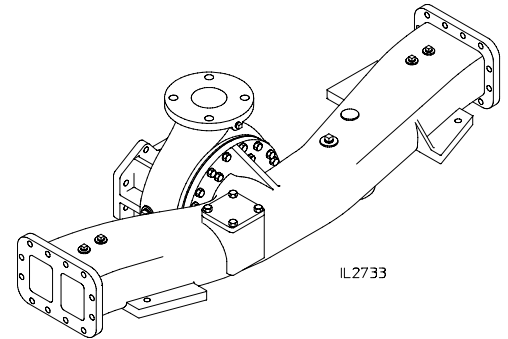

## **SPECIFICATIONS – VEHICLE MOUNTED: MODEL CGVG** **Perfect for Applications Requiring Less Power**

A simple to operate, efficient to run and easy to depend on single stage pump. Efficient performance and modern design make the CGVG pump outstanding in its class. This reliable pump is available with 750 GPM ratings for NFPA 1901 or 500 GPM rating for NFPA 1902.



### **Design Features:**

The CGVG is a single-stage pump designed with a vertically-split body volute and pump transmission, which contribute to simplicity of operation and maintenance. The compact design permits efficient use of frequently limited space above the pump.

The CGVG pump transmission incorporates the rugged Morse HV<sup>®</sup> drive chain designed to operate at high speeds. It supplies a smooth, quiet transfer of power without annoying gear noise.

A wide variety of suction and discharge piping arrangements are available to suit your specific firefighting requirements.

The CGVG pump is designed to operate from draft, booster tank, hydrant, or in relay.

Factory installed and tested accessories are available as options and allow the CGVG pump to be tailored to your needs.

### **Pump Specifications:**

#### **Casing:**

Two-piece, vertically-split, high-tensile, close-grained gray iron, or bronze (optional).

#### **Wear Rings:**

Replaceable bronze wear rings to increase pump life and keep maintenance costs at a minimum.

#### **Impeller:**

Bronze impeller, double-hubbed specifically designed for the fire service and accurately balbanced for vibration-free running. Impeller with flame-plated hub is optional.

#### **Impeller Shaft:**

Stainless steel, heat treated and precisely ground to size. Supported by oil-lubricated ball bearings.

#### **Bearings:**

All bearings are oil-lubricated, ball-type, located outside the pump casing to accurately align and support the impeller shaft assembly. Ball bearings are deep-groove type designed to carry both radial and axial thrust.

#### **Shaft Seal:**

Self-adjusting and wear-resistant mechanical seal is standard.

#### **Flinger Ring:**

Located on impeller shaft between stuffing box and bearing housing as added protection in keeping water and foreign matter out of bearings.

### **Industry-Leading Sales and Support**

When you purchase Waterous equipment, not only do you get quality products, you get quality service. Our expert service technicians are the best in the business and they are always happy to answer any service questions you might have.

#### **Sales/Applications Assistance**

Phone: 651-450-5234 (Press 3)  
pumpsales@waterousco.com

#### **Service Assistance**

Phone: 651-450-5200  
Fax: 800-488-1228  
service@waterousco.com

## SPECIFICATIONS – VEHICLE MOUNTED: MODEL CGVG

### Pump Transmissions

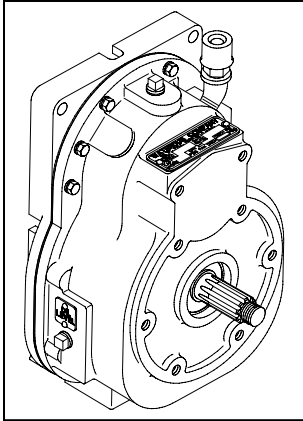

#### K Series

The K Series Transmission is normally used when a truck transmission mounted power take-off is selected as the pump drive.

**Housing:** Close-grained, gray iron

**Gears:** Helical, precision cut, crown shaved for proper load distribution and quiet operation.

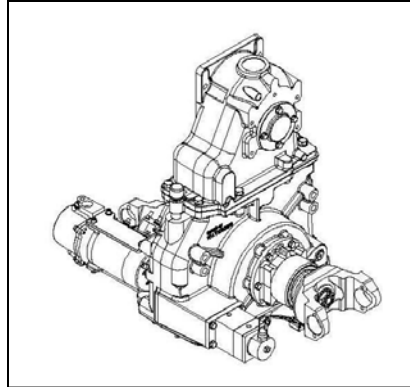

#### C20 Series

The "C20" series transmission is supplied when the pump is to be midship mounted. Power from the truck's automatic transmission is transmitted to the pump.

**Housing:** High-strength aluminum

**Chain:** Morse HV<sup>®</sup>, high-strength involute chain

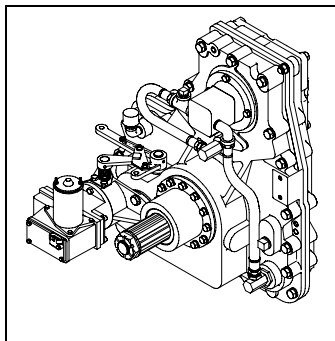

#### WB Series

The "WB" series incorporates a high-strength involute tooth form chain designed to operate at high speeds and provides smooth, quiet transfer of power.

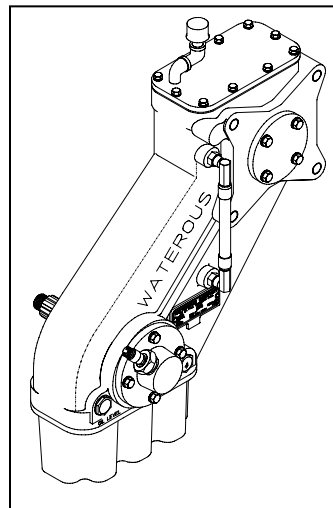

#### PA Series

PA Series transmission is normally used when a truck transmission mounted power take-off is selected as the pump drive. Designed for use with Allison transmissions with 10-bolt PTO.

**Housing:** High-strength aluminum

**Chain:** Morse HV<sup>®</sup>, high-strength involute chain

### Accessories & Optional Equipment

The accessories below are available for Waterous CGVG pumps. For detailed information about these accessories, request each specification sheet by number.

#### Primer

Select an electric rotary vane primer for fast, reliable priming. F-2418

#### Pressure Control Systems

##### Discharge Relief Valve

Simple ON-OFF control permits placing the system in or out of operation in seconds. See Relief Valve, F-897.

##### Intake Relief Valves

The Waterous intake relief valve is designed to dump excess pressure from the inlet side of the pump. See Intake Relief Valves, F-2192.

##### Intake Fittings

Available in 4, 4-1/2, 5 or 6 inch sizes. Each fitting offers a choice of 2-1/2 inch or 3 inch openings for auxiliary suction piping.

#### Corrosion Protection

Waterous offers replaceable zinc intake screens and anodes to provide corrosion protection. These items are designed to sacrifice the zinc element to galvanic corrosion. Without this protection, galvanic corrosion may damage the iron pump body and fittings.

#### Overheat Protection Manager

The OPM consists of an illuminated warning light on the operator's panel whenever the pump approaches an overheat condition. F-24222

#### Drain Valves

Drains all points of the pump simultaneously with the operation of a single control. F-1158

#### Discharge Valves

The following Waterous ball-type discharge valves are available: 2-1/2 inch, 3-1/2 inch, rack and sector push-pull, worm gear and electric. Chrome-plated brass ball and hydraulically-balanced seal assembly standard. See Discharge Valves, F-1161.

#### Tachometer

Tachometer drive available; operates at 1/2 input shaft speed.

