



SPECIFICATIONS – ENDURANCE™: MODEL CXS
Add Compartment Space without Losing Performance

The Waterous CX pump with the new “Ram Horn” intake fitting provides up to 1500 GPM @ 150 psi when using both inlets of the fitting. This space saving, lighter weight pump can be fitted to the next generation C20 split-shaft transmission, PTO driven via our K or PA Transmissions or direct-driven making it an ideal fit for vehicles that just can’t use a traditional midship-mounted pump or an apparatus that just needs more compartment space. Make the CXS even better by integrating a Waterous CAFSystem™. The CXS is backed by a standard five-year warranty. An optional Total Protection Package (TPP-5) is available.



Design Features:

The efficient performance and modern design make the CX series pumps outstanding in their class. The combination of single-stage design and vertically-split volute and pump transmission provide a simple to operate, easy to maintain pump. The use of heavy duty gears, bearings and shafts

provides longer, more trouble-free service and a high reserve capacity.

Factory installed and tested accessories are available as options to tailor the CX pump to your needs.

Pump Specifications:

Casing:

Two-piece, vertically-split, high-tensile, close-grained gray iron, or bronze (optional).

Impeller:

Bronze impeller specifically designed for the fire service, double hubbed to eliminate axial thrust, and accurately balanced for vibration-free running. Impellers with flame-plated hubs for extreme wear resistance are optional.

Wear Rings:

Replaceable bronze wear rings to increase pump life and keep maintenance costs at a minimum.

Impeller Shaft:

Stainless steel, heat treated, precisely ground to size, and polished under shaft seal. Supported by oil-lubricated ball bearings.

Bearings:

All bearings are oil or grease lubricated, ball-type, located outside the pump casting to accurately align and support the impeller shaft assembly. Ball bearings are deep groove type designed to carry both radial and axial thrust.

Shaft Seal:

Face-type, self-adjusting, corrosion and wear resistance mechanical seal is standard.

Intake Fitting

Type	Model	Sizes
Dual Intake (“Ram Horn” Fitting)	CXS	6 inch

Industry-Leading Sales and Support

When you purchase Waterous equipment, not only do you get quality products, you get quality service. Our expert service technicians are the best in the business and they are always happy to answer any service questions you might have.

Sales/Applications Assistance

Phone: 651-450-5234 (Press 3)
 pumpsales@waterousco.com

Service Assistance

Phone: 651-450-5200
 Fax: 800-488-1228
 service@waterousco.com

SPECIFICATIONS – ENDURANCE™: MODEL CXS

Pump Transmissions

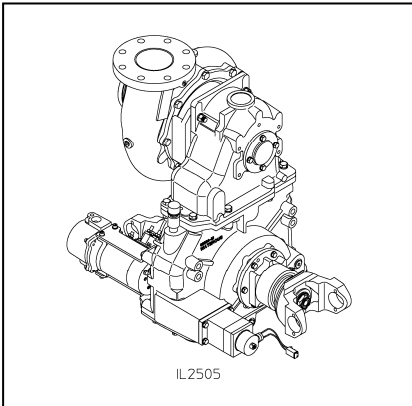

C20 Series

The “C20” series transmission is supplied when the pump is to be midship mounted. Power from the truck’s automatic transmission is transmitted to the pump.

Housing: High-strength aluminum

Chain: Morse HV®, high-strength involute chain

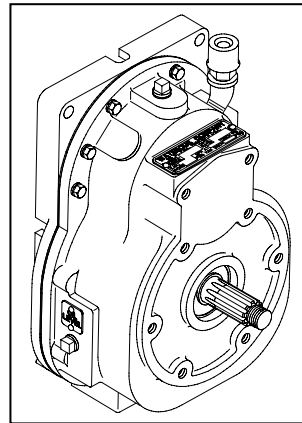

K Series

The K Series Transmission is normally used when a truck transmission mounted power take-off is selected as the pump drive.

Housing: Close-grained, gray iron

Gears: Helical, precision cut, crown shaved for proper load distribution and quiet operation.

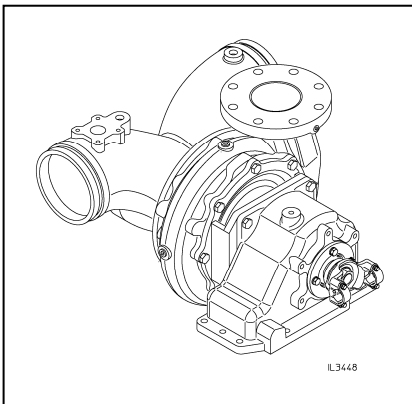

D Series Direct Drive

Used when a truck transmission mounted power take-off is selected as the pump drive.

Housing: High-strength aluminum

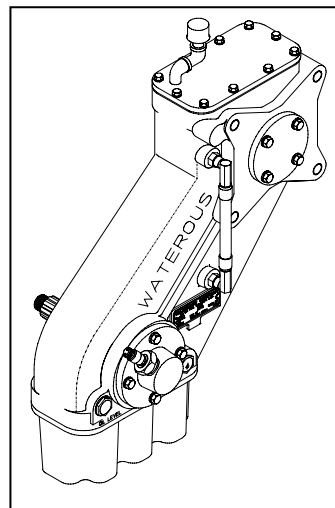

PA Series

PA Series transmission is normally used when a truck transmission mounted power take-off is selected as the pump drive. Designed for use with Allison transmissions with 10-bolt PTO.

Housing: High-strength aluminum

Chain: Morse HV®, high-strength involute chain

Accessories & Optional Equipment

The accessories below are available for Waterous CXS pumps. For detailed information about these accessories, request each specification sheet by number.

Total Protection Package (TPP-5)

The Total Protection Package is a comprehensive warranty that increases your standard warranty to include labor expenses to dismantle, remove and reinstall covered products or parts, F-2626.

Primer

Select an electric rotary vane primer for fast, reliable priming. F-2418

Pressure Control Systems

Discharge Relief Valve

Simple ON-OFF control permits placing the system in or out of operation in seconds. See Relief Valve, F-897.

Intake Relief Valves

The Waterous intake relief valve is designed to dump excess pressure from the inlet side of the pump. See Intake Relief Valves, F-2192.

Corrosion Protection

Waterous offers replaceable zinc intake screens and anodes to provide corrosion protection. These items are designed to sacrifice the zinc element to galvanic corrosion. Without this protection, galvanic corrosion may damage the iron pump body and fittings.

Overheat Protection Manager

The OPM consists of an illuminated warning light on the operator's panel whenever the pump approaches an overheat condition, F-2422

Drain Valves

Drains all points of the pump simultaneously with the operation of a single control. F-1158

Discharge Valves

The following Waterous ball-type discharge valves are available: 2-1/2 inch, 3-1/2 inch, rack and sector push-pull, worm gear and electric. Chrome-plated brass ball and hydraulically-balanced seal assembly standard. See Discharge Valves, F-1161.

Tachometer

Tachometer drive available; operates at 1/2 input shaft speed.