



## Life Cycle Announcement

## ESU1 Pump Replacing S100 / S101 Pumps

**From:** Mike Weinberg, *Waterous Product Manager*

[mjweinberg@waterousco.com](mailto:mjweinberg@waterousco.com)

### Product Migration Path:

Waterous product introduction of the new ESU1 (End-Suction Pump) will replace the S100 Series Pumps and will provide the following additional features over the existing S100 model family. Waterous will continue to support the S100/S101 products with an estimated 20 years after the end of production. NOTE: Dimensional differences / comparisons are on the following pages.



### ESU1 Features and Benefits:

- NFPA rating of 2000 GPM with no added cost of the inducer
- Rated Capacity of 1500 to 2250 with inducer
- Quieter operation with less than 95 dB
- Better performance at low flow ~100 GPM (cavitation and noise)
- Center on Center transmission cap (allow for more room between frame rails)
- Achieve greater than 3500 GPM with positive pressure source
- Available with single or dual-intake fittings

### ESU1 Quoting Date:

- August 24, 2024

### S100/S101 End of Sale:

- December 31, 2024



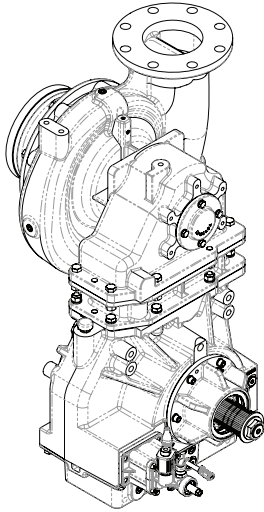

Front Facing Pump  
See sheets 2-3

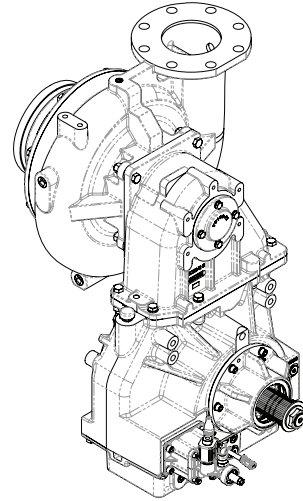

**S100C22**  
 -D drop shown. C thru F available.  
 -400 lbs (Front facing) as shown.  
 -412 lbs (Rear Facing) as shown.  
 -Ratio 2.27 shown.  
 -Inducer is required  
 -Refer to DPL83918 for more details.

**ESU1C22**  
 -D-drop shown. C thru F available.  
 -450lbs as shown.  
 -Ratio 2.27 shown.  
 -Inducer is optional for 2000 GPM and lower.  
 -Refer to DPL83991 for more details.

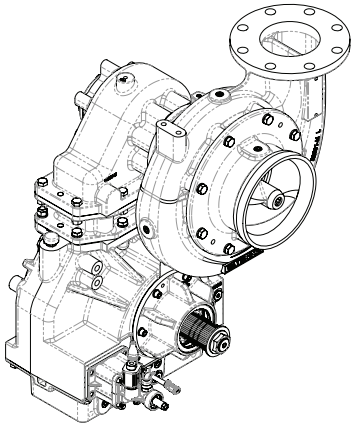

Rear Facing Pump  
See sheets 4-5

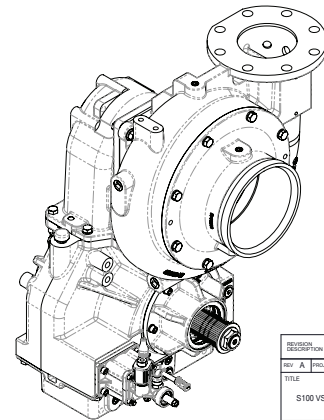

REVISION		RELEASED BY ENGINEERING			
REV. A	PROJECT ECR 1482	REVISED 11/06/24	DESIGN JAS2	DRY DRG HYT	
TITLE		SCALE 1:1	DATE	DATE	
S100 VS ESU1 COMPARISON		DATE JAS2	DATE	DATE	
		DATE HYT	DATE 11/6/2024	DATE	
MODEL ESU1		DATE	DATE	DATE	
<b>WATEROUS</b>		SK20241101			
<small>WATEROUS COMPANY • 55 WESTERN AVENUE SOUTH • SOUTH ST. PAUL, MINNESOTA 55108-1000</small>					

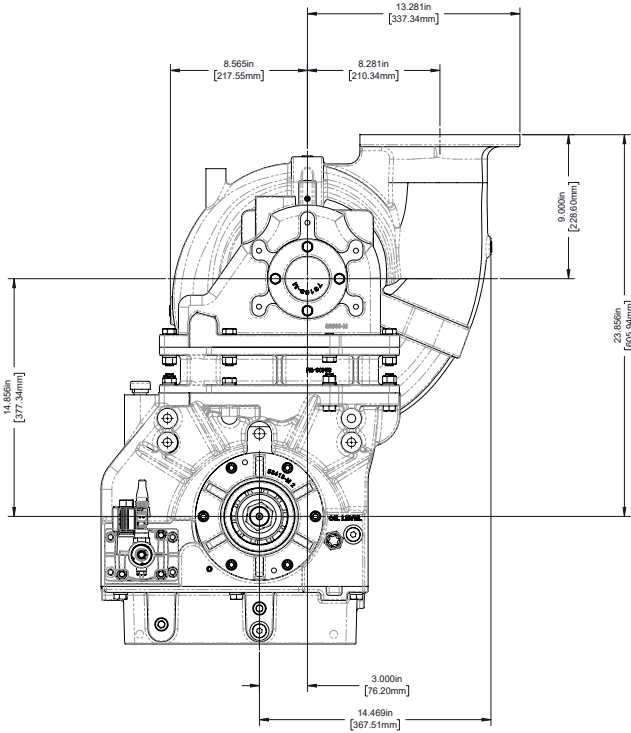

**S100C22**  
-D drop shown. C thru F available.

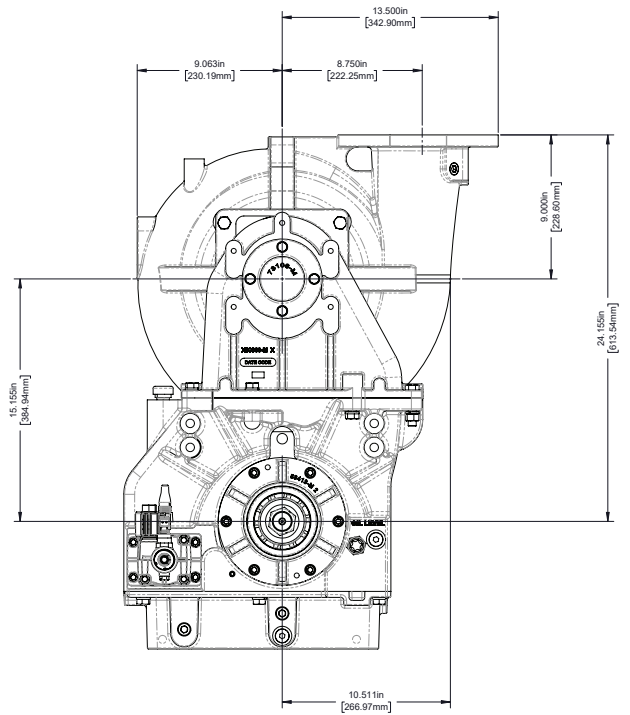

**ESU1C22**  
-D drop shown. C thru F available.

## Front Facing Pump

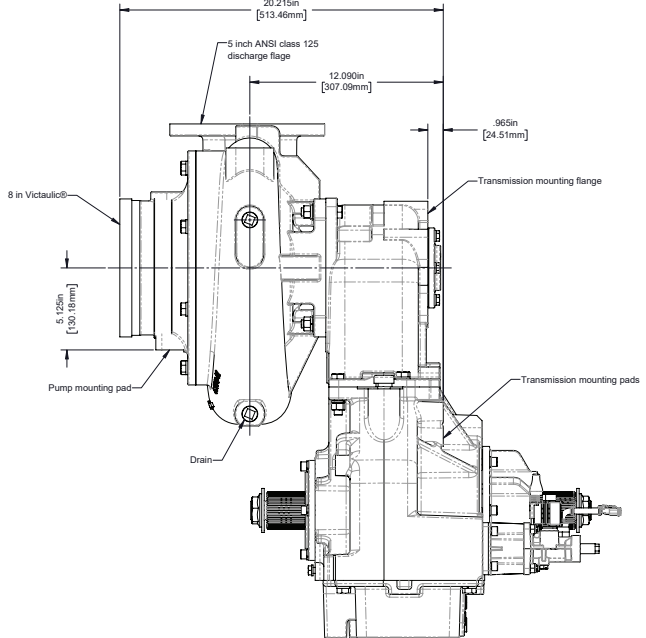
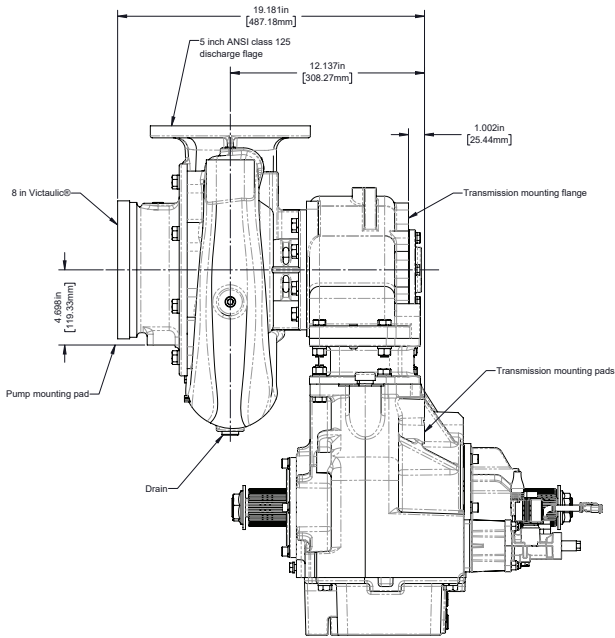
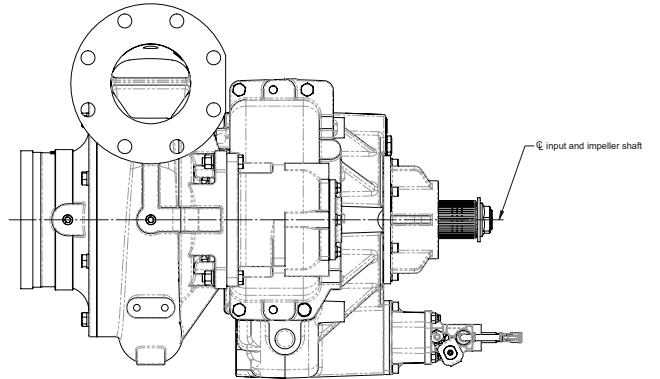
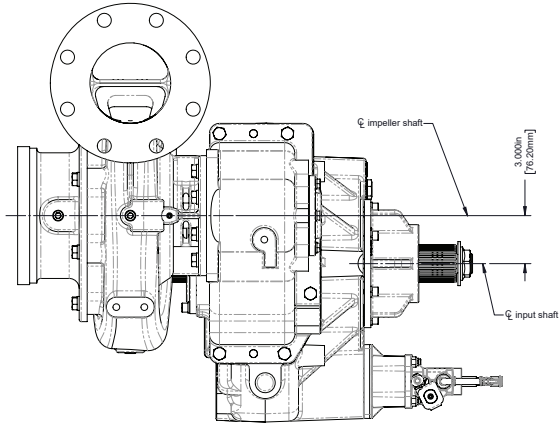

**S100C22**  
-D drop shown. C thru F available.

**ESU1C22**  
-D drop shown. C thru F available.

**Front Facing Pump**

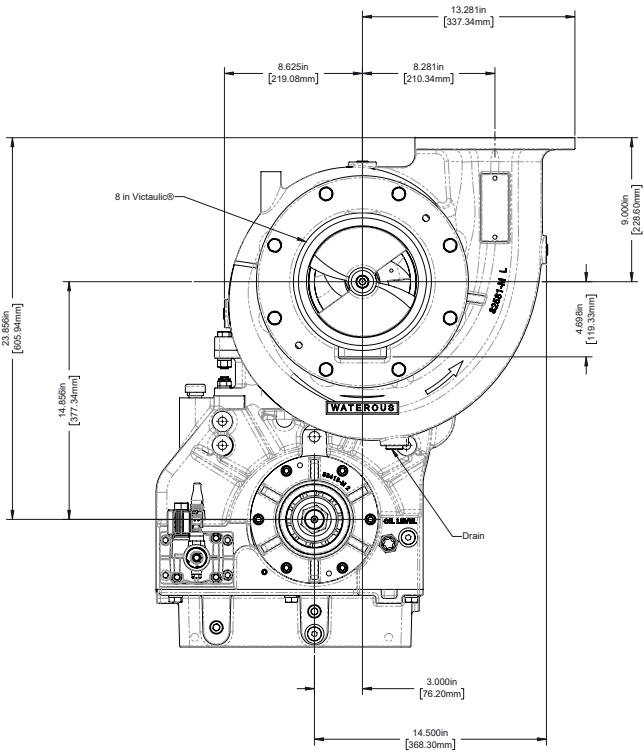

**S100C22**  
 -D drop shown. C thru F available.

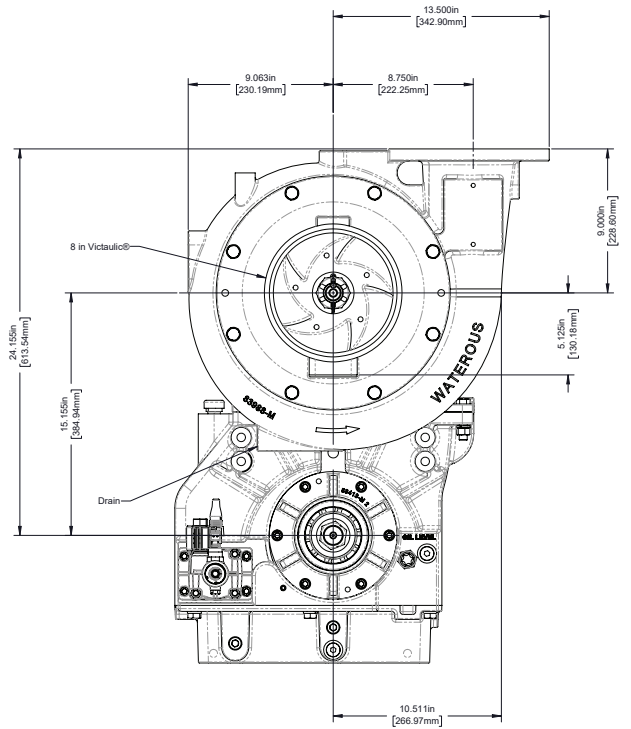

**ESU1C22**  
 -D drop shown. C thru F available.

Rear Facing Pump

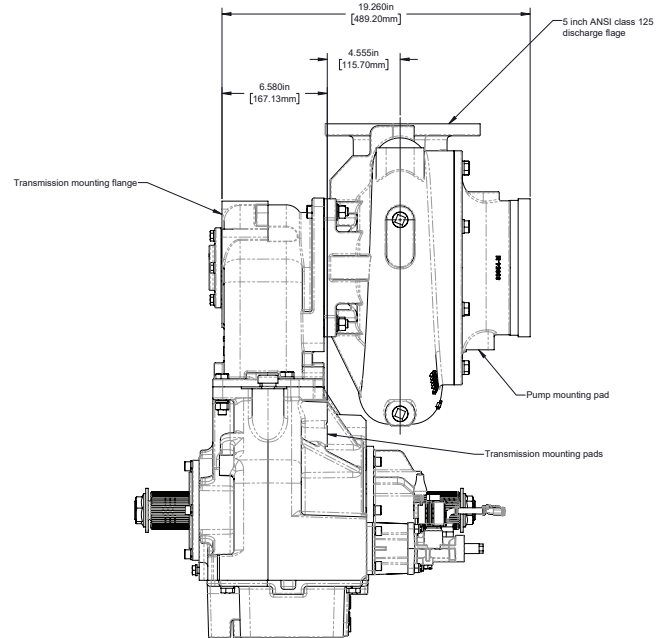
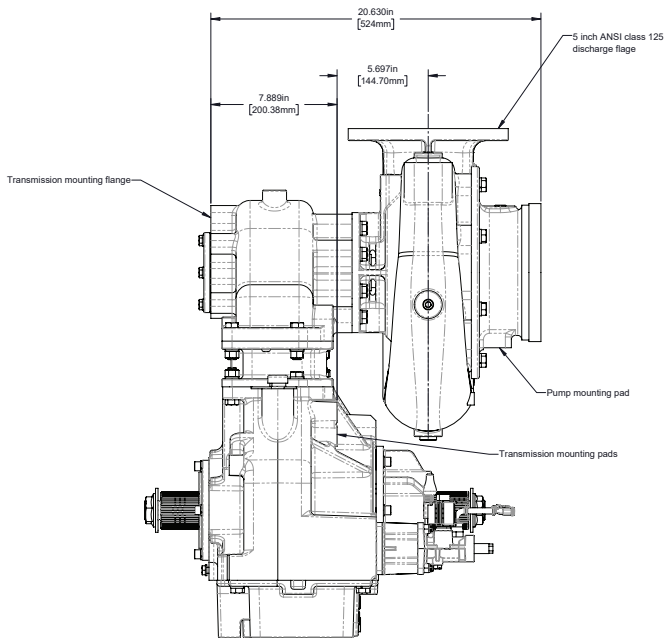
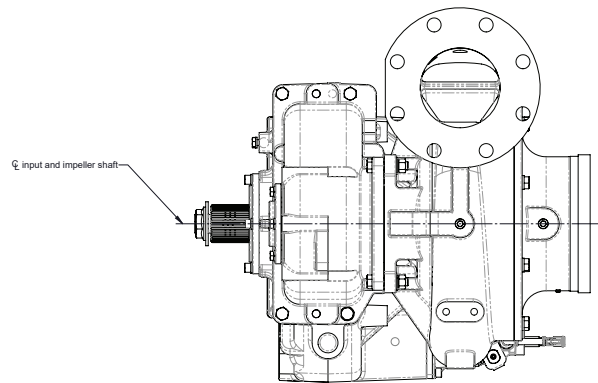
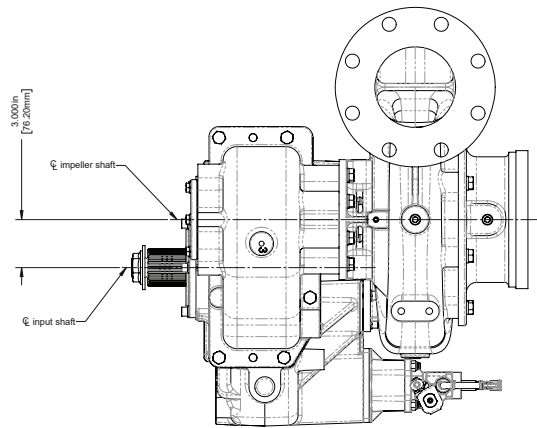

**S100C22**  
-D drop shown. C thru F available.

**ESU1C22**  
-D drop shown. C thru F available.

Rear Facing Pump

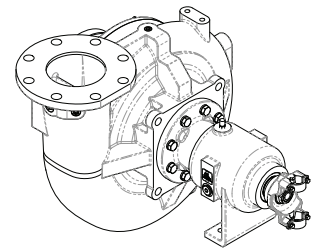
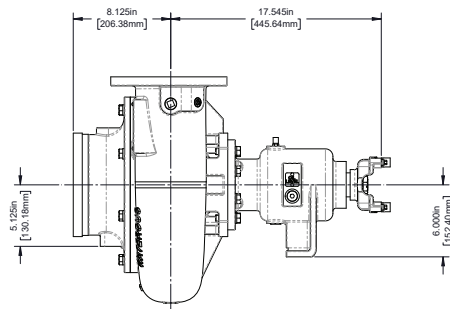
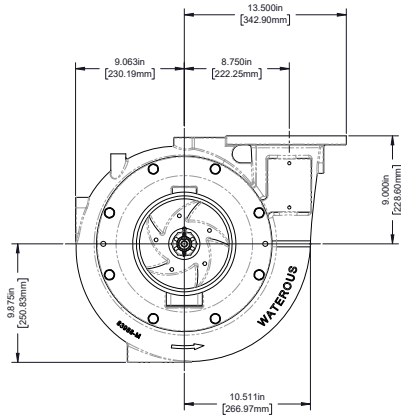

**ESU1D**

-CW input shown.  
-Refer to DPL83991 for more details.

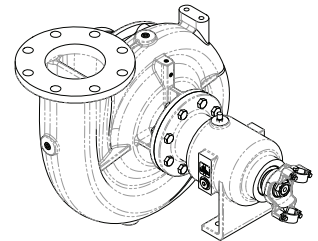
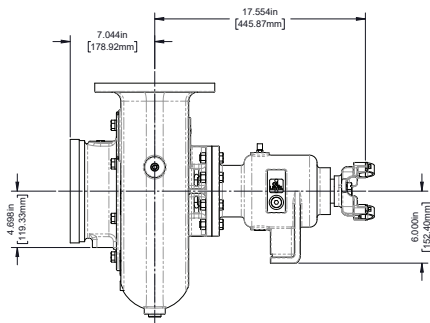
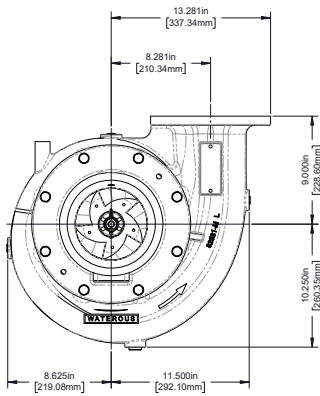

**S100D**

-CW input shown.  
-Refer to DPL83918 for more details.