

Technical Bulletin No. 144

PB18 Series Portable Pumps

Waterous PB18 Portable Pumps with a Wrap-Around Frame will be available to order beginning on April 15, 2024. The PB18 is equipped with a Briggs and Stratton V-Twin 18HP engine with a top-mounted 9-quart (9.5 L) fuel tank. Note that the PB18 with a Rail Base or No Base will have a Briggs and Stratton V-Twin 18HP engine but will not have a top-mounted fuel tank. The fuel tank will ship loose. Other features and information are listed below:

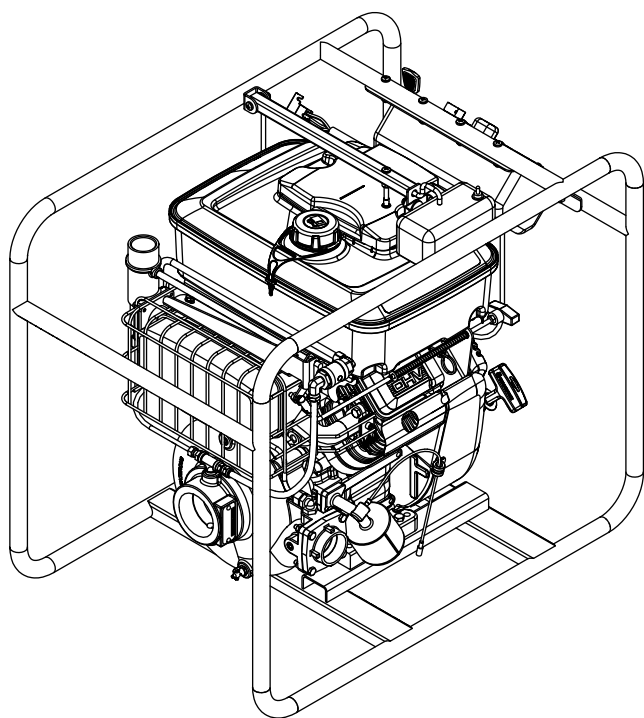

PB18

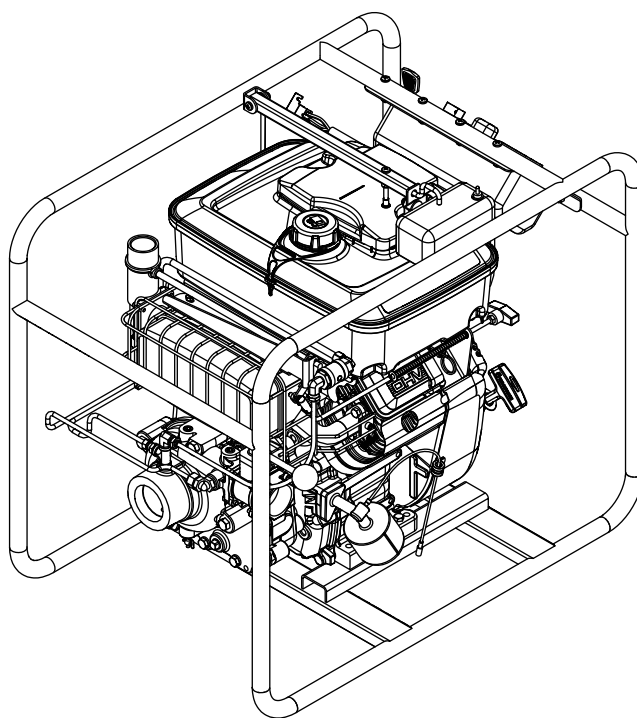

PB18-G

Features and Information:

- Fuel tank is part of the Briggs & Stratton engine located on top of the engine.
- Overall height changed to 26 inches (66.04 cm). Previous wrap-around model height was 21-1/2 inches (54.6 cm).
- Optional operator's panel includes discharge pressure gauge, compound intake pressure gauge, start and stop control, speed control, and panel light.
- Optional combination spark arresting muffler with exhaust primer and quarter-turn bronze priming valve, which operates with push/pull knob.
- Optional rectangular halogen mast light: 5.625 inches x 2.875 inches, 949 lumens.
- Four models available: PB18-2515, PB18-3030, PB18-2015 and PB18-4025.

Wrap-Around Frame Dimensions

All dimensions shown as inch/millimeter.

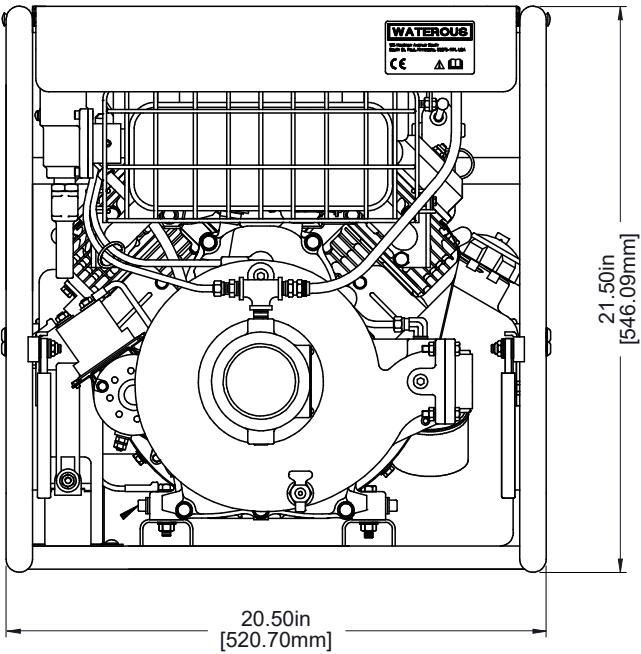

PB18 (Previous Frame)

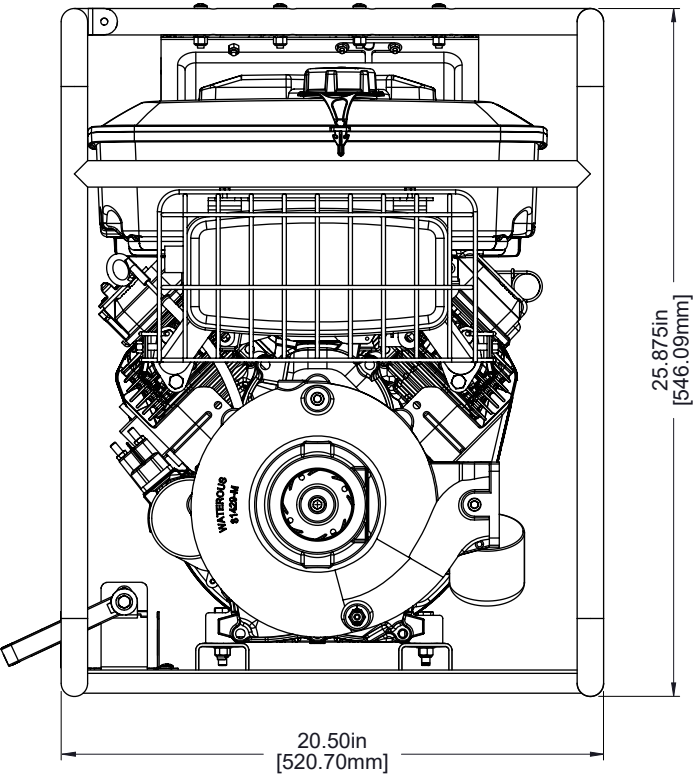

PB18 (Current Frame)