

Dimensional Drawings for CP-4 Series Fire Pumps

| Pump Series | Drive | | Pump Model | See Page | | | |
|-------------|------------------------------------|-------------------|------------|-----------------------|----------------------------------|--------------------------|---------------------------------|
| | Transmission Models | Input Rotaion (1) | | Basic Pump Dimensions | Pump and Transmission Dimensions | Pump Discharge Positions | Transmission Mounting Positions |
| CP-4 | Medium Duty K | CW | CPK-4 | 2 | 3 | 5 | 6 |
| | Medium Duty K With Hydraulic Input | CW | CPK-4 | 2 | 3 | | |
| | Medium Duty T | CW | CPT-4 | 2 | 4 | | |

Note:
1. Input rotation is viewed looking directly at the transmission input shaft.

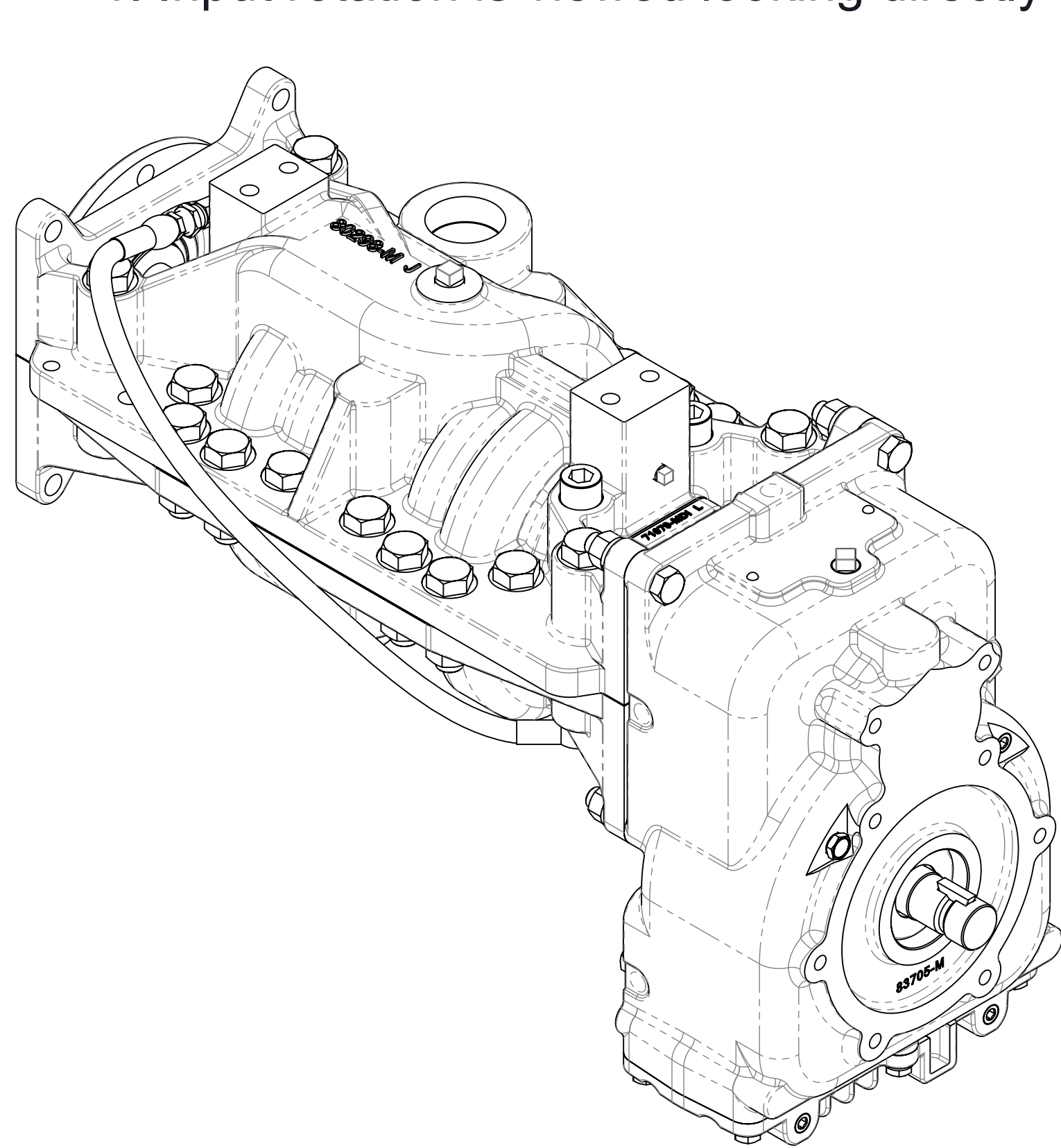

CPK-4

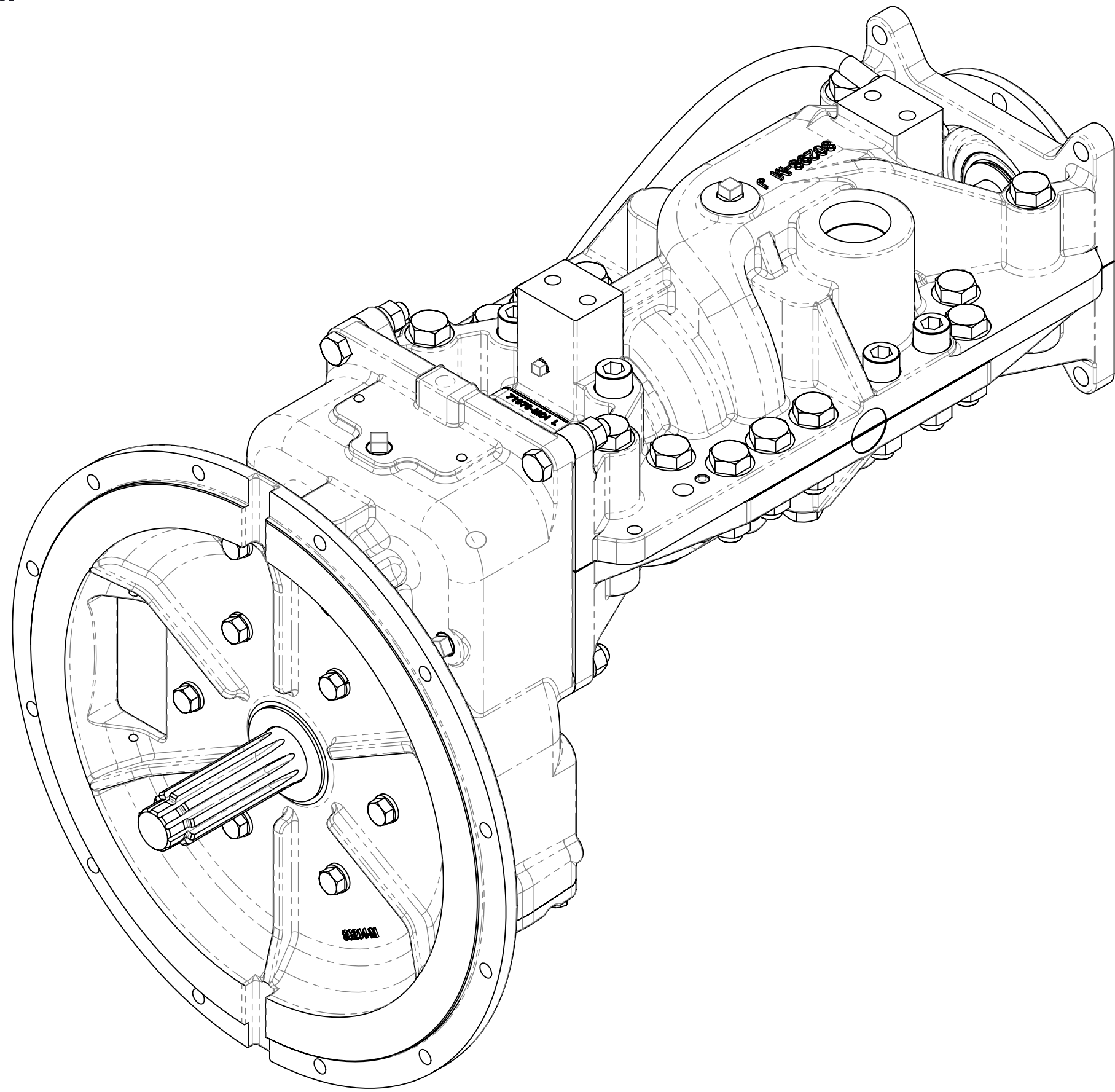

CPT-4

Note: Pump must be installed in accordance with Waterous installation instructions.

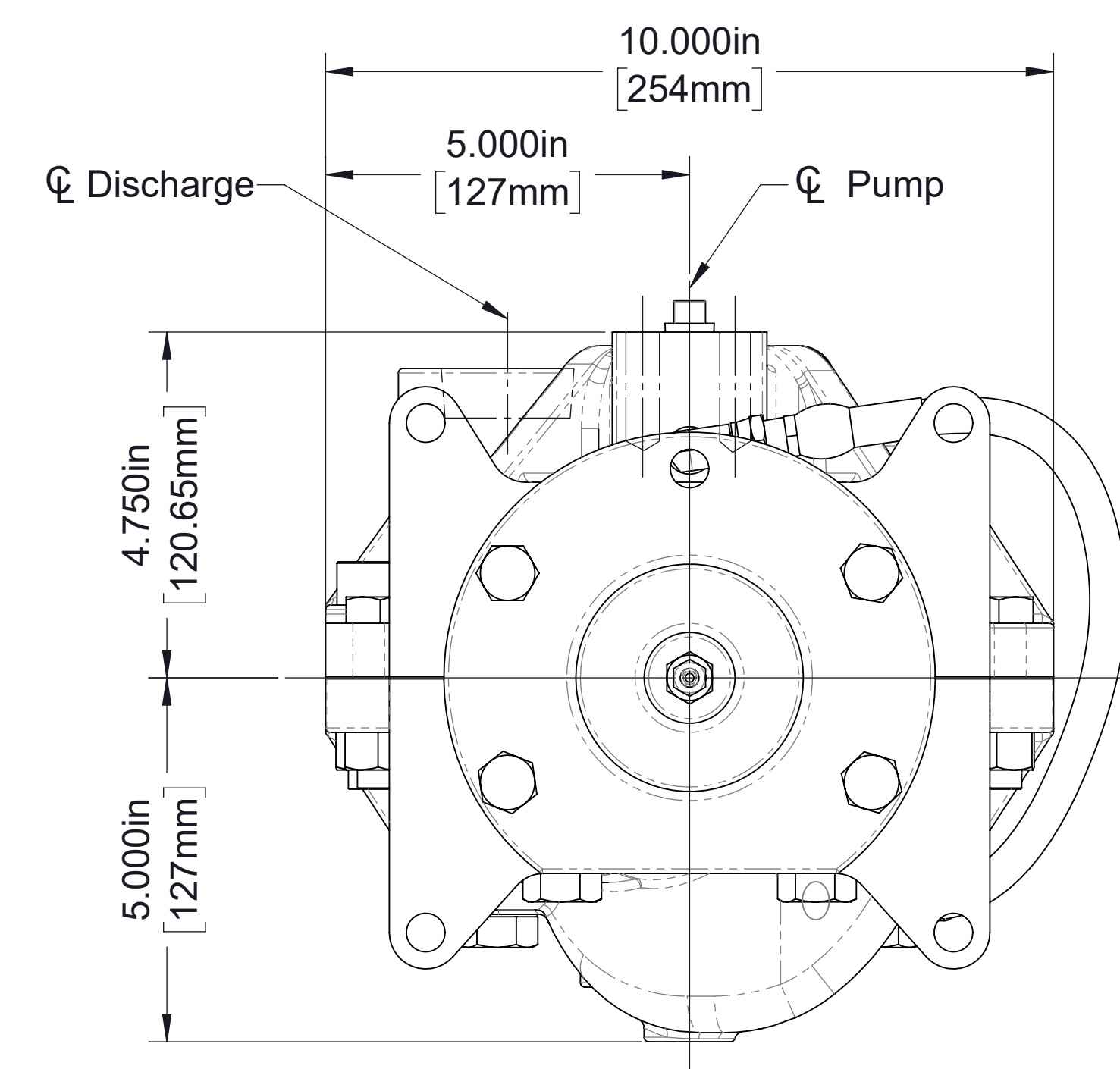
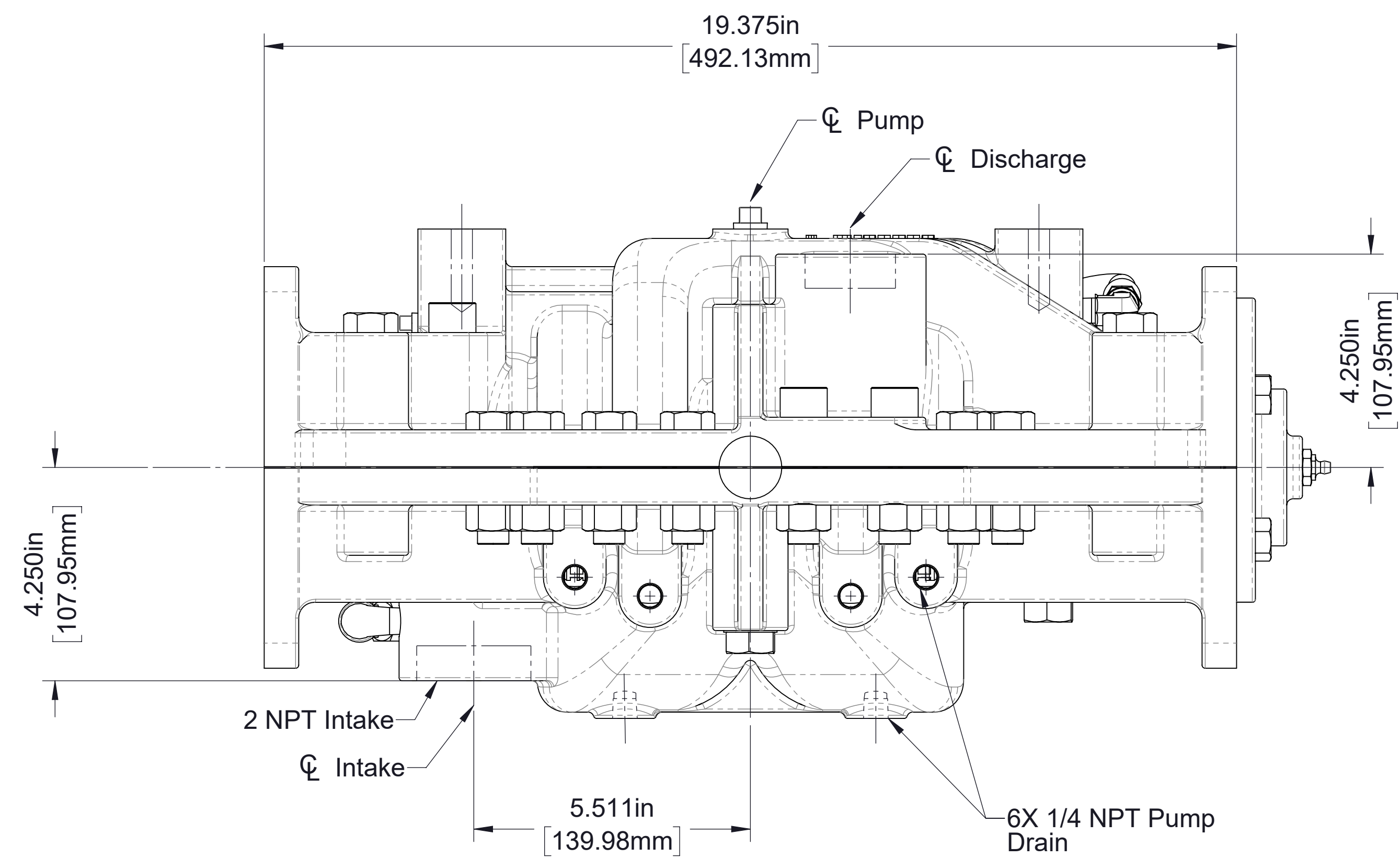
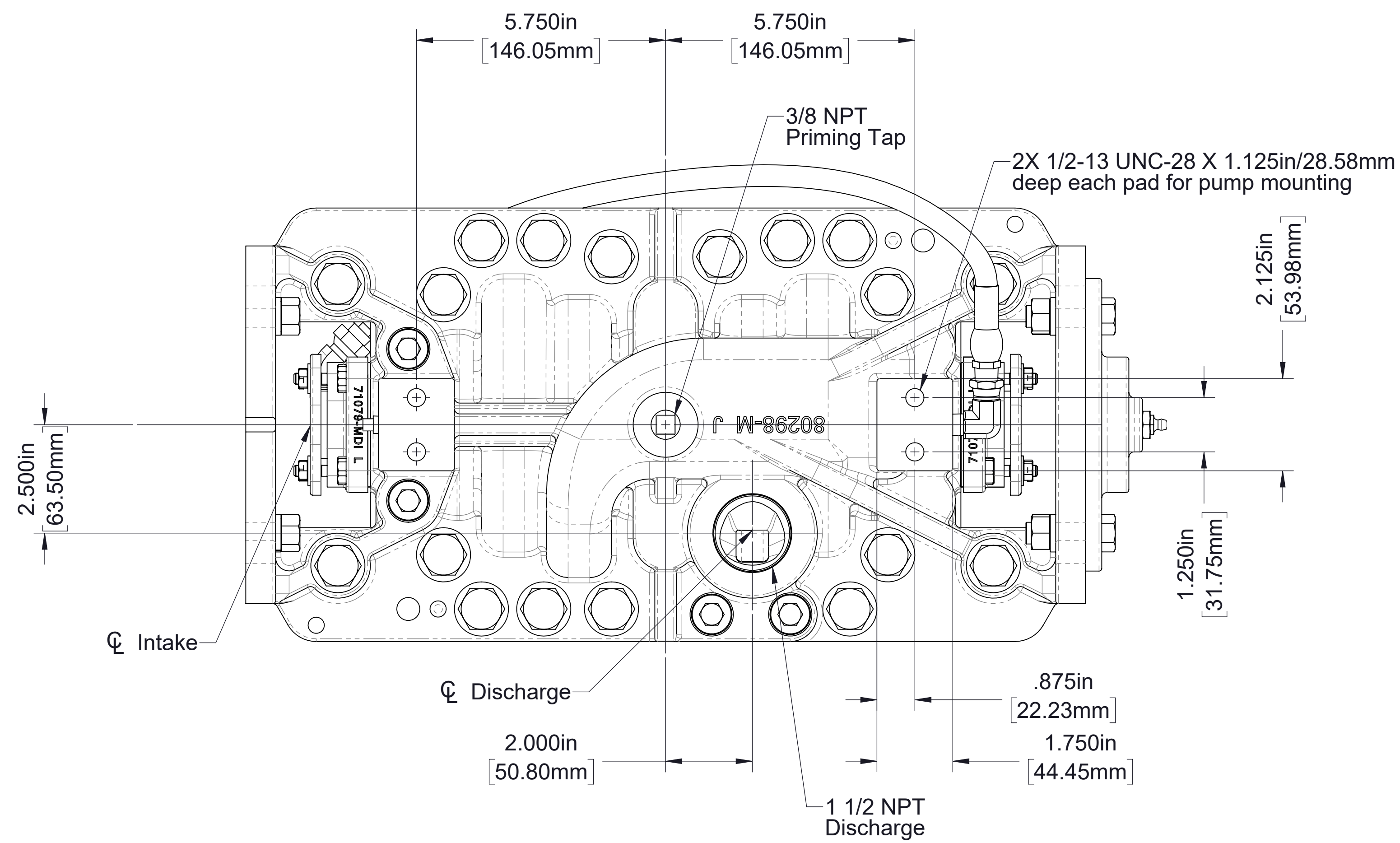

CP-4 Body Dimensions
See Page 5 For Available Intake and Discharge Positions

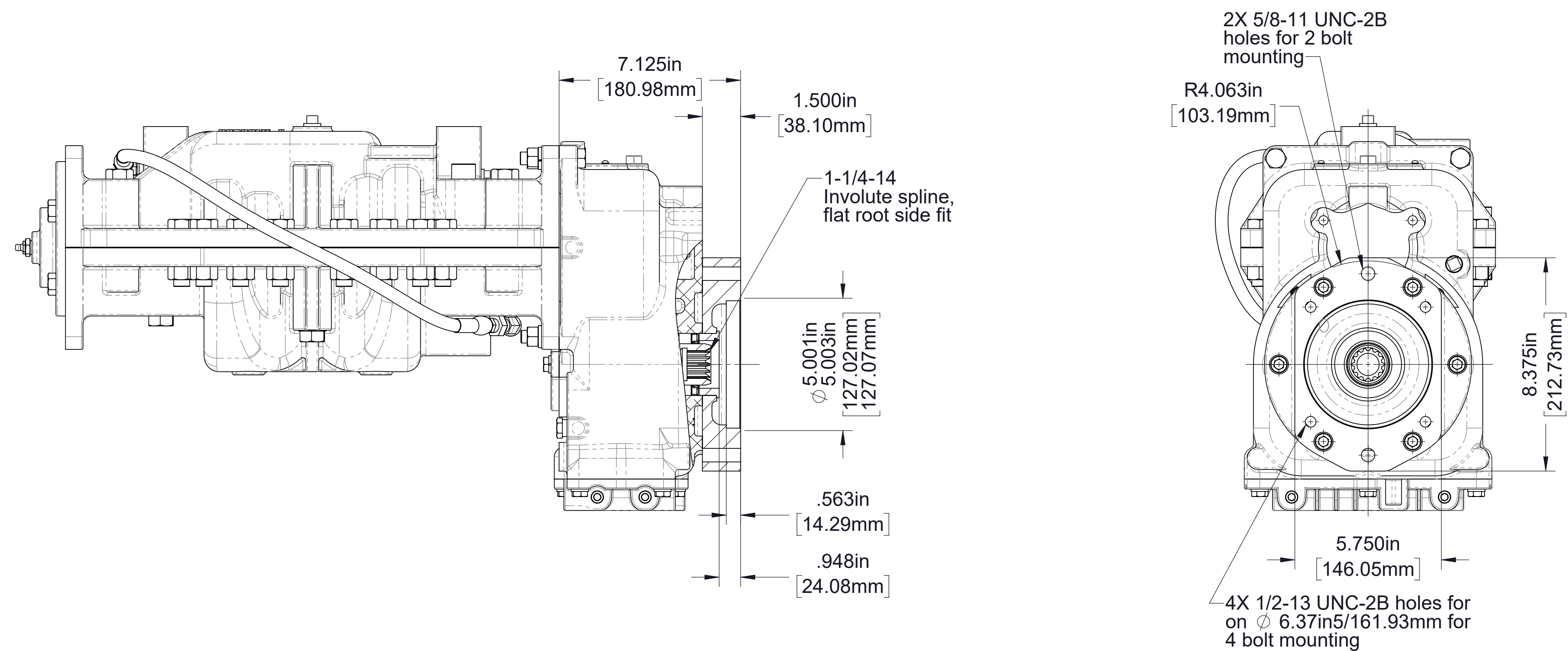

Optional SAE Class "C" 2 or 4 Bolt Hydraulic Pump
Flange Input For Medium Duty K Transmission

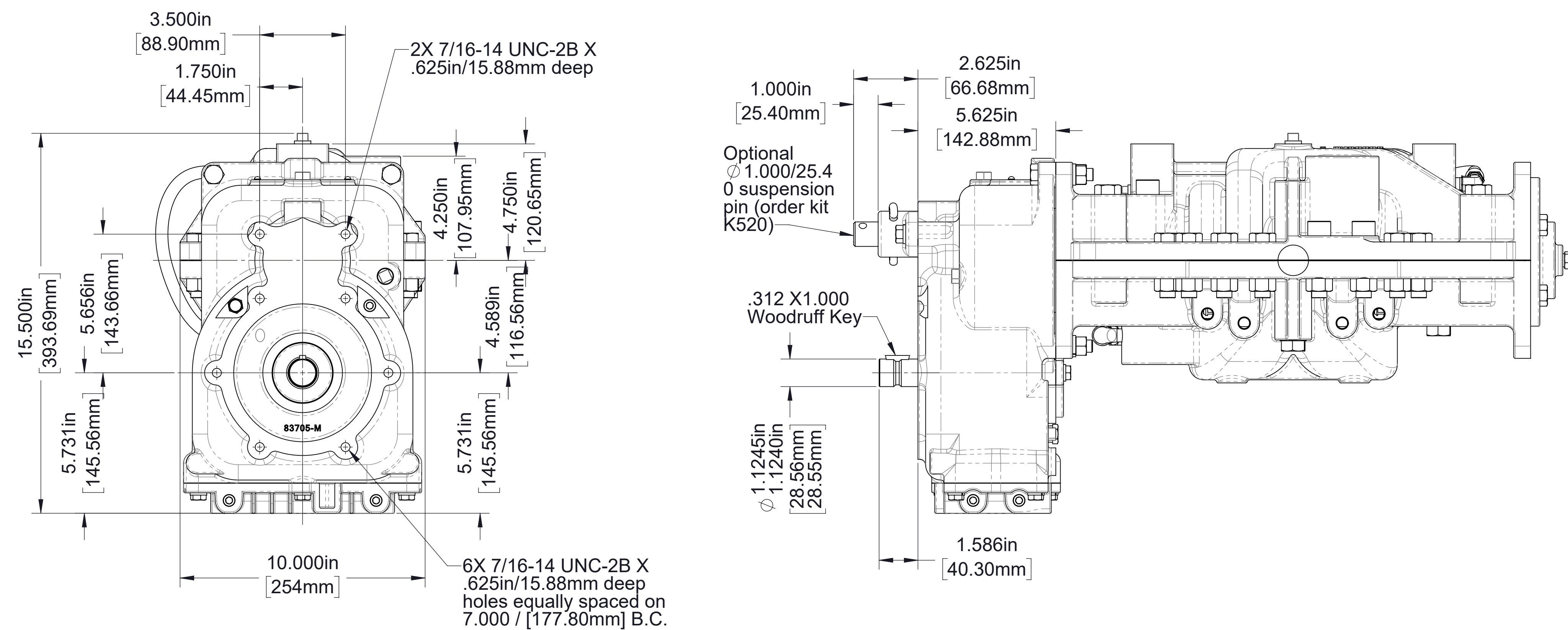

Model CPK-4
Medium Duty K Transmission
(Two gear without clutch)
(Vertical mounting shown)

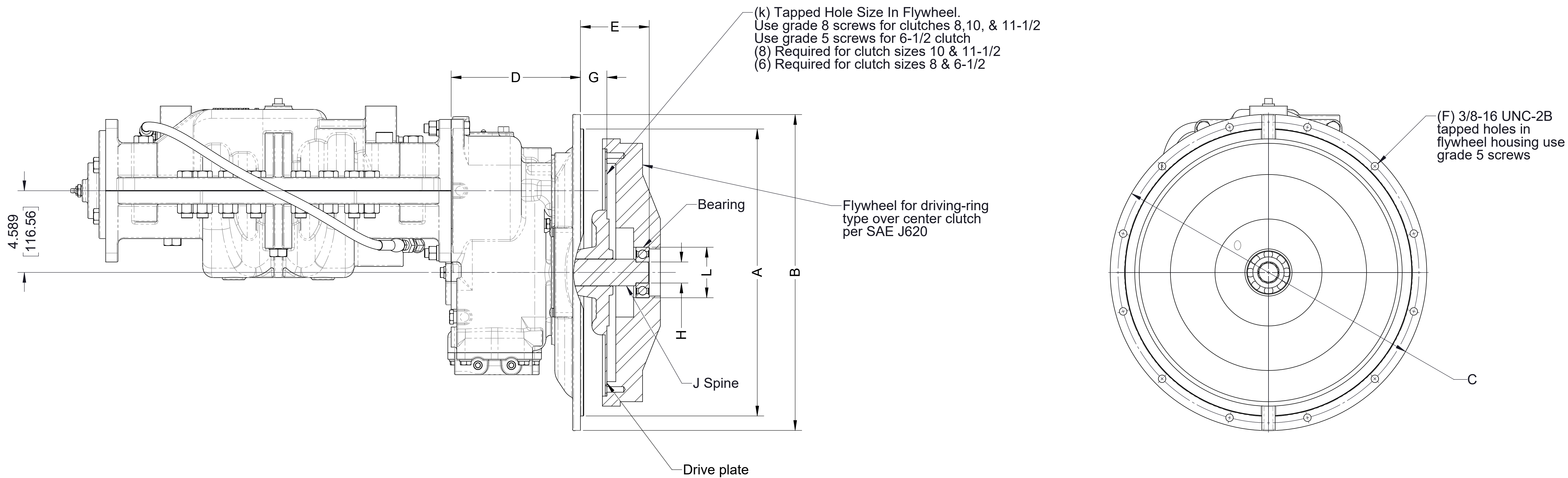

| SAE Bellhousing - J617 | | | | Bellhousing Adapter | | SAE Flywheel - J620 | | | | | Drive Plate | | Drive Shaft | |
|------------------------|----------------------|----------------------|----------------------|----------------------------|---------------------|---------------------|--------------------|-------------------------------|---------------------------|--------------------|-------------|-----------------------|-------------------------------|----------------|
| Size | (Ø) A | (Ø) B | (Ø) C | (Ø) F | D | Clutch Number | G | (Ø) L (Pilot Bearing O.D.) | K Fasteners Grade 8 | E | Part Number | Rating | (Ø) H (Pilot Bearing I.D.) | J |
| 3 | 16.125in 409.58mm | 17.750in 450.85mm | 16.875in 428.63mm | .424in 10.77mm (12X) | 7.250in 184.15mm | 10 | 2.120in 53.85mm | 2.8346in 72.00mm | 3/8-16 (8X) | 3.940in 100.1mm | V3807 | 120hp 90kW | 1.1803in 30.00mm | 1-1/2-10 SAE |
| 3 | 16.125in 409.58mm | 17.750in 450.85mm | 16.875in 428.63mm | .424in 10.77mm (12X) | 7.250in 184.15mm | 11-1/2 | 1.560in 39.62mm | 2.8346in 72.00mm | 3/8-16 (8X) | 3.940in 100.1mm | V2461 | 425 lb-ft 576 N·m | 1.1803in 30.00mm | 1-1/2-10 SAE |
| 4 | 14.250in 361.95mm | 15.875in 403.23mm | 15.000in 381.00mm | .424in 10.77mm (12X) | 7.250in 184.15mm | 8 | 2.440in 61.97mm | 2.4409in 62.00mm | 3/8-16 (6X) | 3.940in 100.1mm | V2852 | 965 lb-ft 1308 N·m | 1.1803in 30.00mm | 1-1/2-10 SAE |
| 4 | 14.250in 361.95mm | 15.875in 403.23mm | 15.000in 381.00mm | .424in 10.77mm (12X) | 7.250in 184.15mm | 10 | 2.120in 53.85mm | 2.8346in 72.00mm | 3/8-16 (8X) | 3.940in 100.1mm | V3807 | 120hp 90kW | 1.1803in 30.00mm | 1-1/2-10 SAE |
| 4 | 14.250in 361.95mm | 15.875in 403.23mm | 15.000in 381.00mm | .424in 10.77mm (12X) | 7.250in 184.15mm | 7-1/2 | 1.190in 30.23mm | 2.0472in 52.00mm | 5/16-18 (8X) | 2.810in 71.4mm | V4128 | 50hp 37kW | 0.7863in 20.00mm | 1-15T Involute |
| 5 | 12.375in 314.32mm | 14.000in 355.60mm | 15.000in 381.00mm | .408in 10.36 mm (8X) | 6.250in 158.75mm | 6-1/2 | 1.190in 30.23mm | 2.0472in 52.00mm | 5/16-18 (6X) | 2.810in 71.4mm | V2865 | 50hp 37kW | 0.7863in 20.00mm | 1-15T Involute |

Model CPT-4
Medium Duty T Transmission
 (Two gear without clutch)
 (Vertical mounting shown)

Available Intake And Discharge Positions

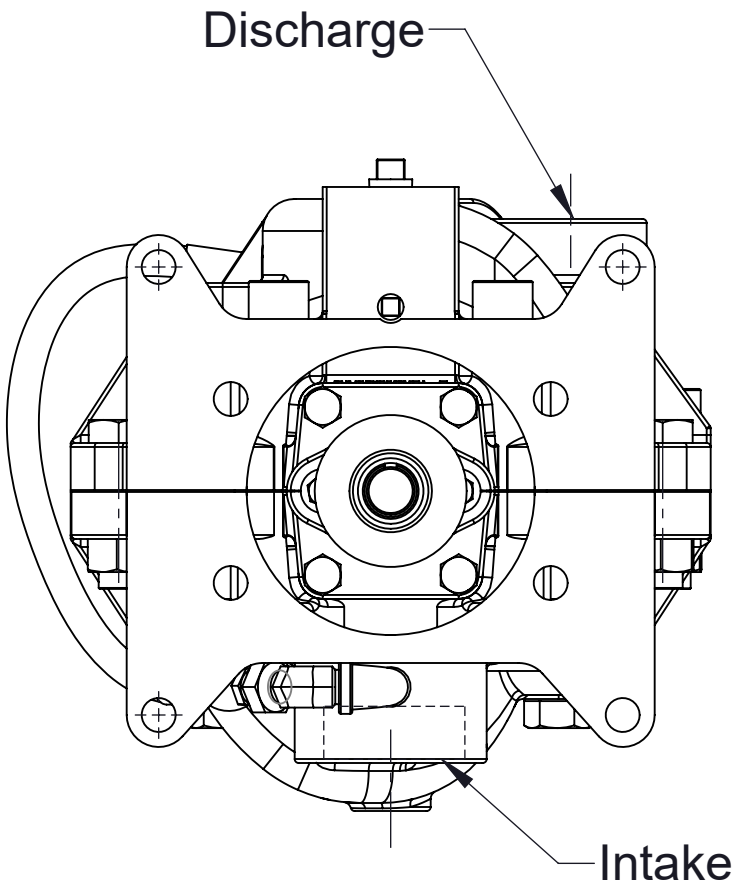
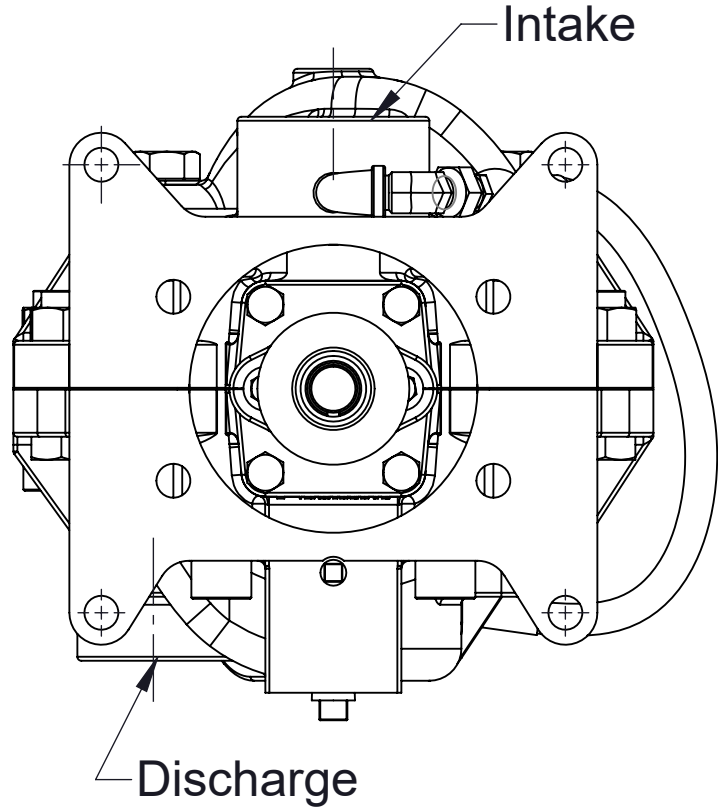
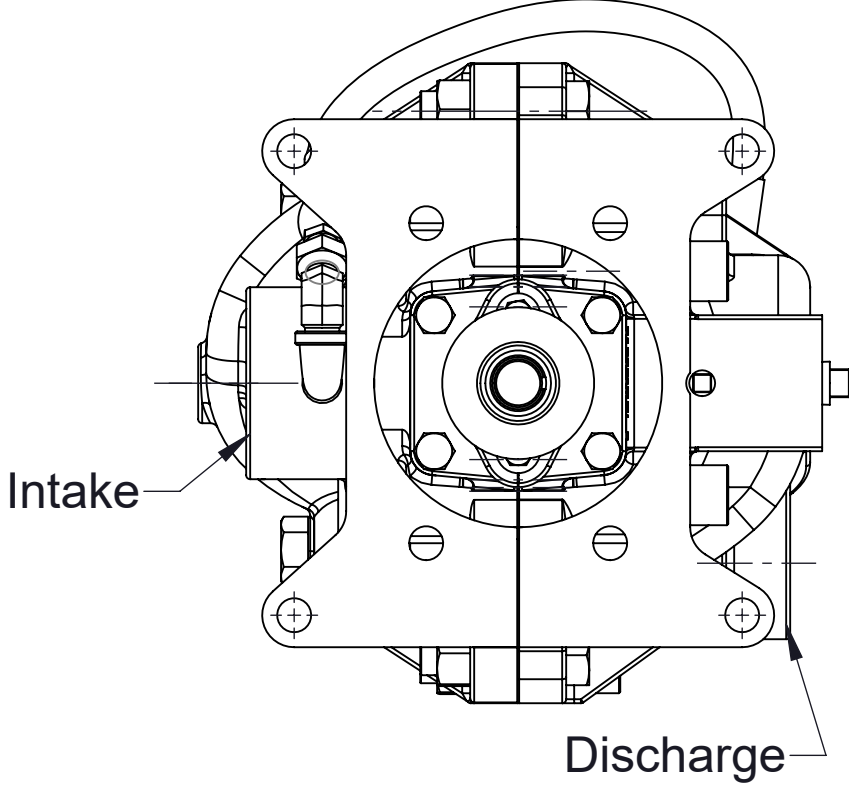
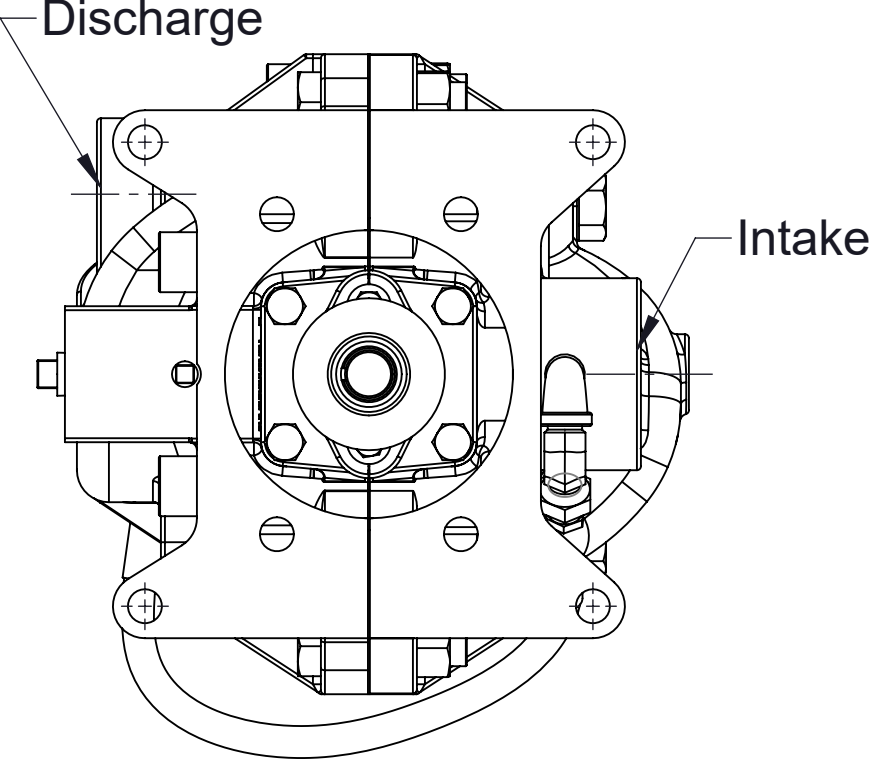
| | Discharge Position | | | |
|--|---|--|--|--|
| | Up | Down | Right | Left |
| | Available with vertical or inverted transmission mounting positions only | Available with vertical or inverted transmission mounting only | Available with left or right transmission mounting only | Available with left or right transmission mounting only |
| | Allows for full pump draining | Only available if pump does not require draining | | |
| Clockwise drive shaft rotation (Input) (Viewed looking at transmission input shaft) |  |  |  |  |

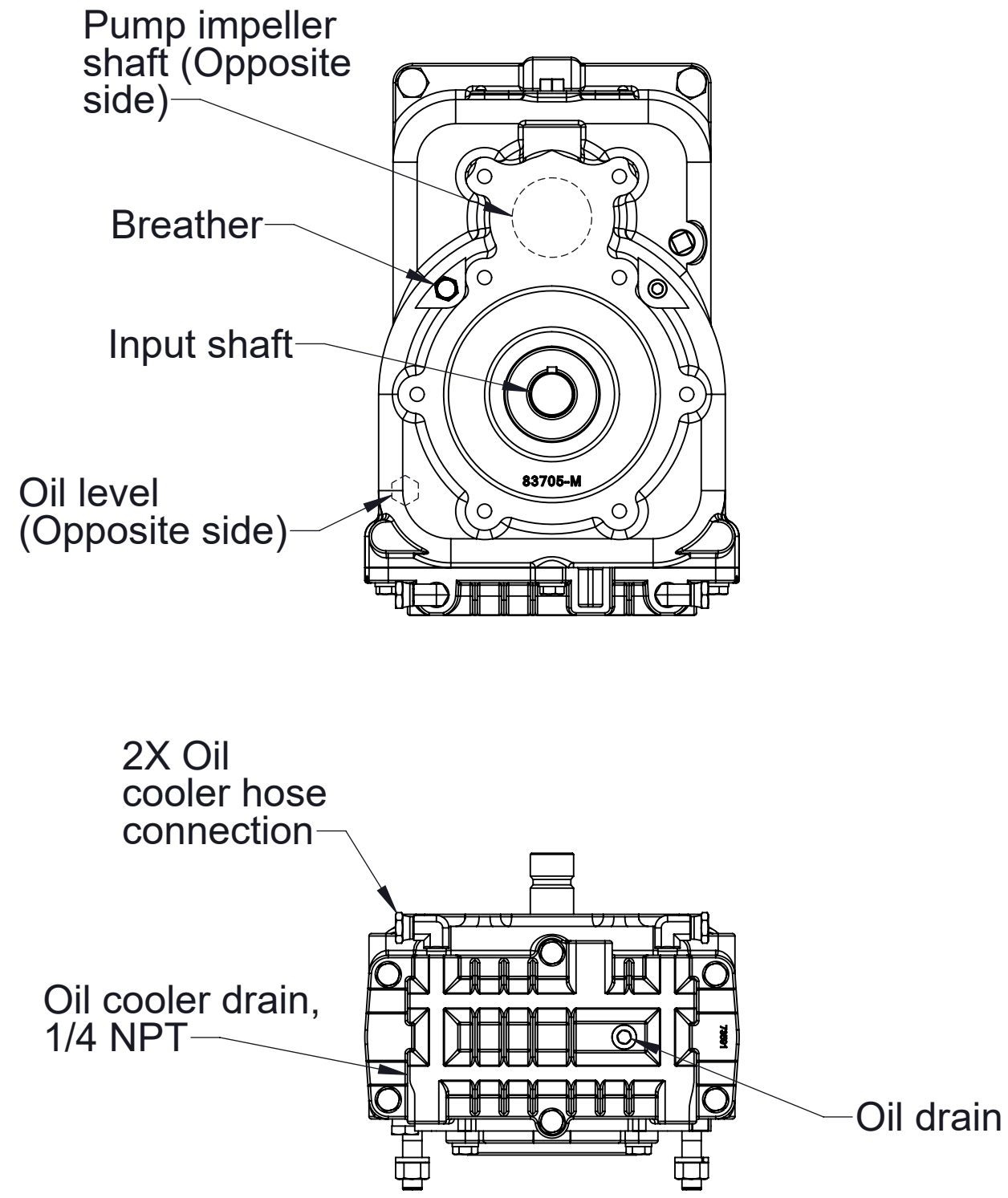
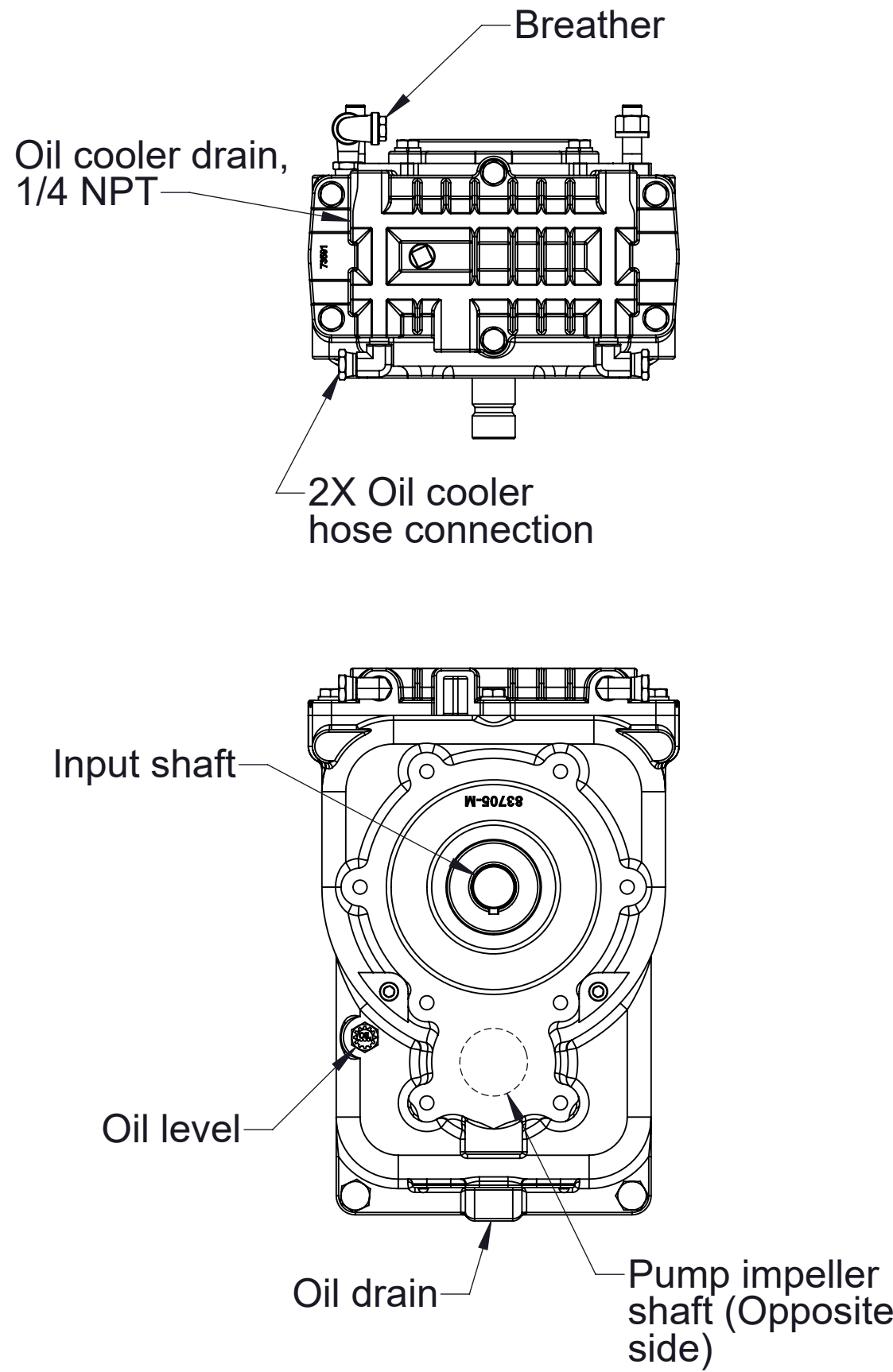
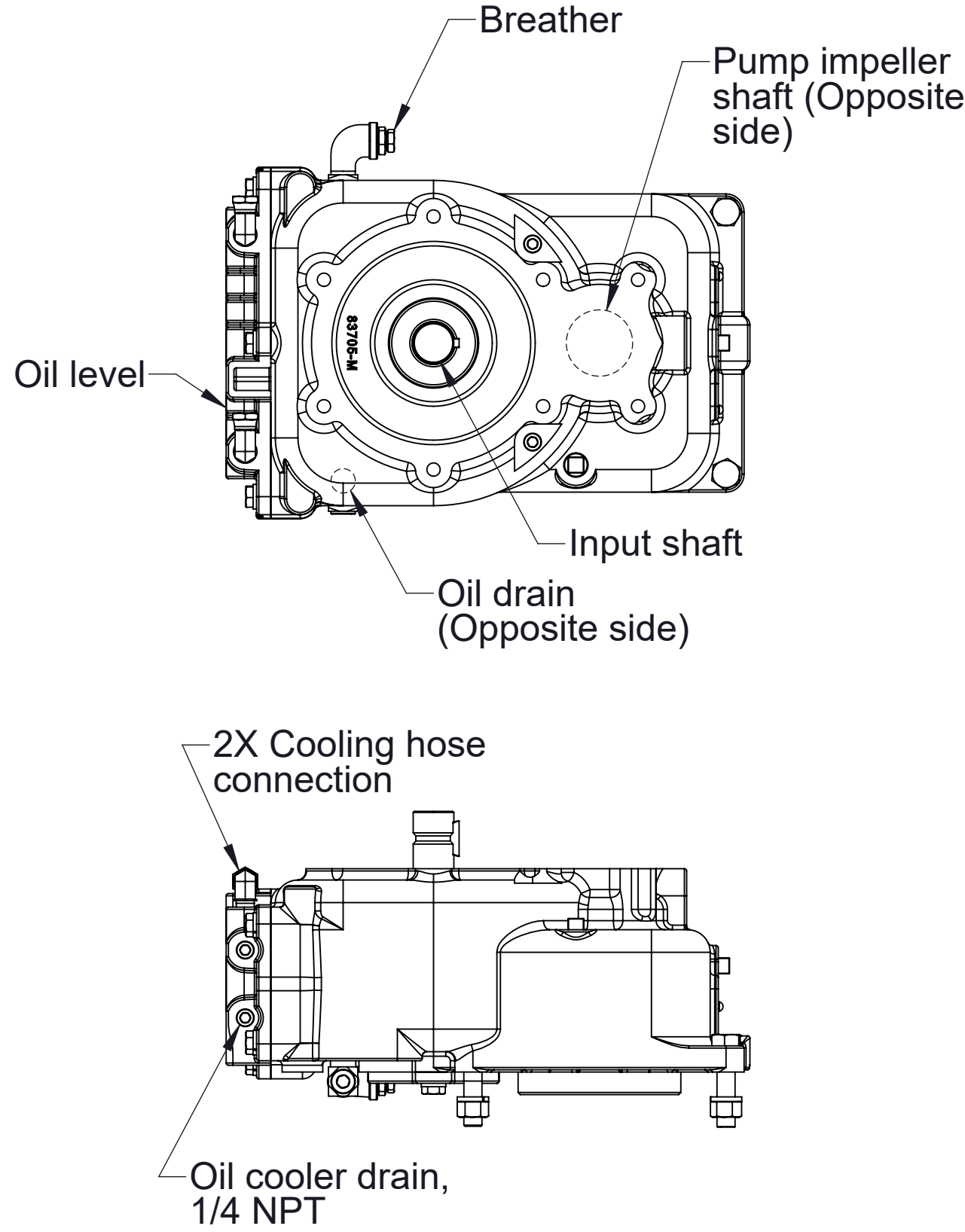
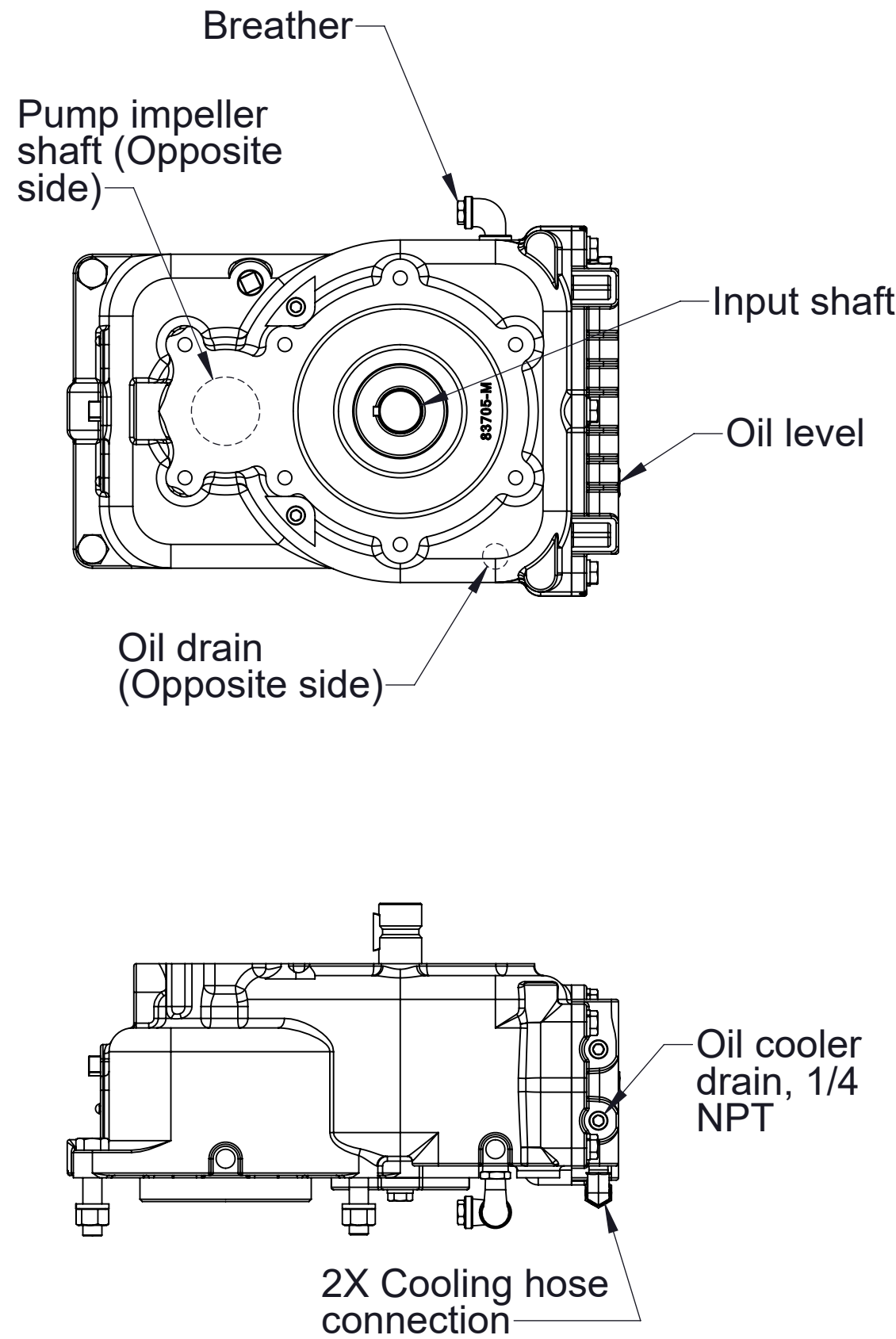
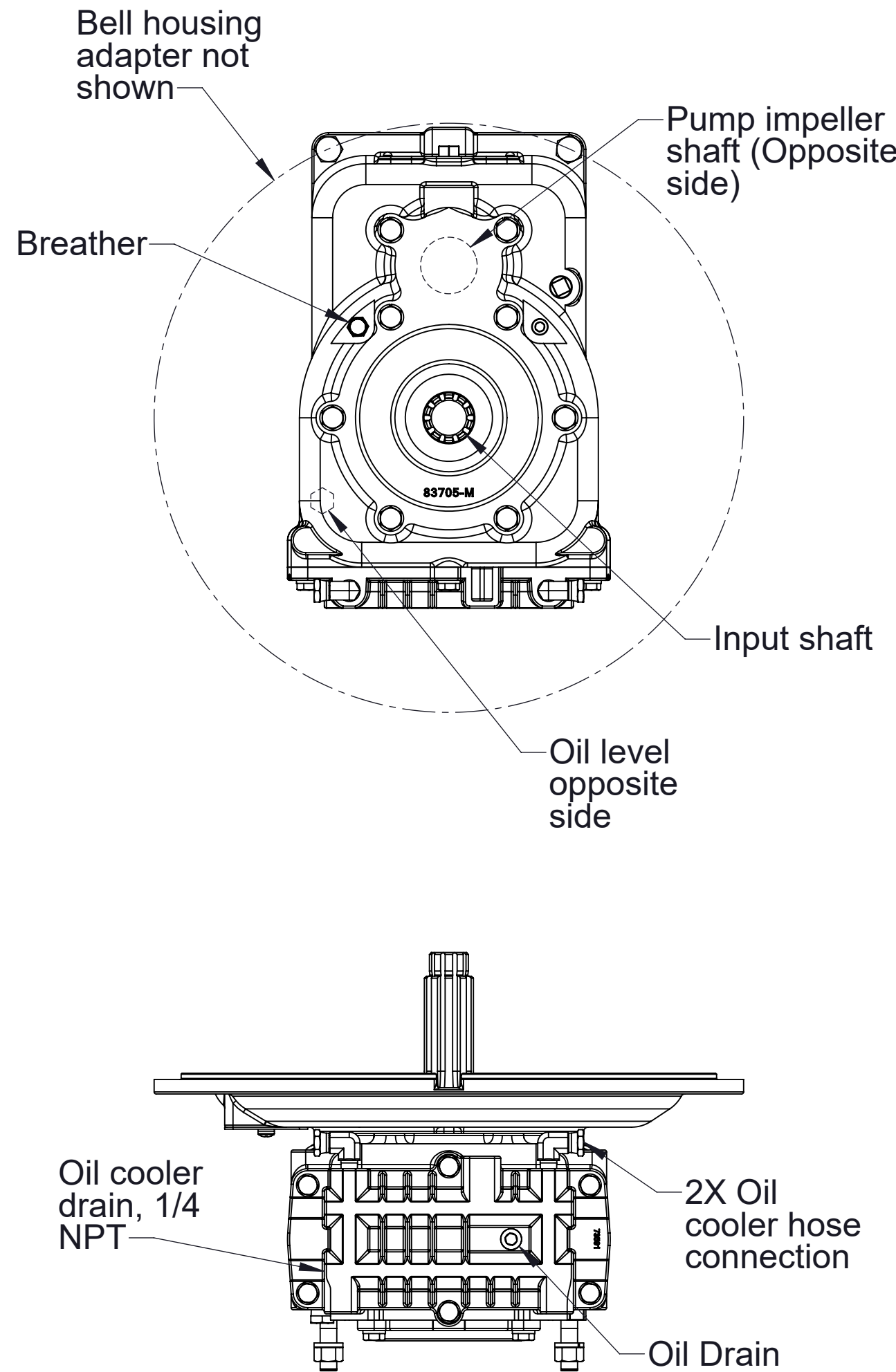
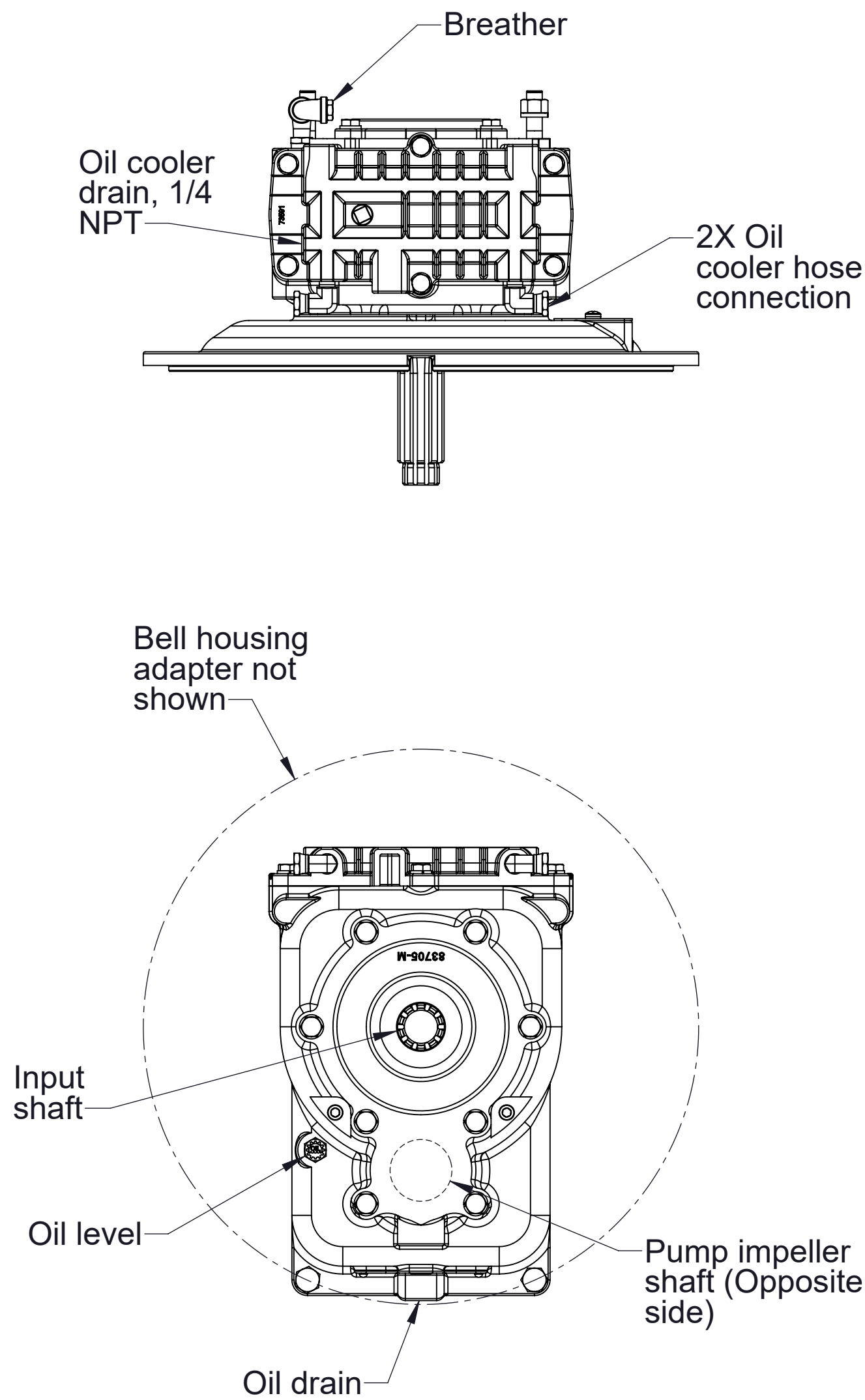
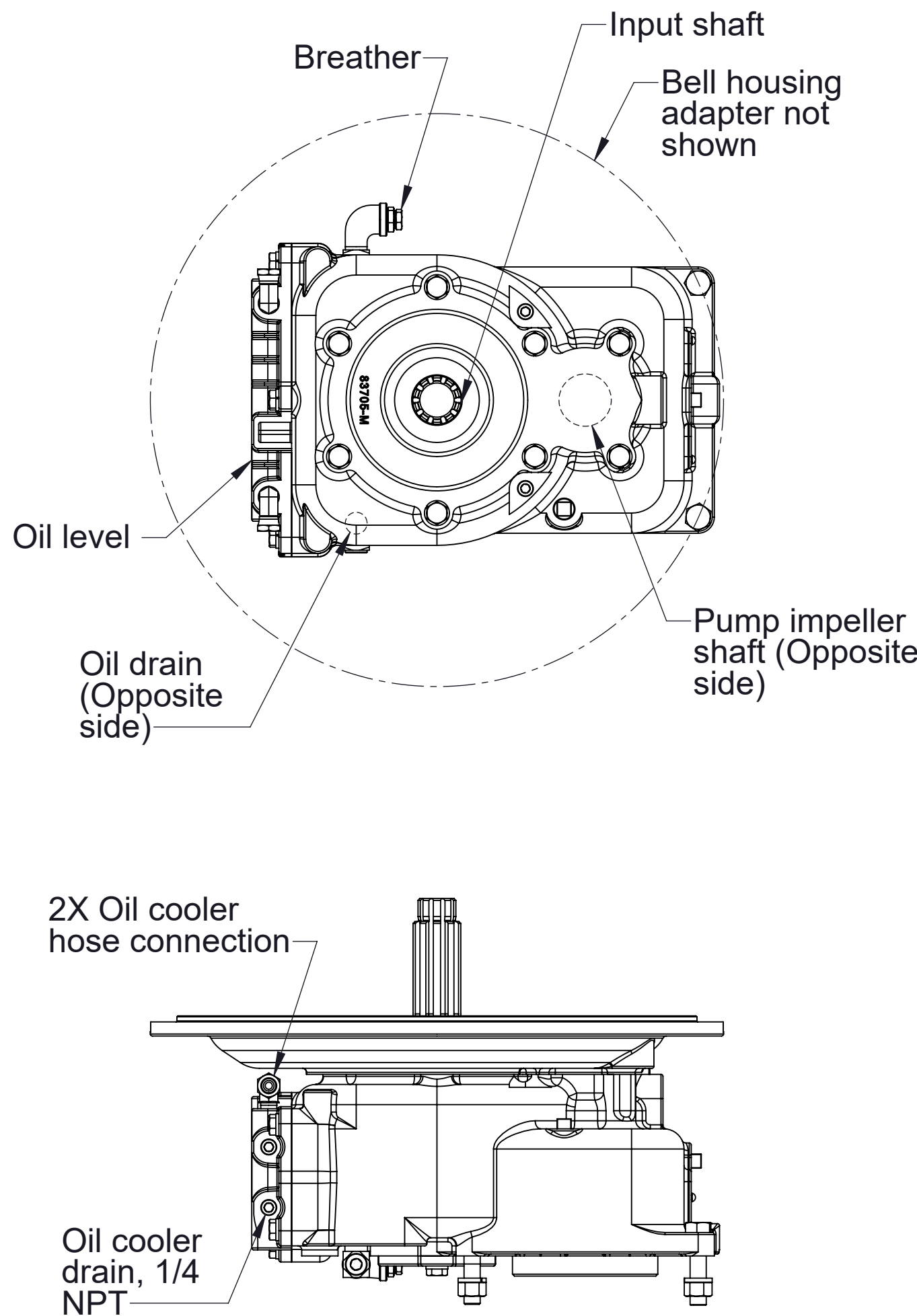
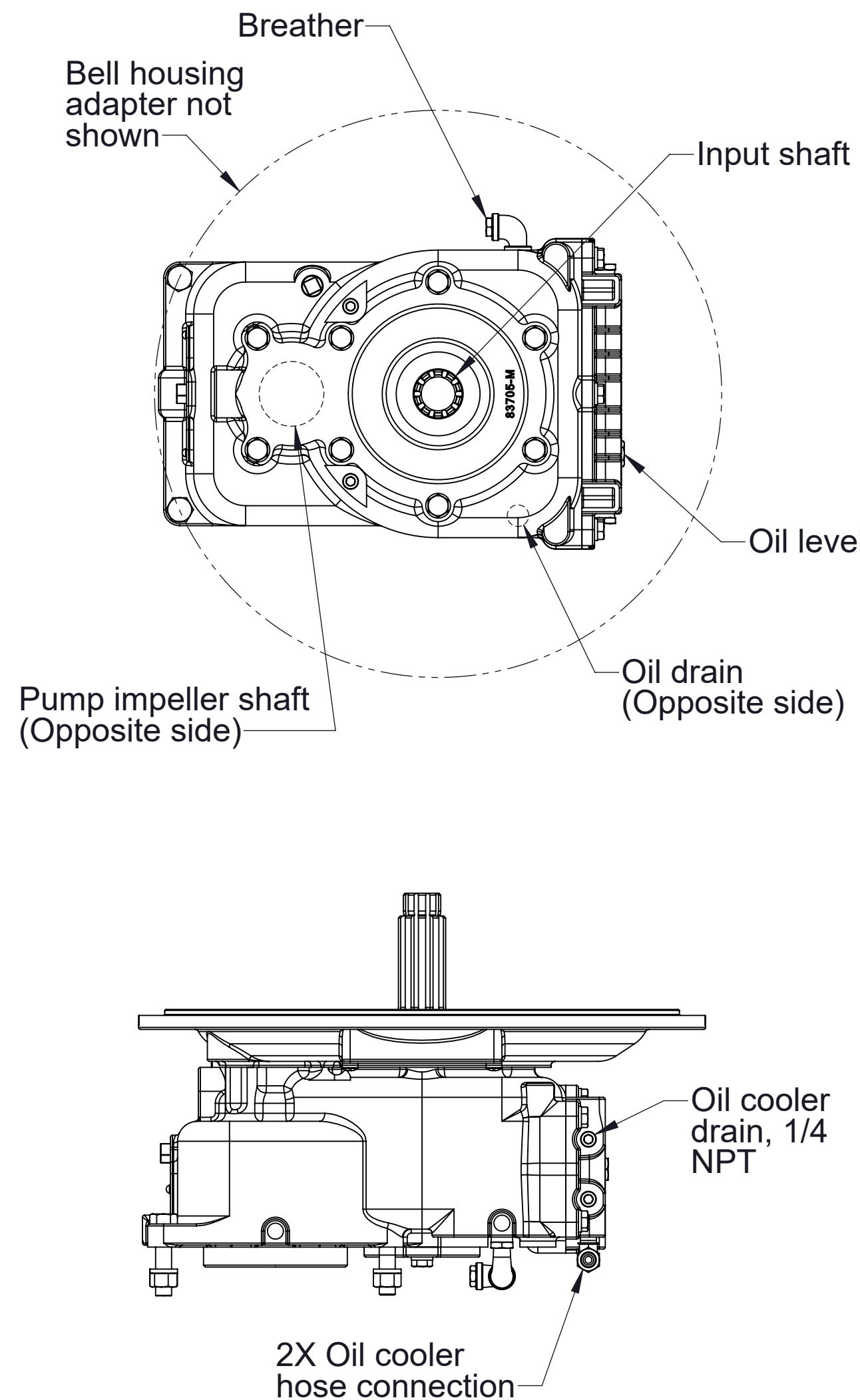
| | Vertical | Inverted | Left | Right |
|---|---|--|---|---|
| K |  <p>Pump impeller shaft (Opposite side)</p> <p>Breather</p> <p>Input shaft</p> <p>Oil level (Opposite side)</p> <p>2X Oil cooler hose connection</p> <p>Oil cooler drain, 1/4 NPT</p> <p>Oil drain</p> |  <p>Breather</p> <p>Oil cooler drain, 1/4 NPT</p> <p>2X Oil cooler hose connection</p> <p>Input shaft</p> <p>Oil level</p> <p>Oil drain</p> <p>Pump impeller shaft (Opposite side)</p> |  <p>Breather</p> <p>Pump impeller shaft (Opposite side)</p> <p>Oil level</p> <p>Input shaft</p> <p>Oil drain (Opposite side)</p> <p>2X Cooling hose connection</p> <p>Oil cooler drain, 1/4 NPT</p> |  <p>Breather</p> <p>Pump impeller shaft (Opposite side)</p> <p>Input shaft</p> <p>Oil level</p> <p>Oil drain (Opposite side)</p> <p>Oil cooler drain, 1/4 NPT</p> <p>2X Cooling hose connection</p> |
| T |  <p>Bell housing adapter not shown</p> <p>Breather</p> <p>Pump impeller shaft (Opposite side)</p> <p>Input shaft</p> <p>Oil level opposite side</p> <p>Oil cooler drain, 1/4 NPT</p> <p>2X Oil cooler hose connection</p> <p>Oil Drain</p> |  <p>Breather</p> <p>Oil cooler drain, 1/4 NPT</p> <p>2X Oil cooler hose connection</p> <p>Bell housing adapter not shown</p> <p>Input shaft</p> <p>Oil level</p> <p>Oil drain</p> <p>Pump impeller shaft (Opposite side)</p> |  <p>Breather</p> <p>Input shaft</p> <p>Bell housing adapter not shown</p> <p>Oil level</p> <p>Pump impeller shaft (Opposite side)</p> <p>Oil drain (Opposite side)</p> <p>2X Oil cooler hose connection</p> <p>Oil cooler drain, 1/4 NPT</p> |  <p>Breather</p> <p>Bell housing adapter not shown</p> <p>Input shaft</p> <p>Oil level</p> <p>Pump impeller shaft (Opposite side)</p> <p>Oil drain (Opposite side)</p> <p>Oil cooler drain, 1/4 NPT</p> <p>2X Oil cooler hose connection</p> |