

ICS (Intelligent CAFS Selector) Valves Dimensional Drawings

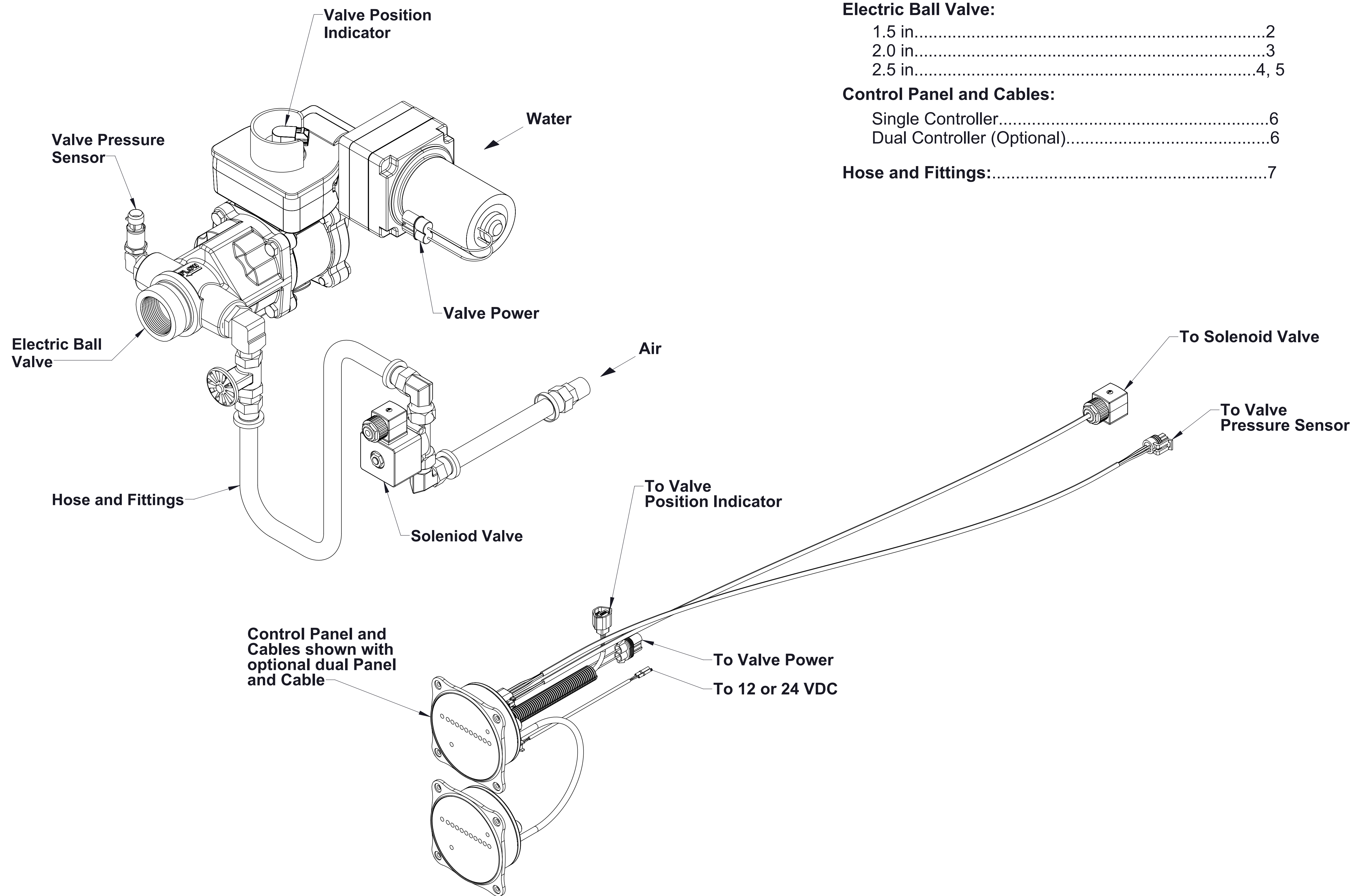

Components:	Page
Electric Ball Valve:	
1.5 in.....	2
2.0 in.....	3
2.5 in.....	4, 5
Control Panel and Cables:	
Single Controller.....	6
Dual Controller (Optional).....	6
Hose and Fittings:	7

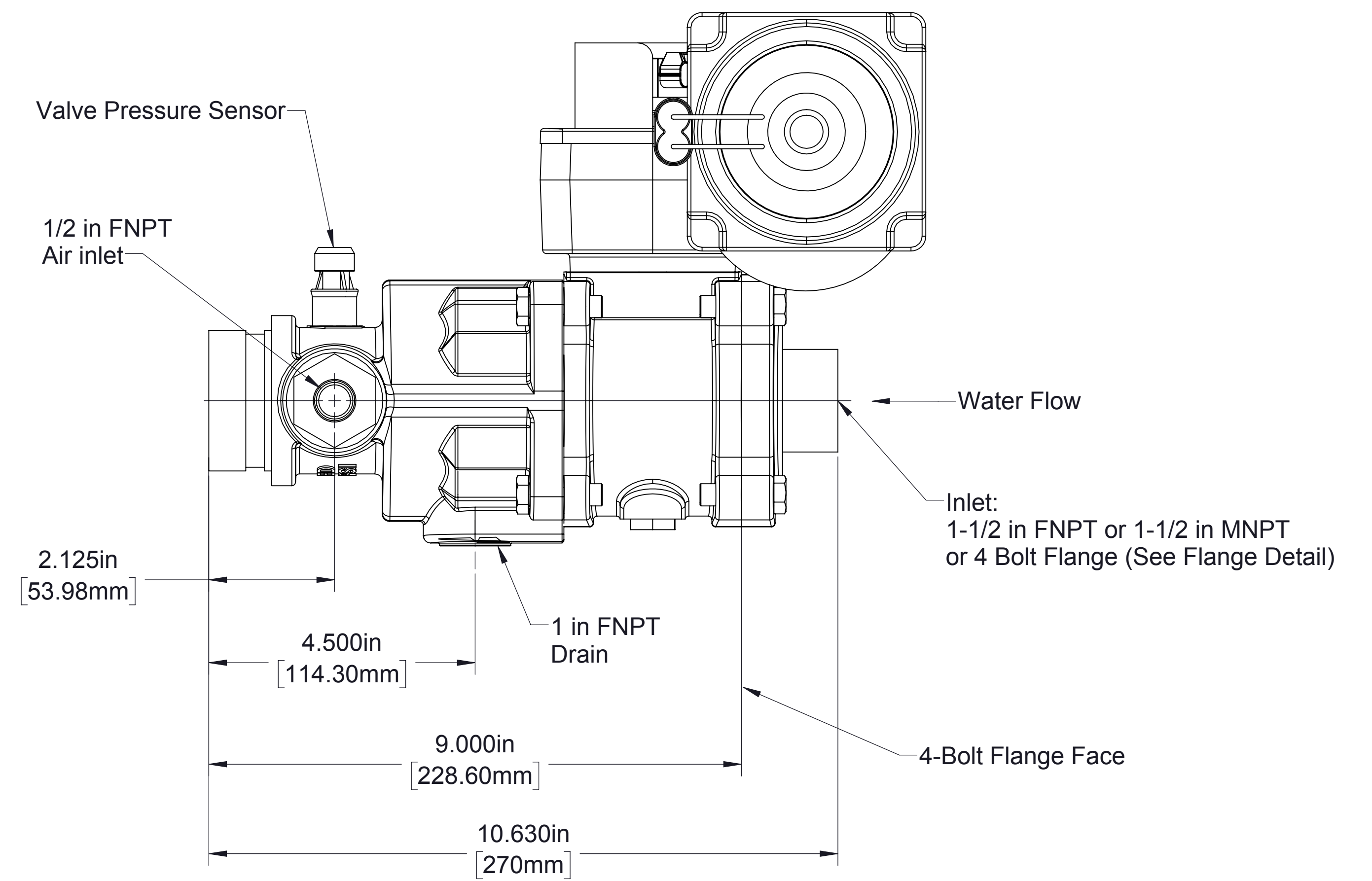
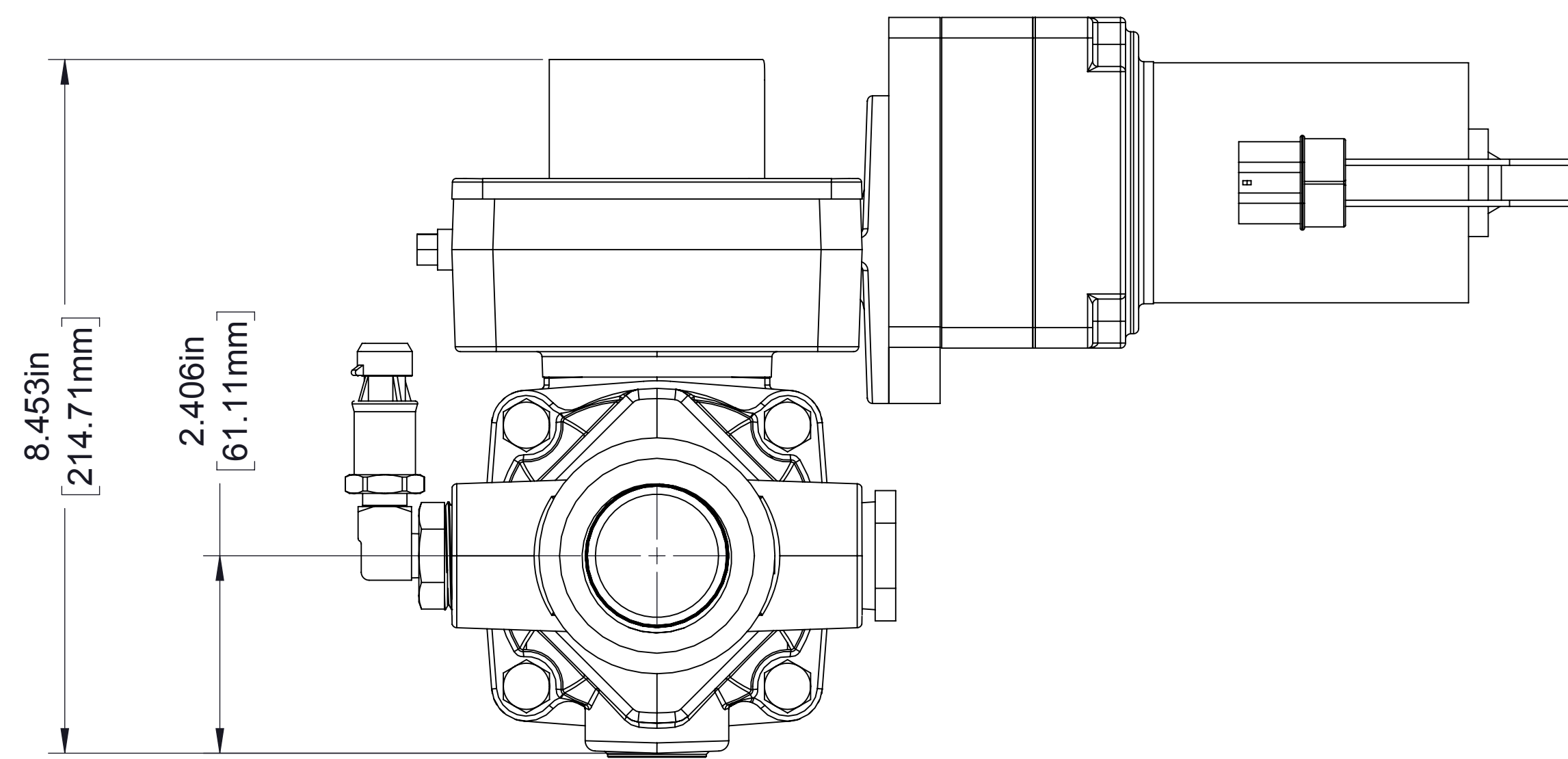
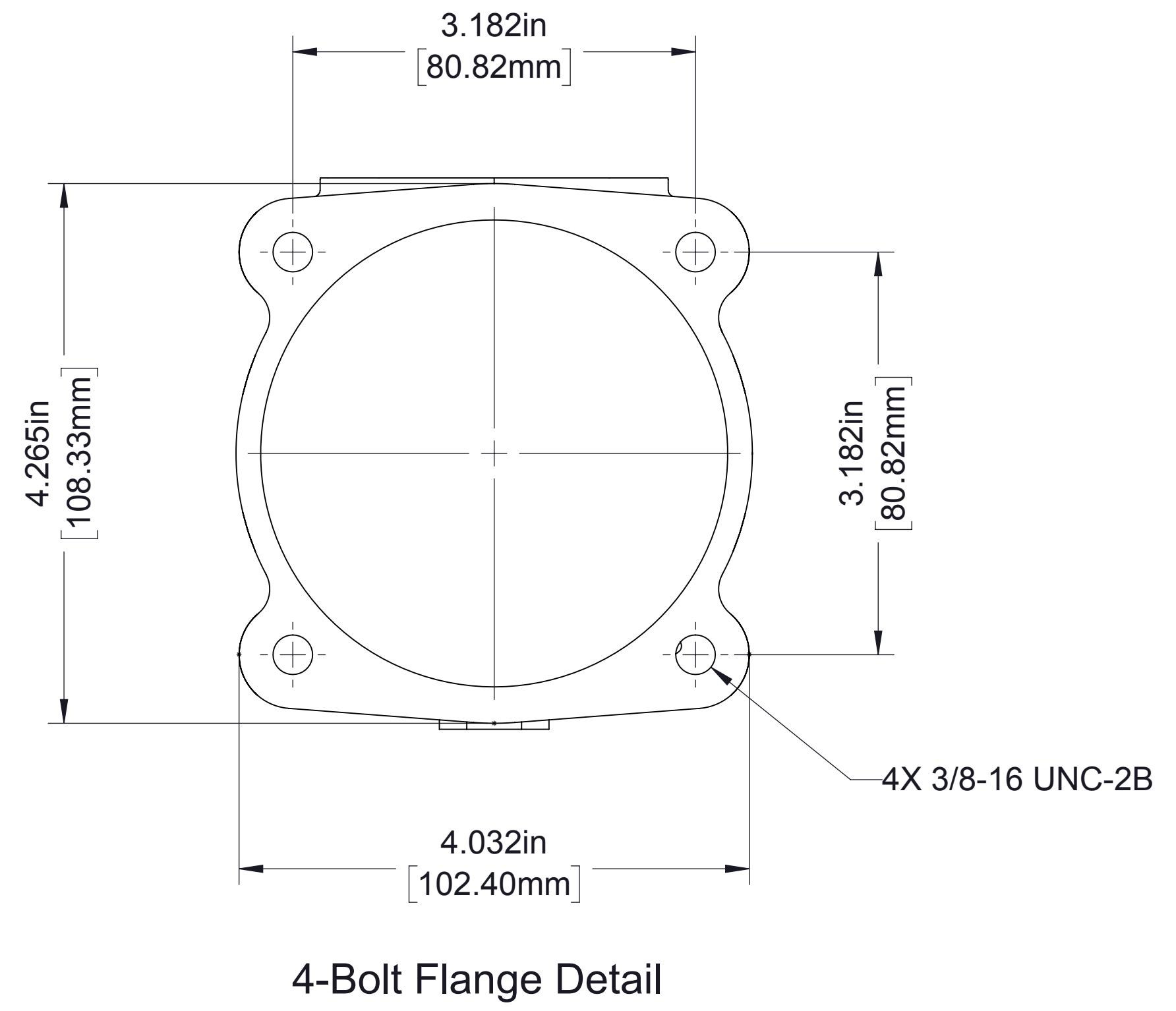
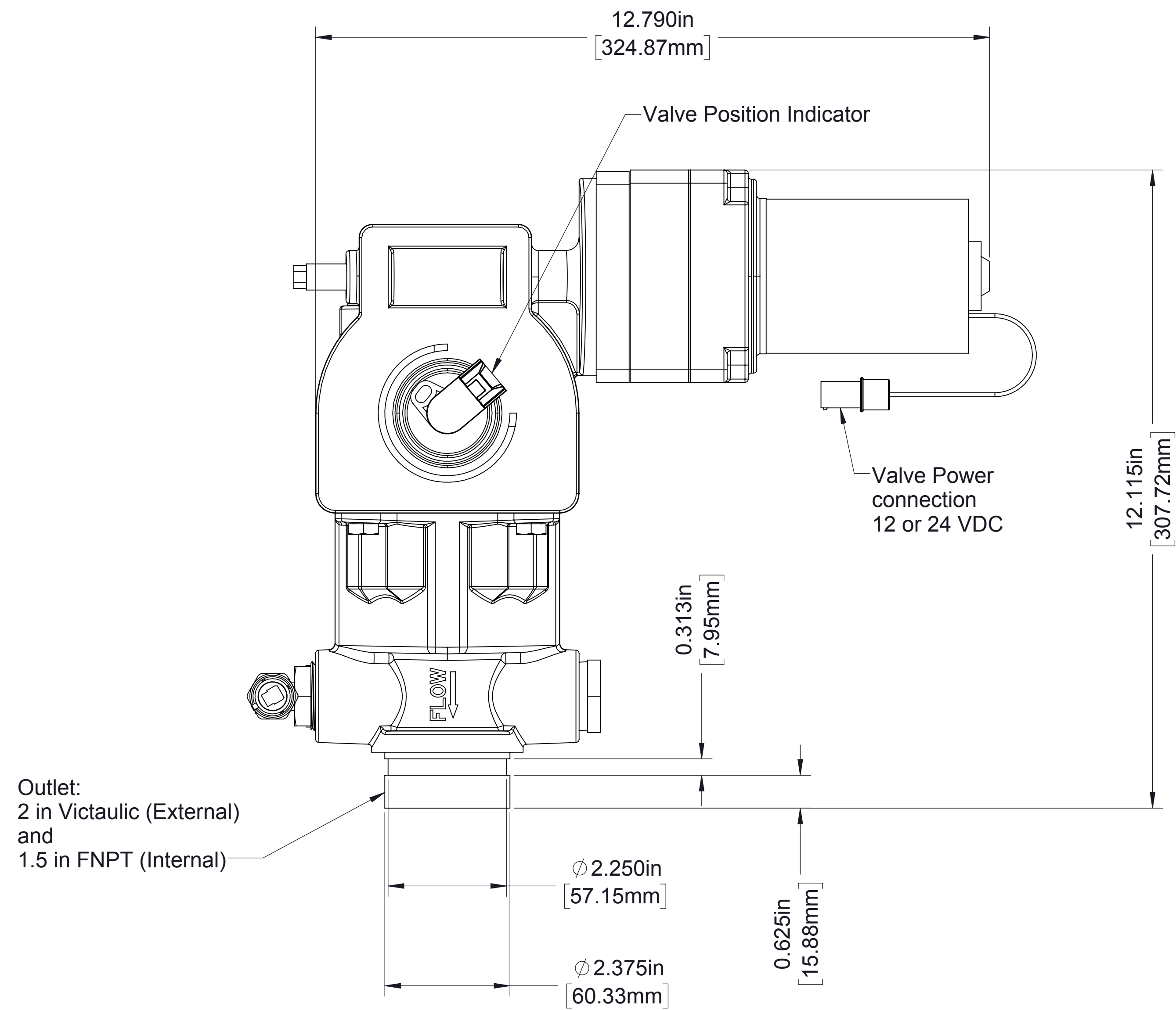

Note:
1.5 in Valve has both 2 in victaulic and 1.5 in FNPT on outlet.

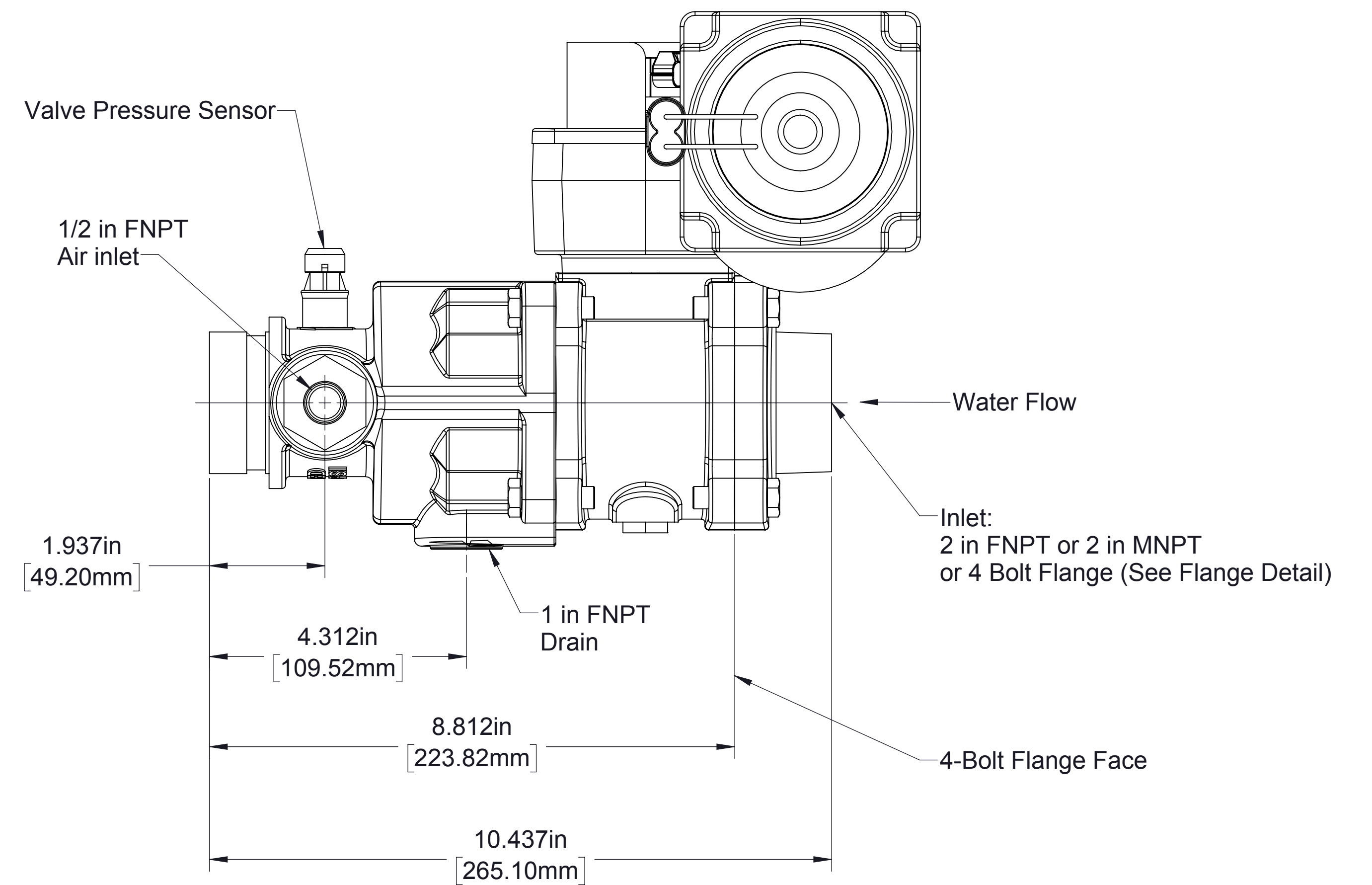
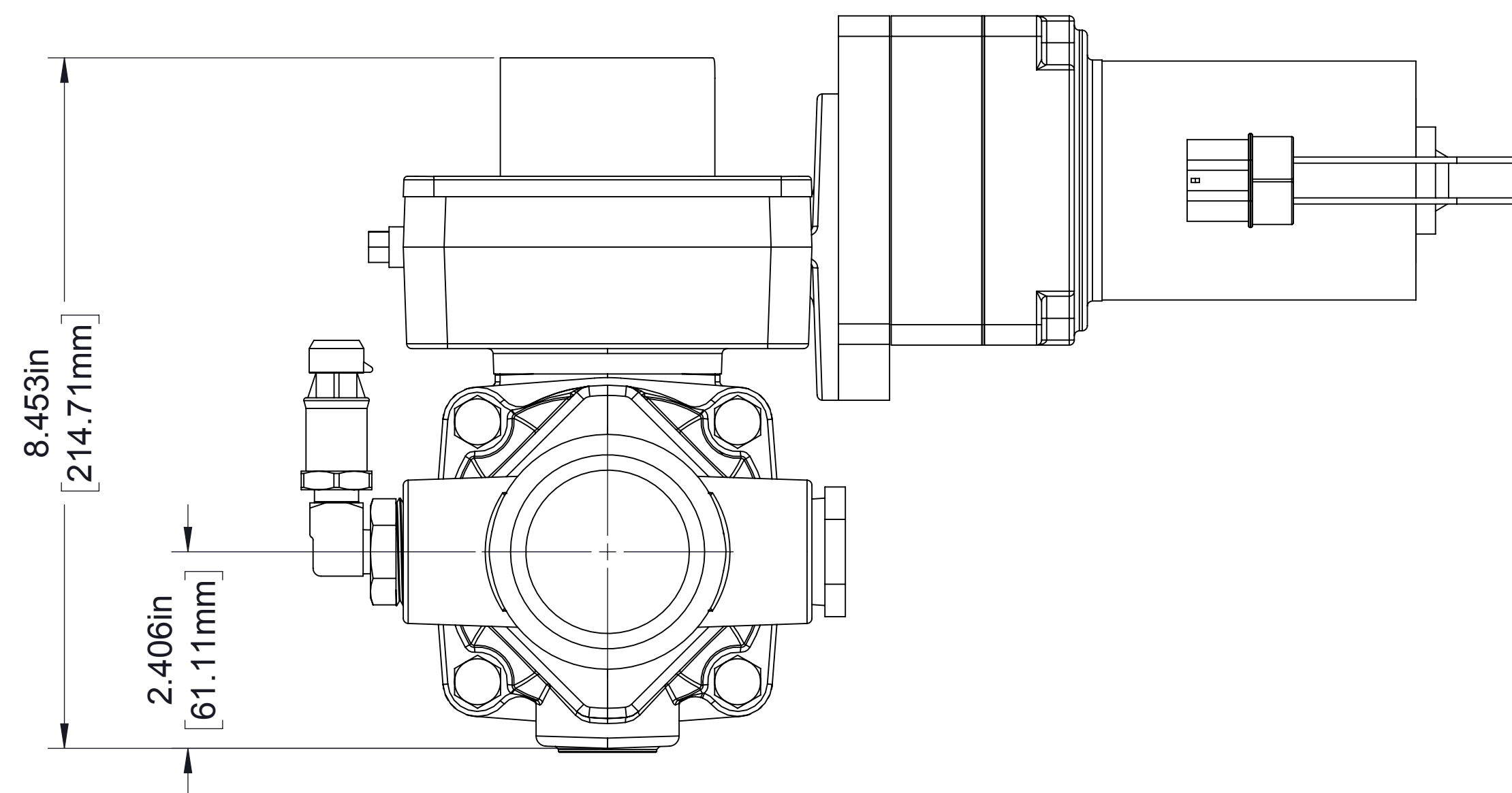
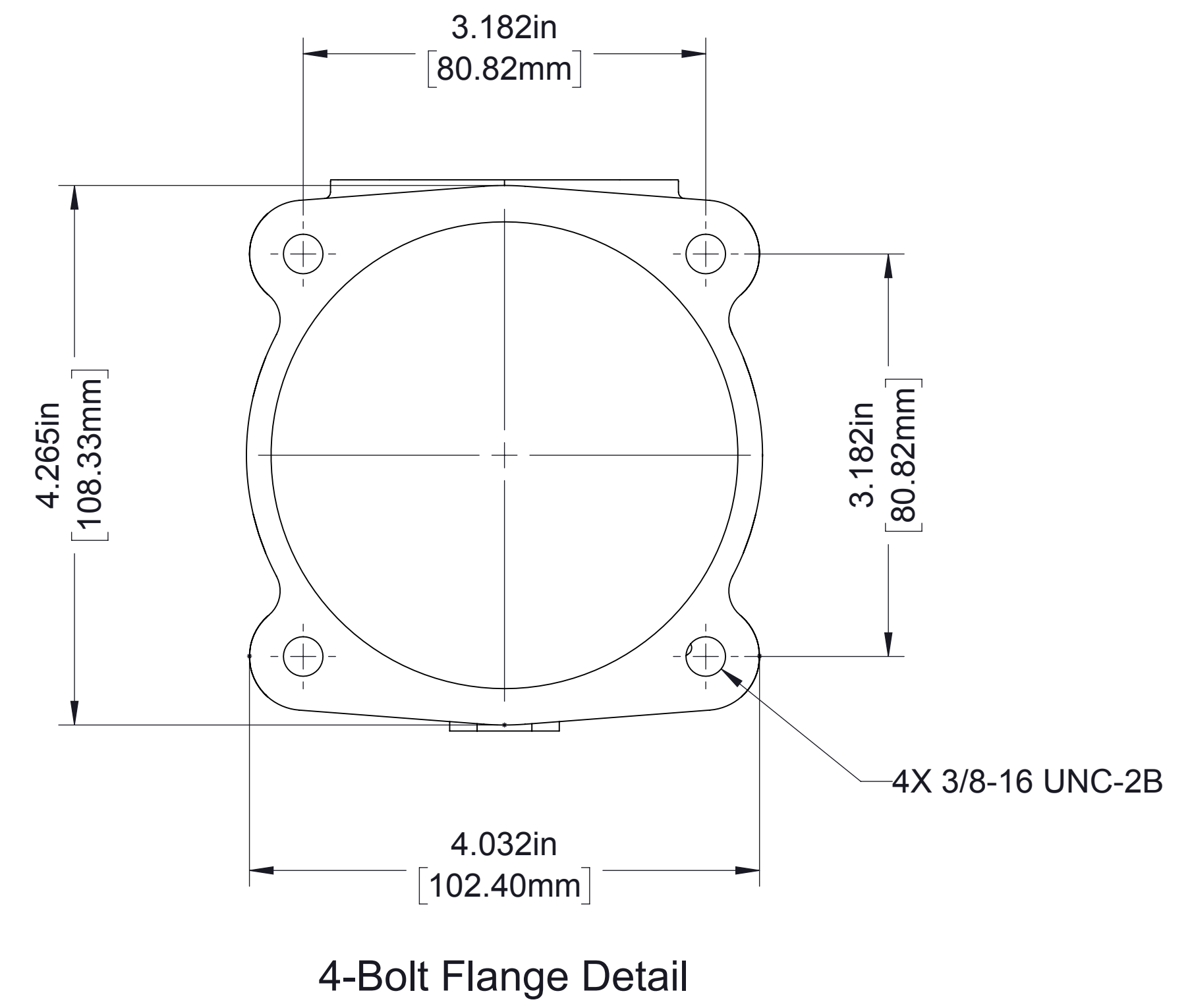
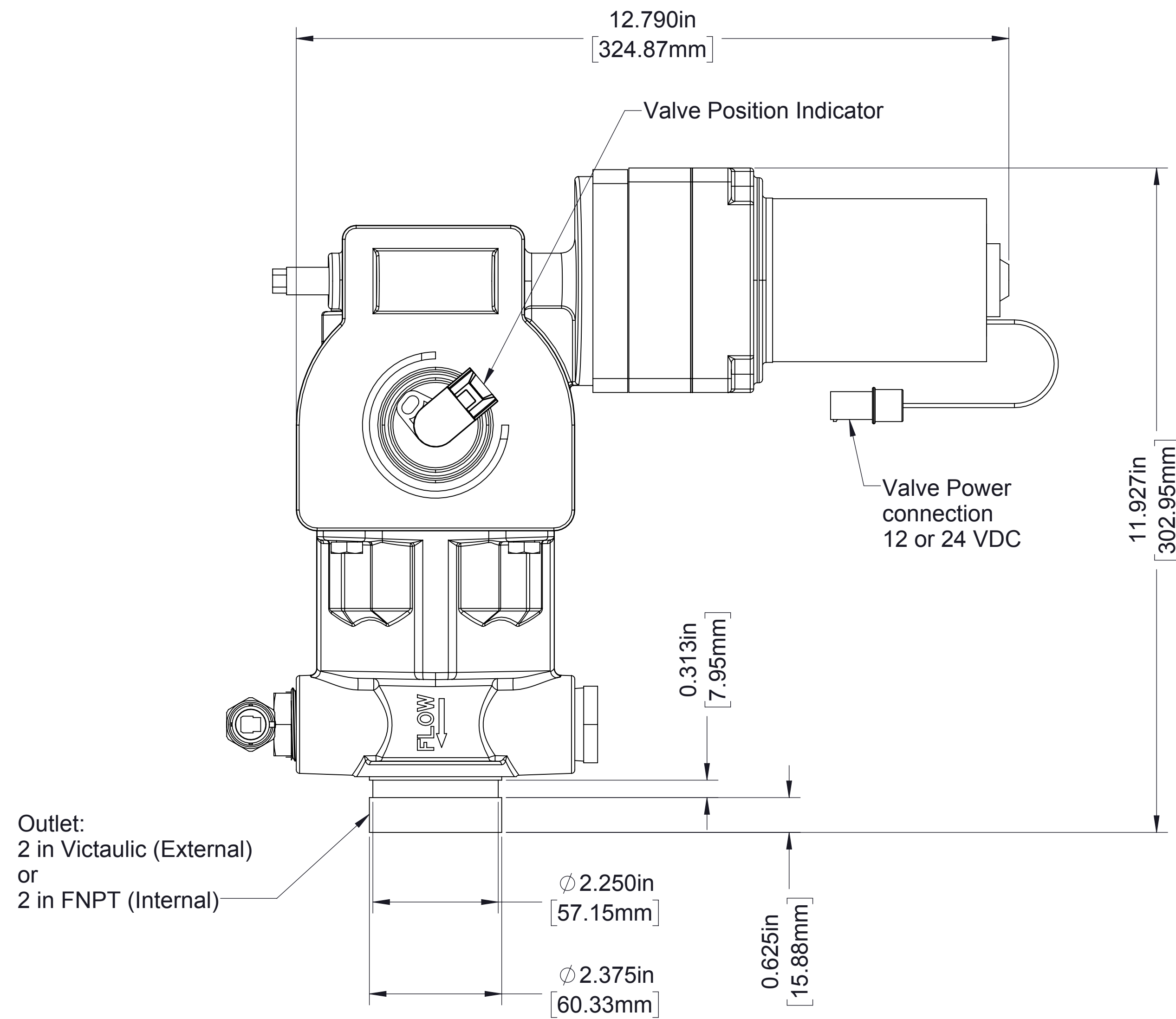

Note:
2.0 in Valve has either victaulic or FNPT on outlet.

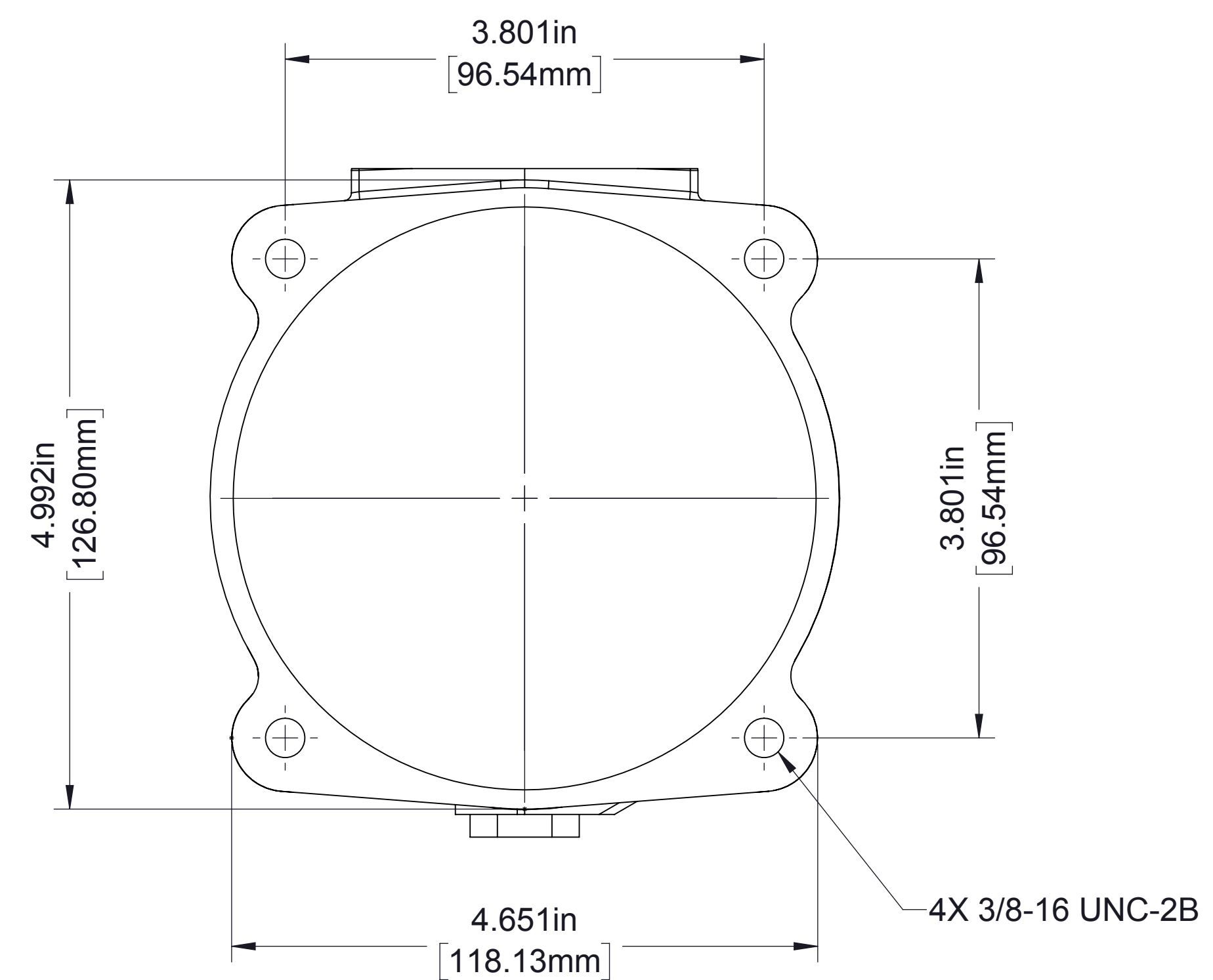
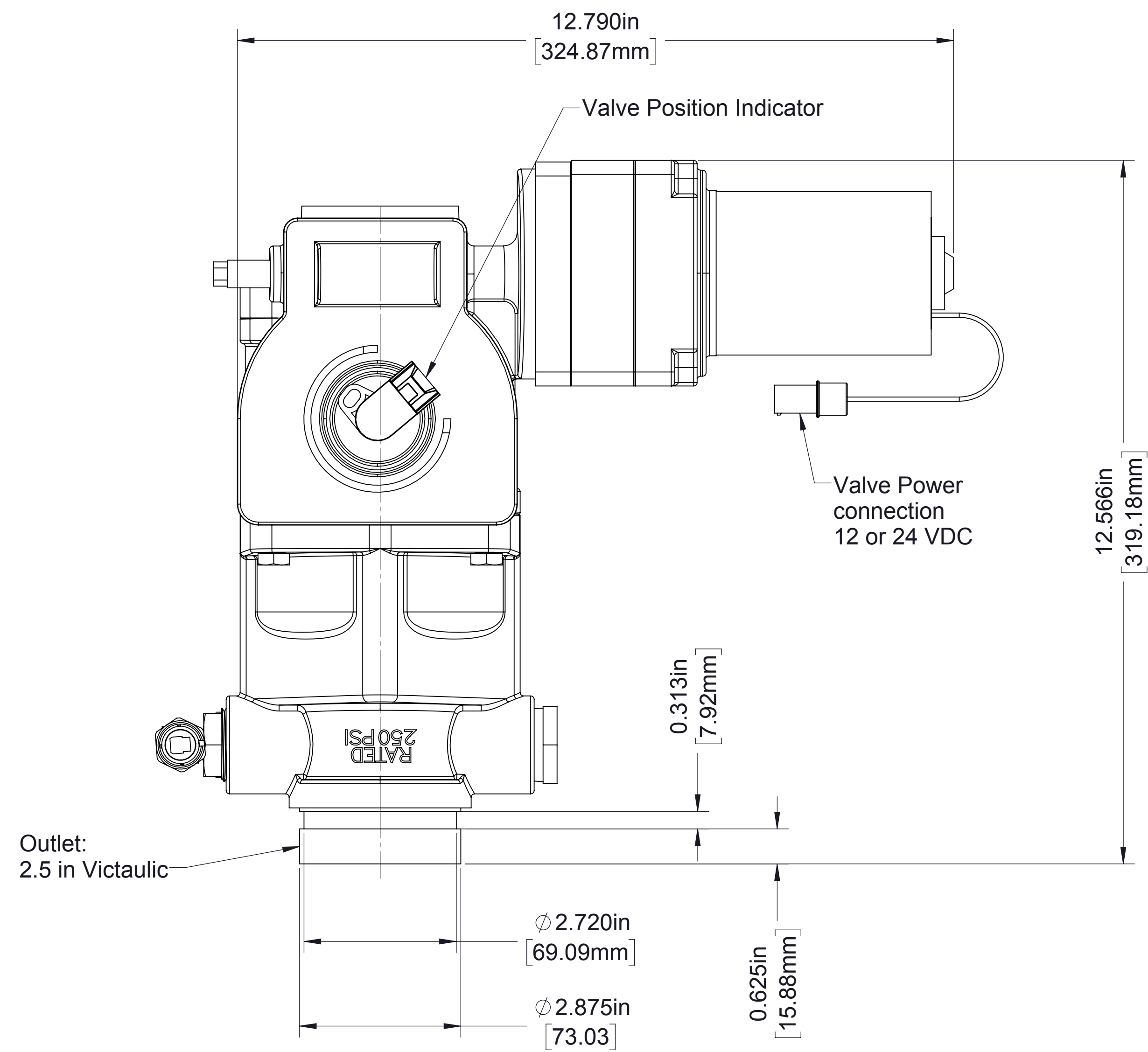

4-Bolt Flange Detail

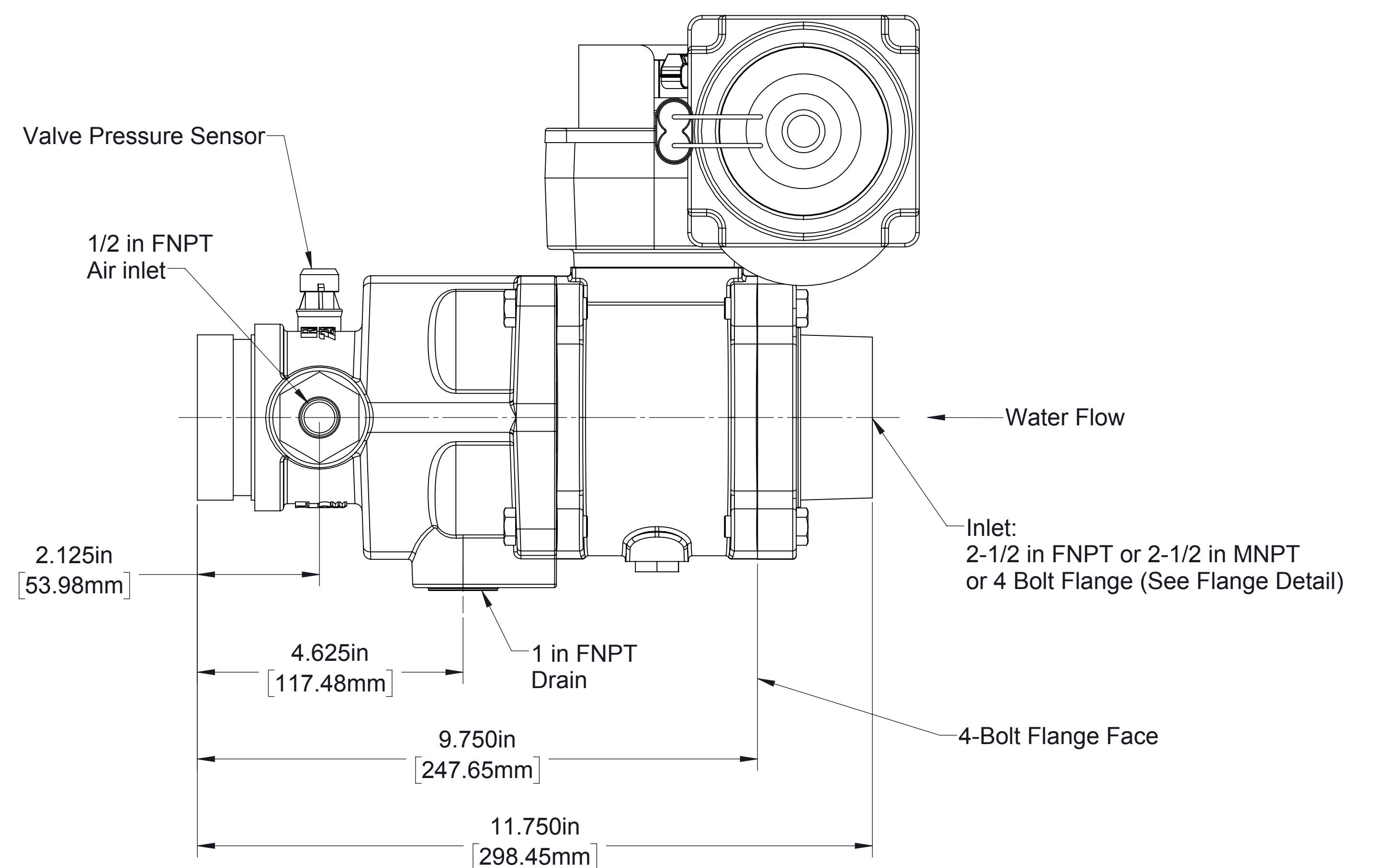
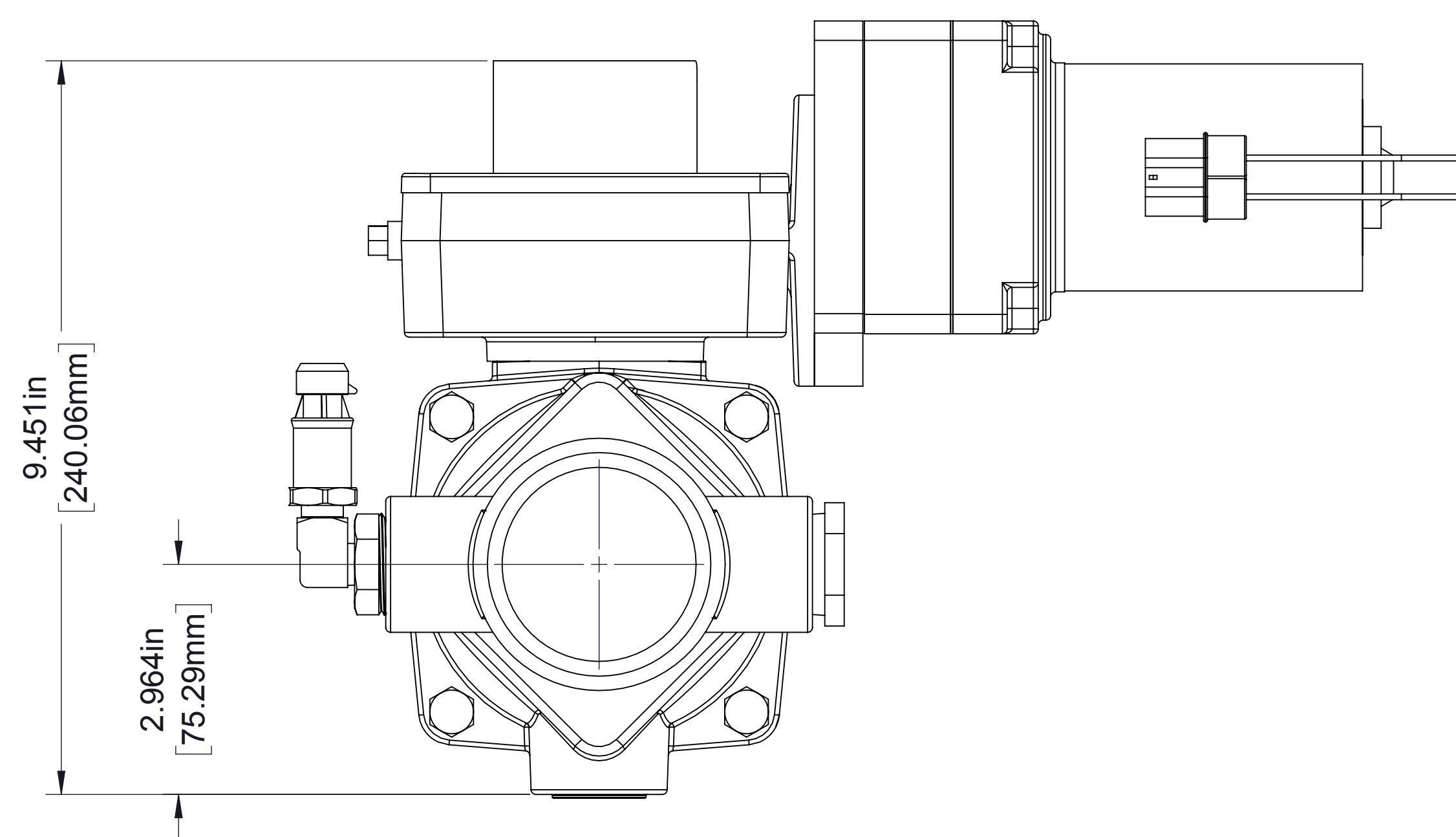

Note:
2.5 in Valve has either victaulic or FNPT on outlet.
See page 5 for FNPT outlet.

2.5 in Electric Ball Valve
(2.5 in Victaulic Outlet)

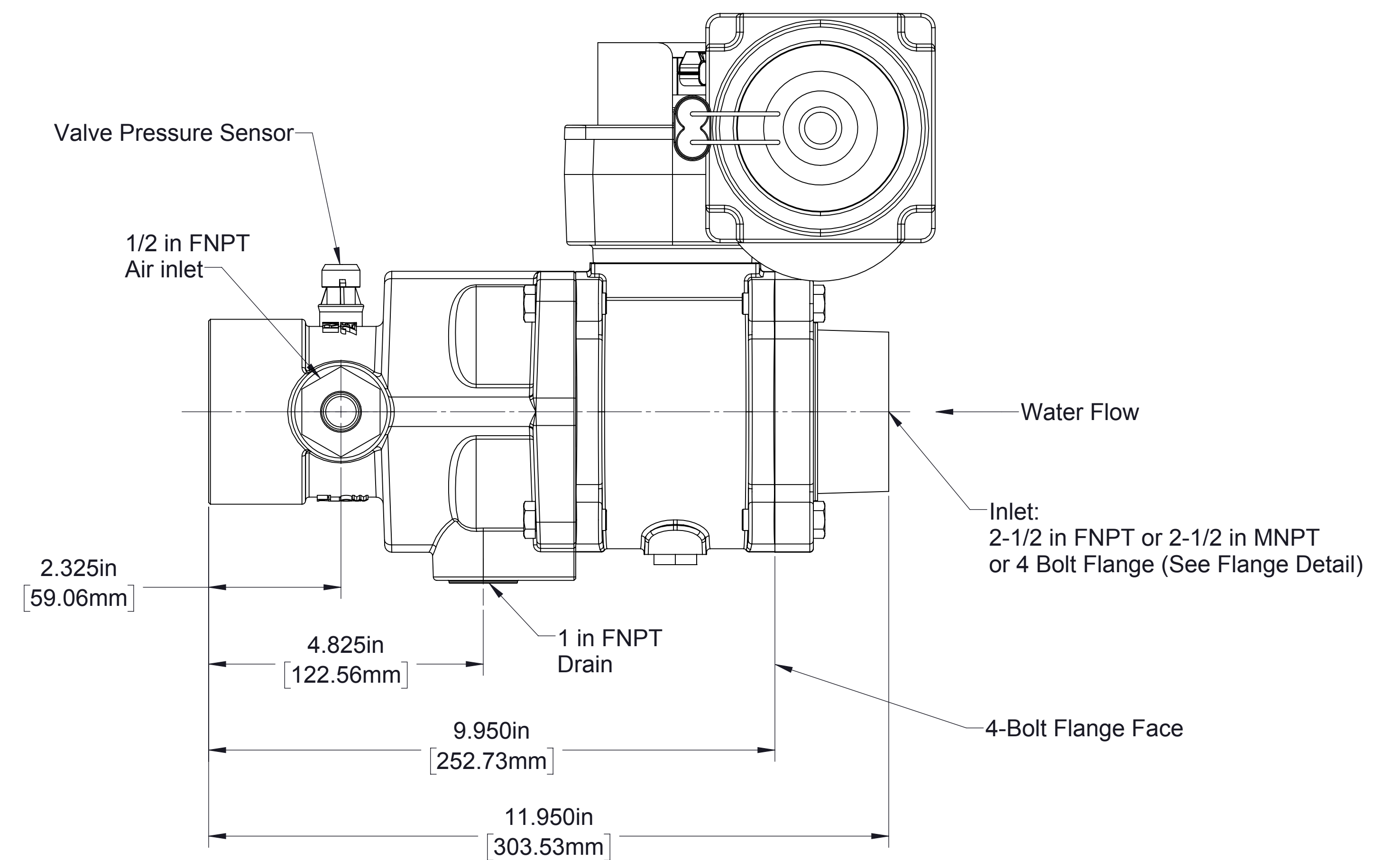
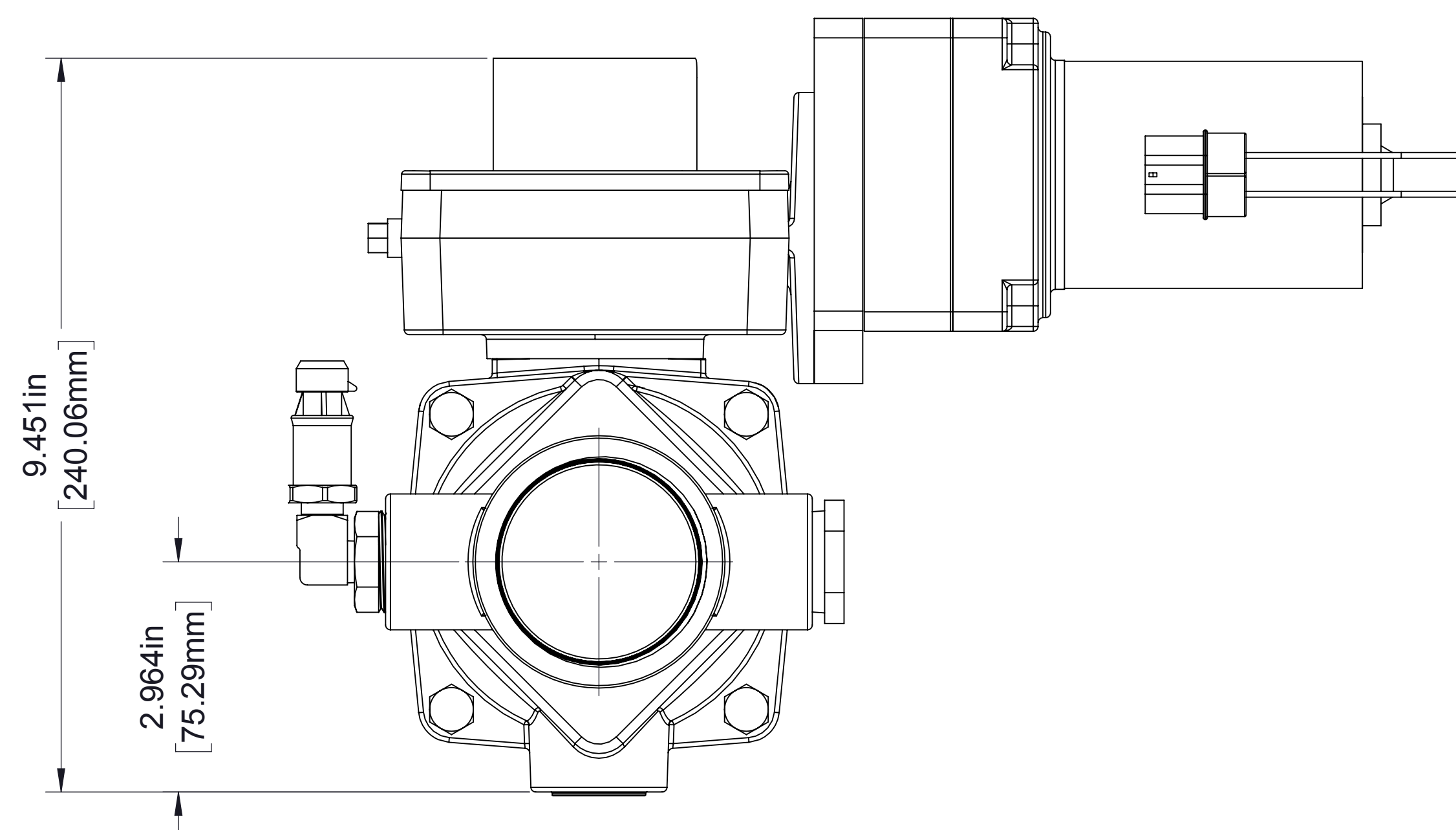
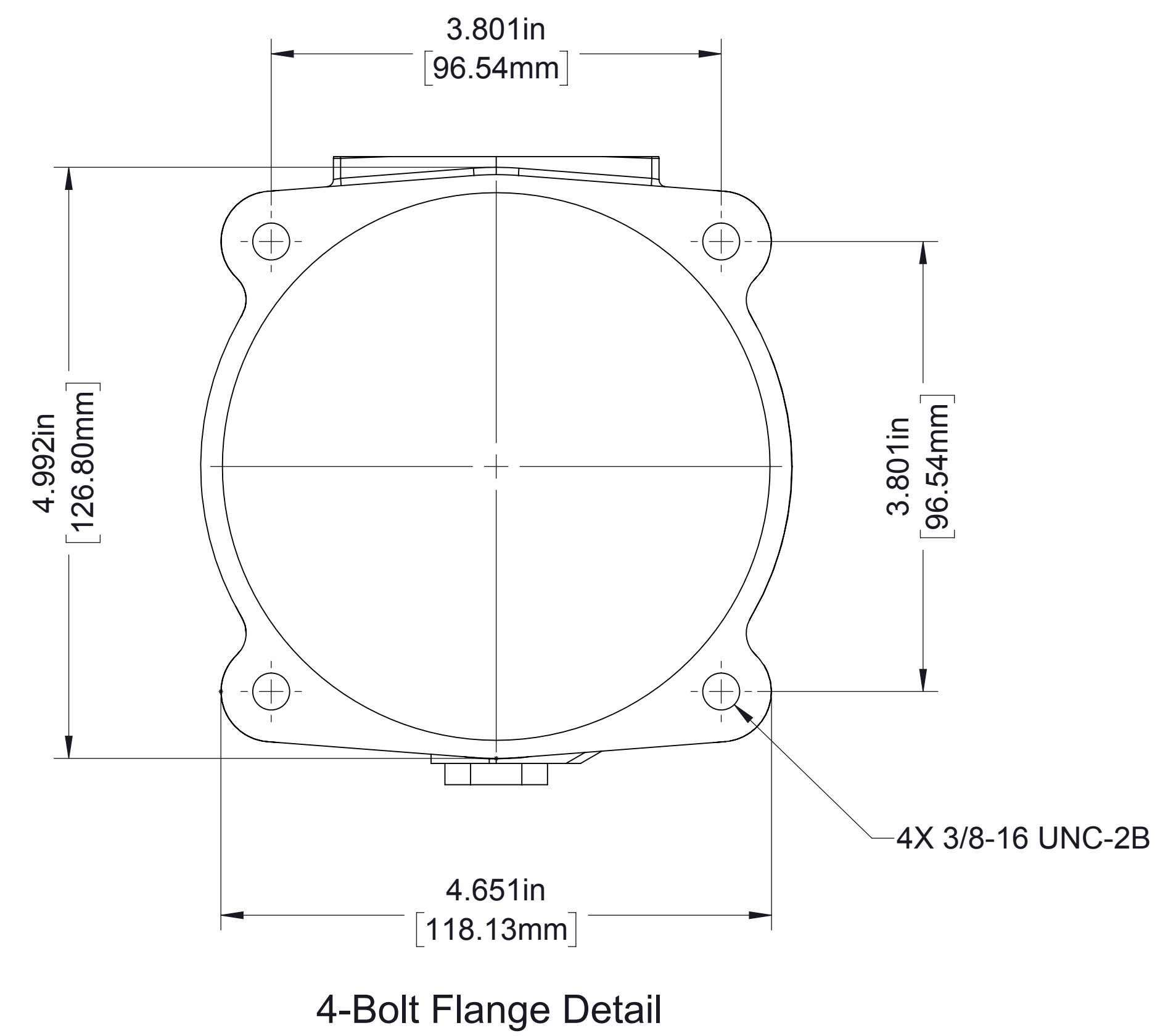
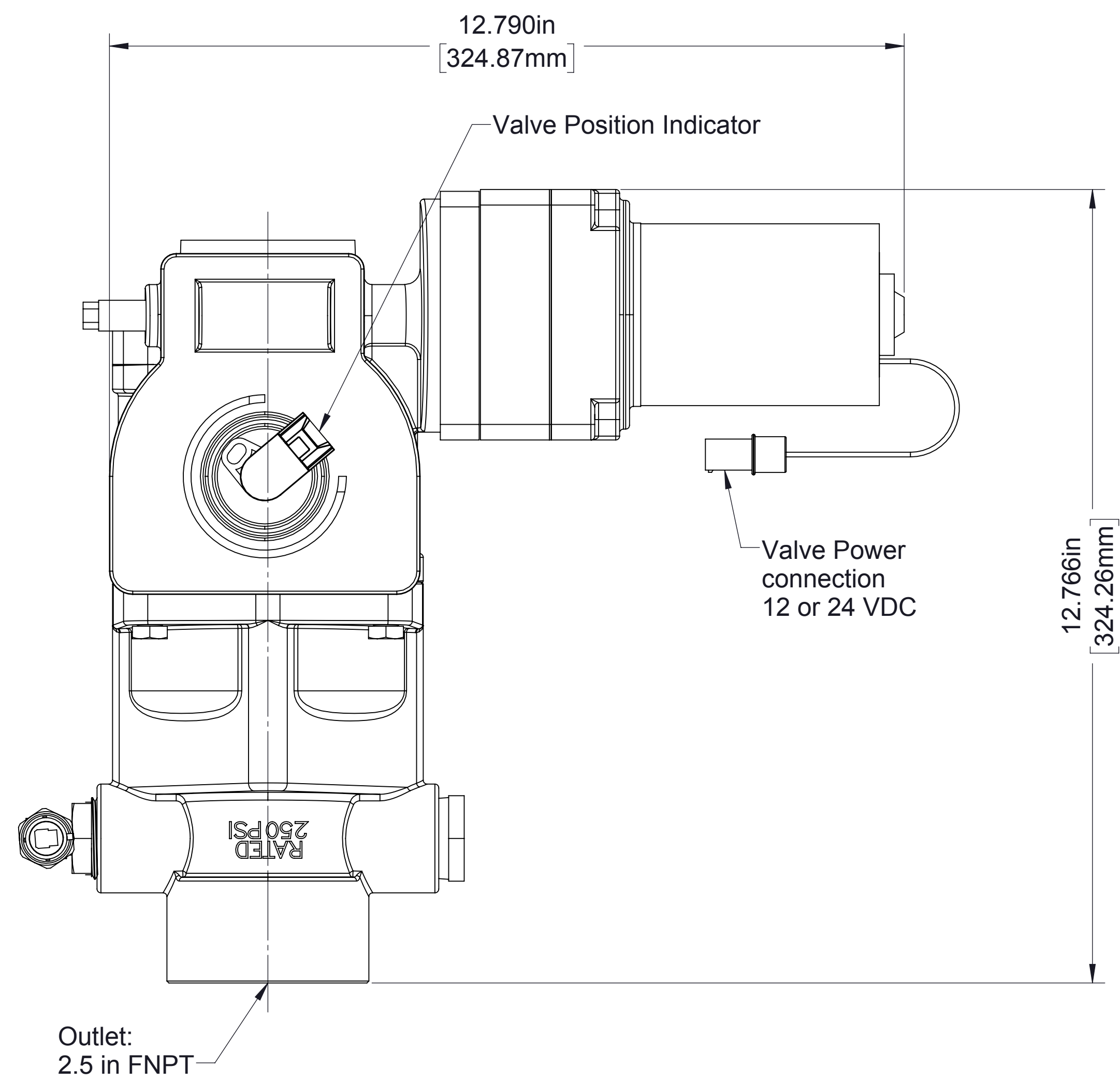

Note:
2.5 in Valve has either victaulic or FNPT on outlet.
See page 4 for victaulic outlet.

2.5 in Electric Ball Valve
(2.5 in FNPT Outlet)

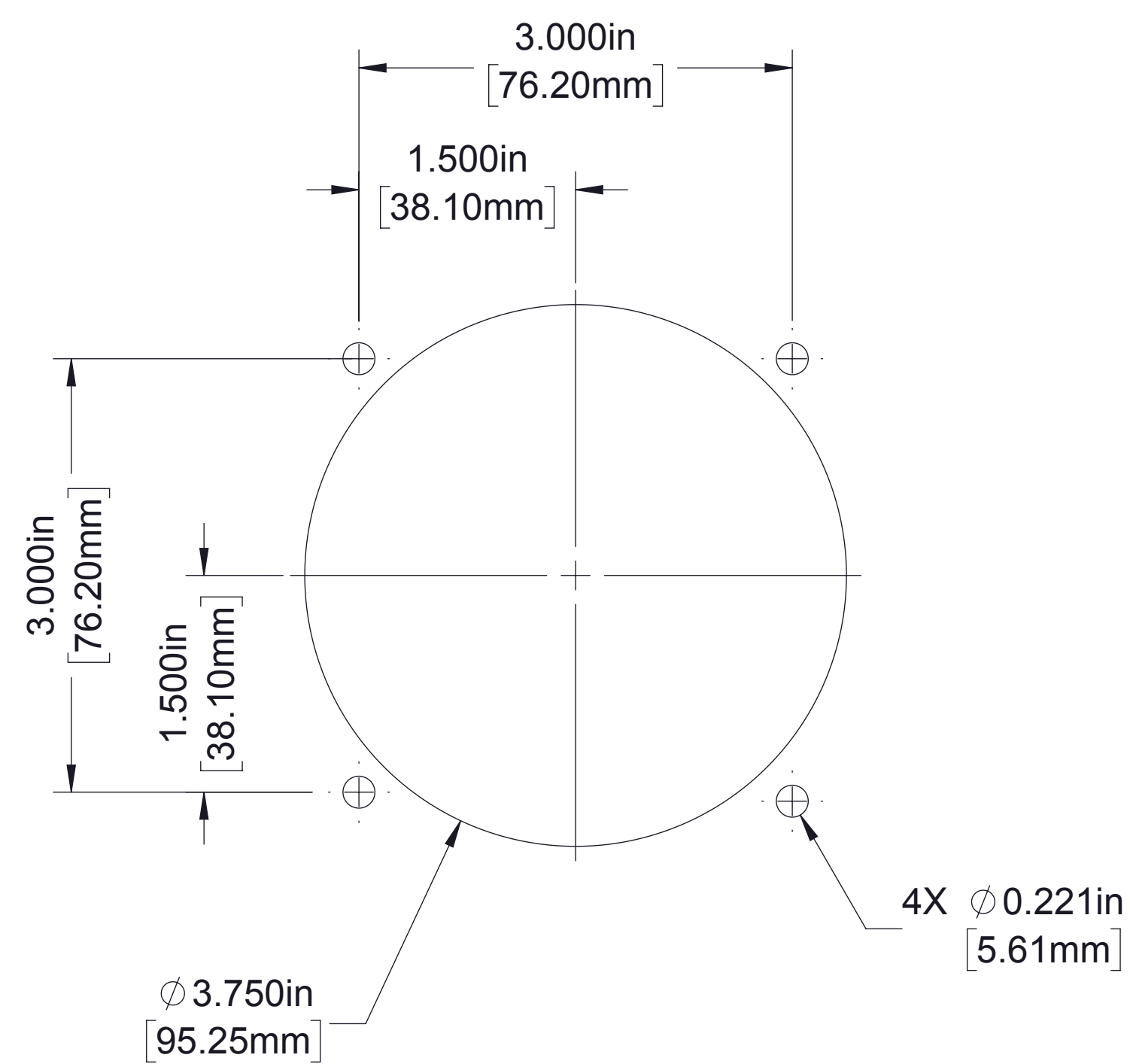

Panel Cut-Out

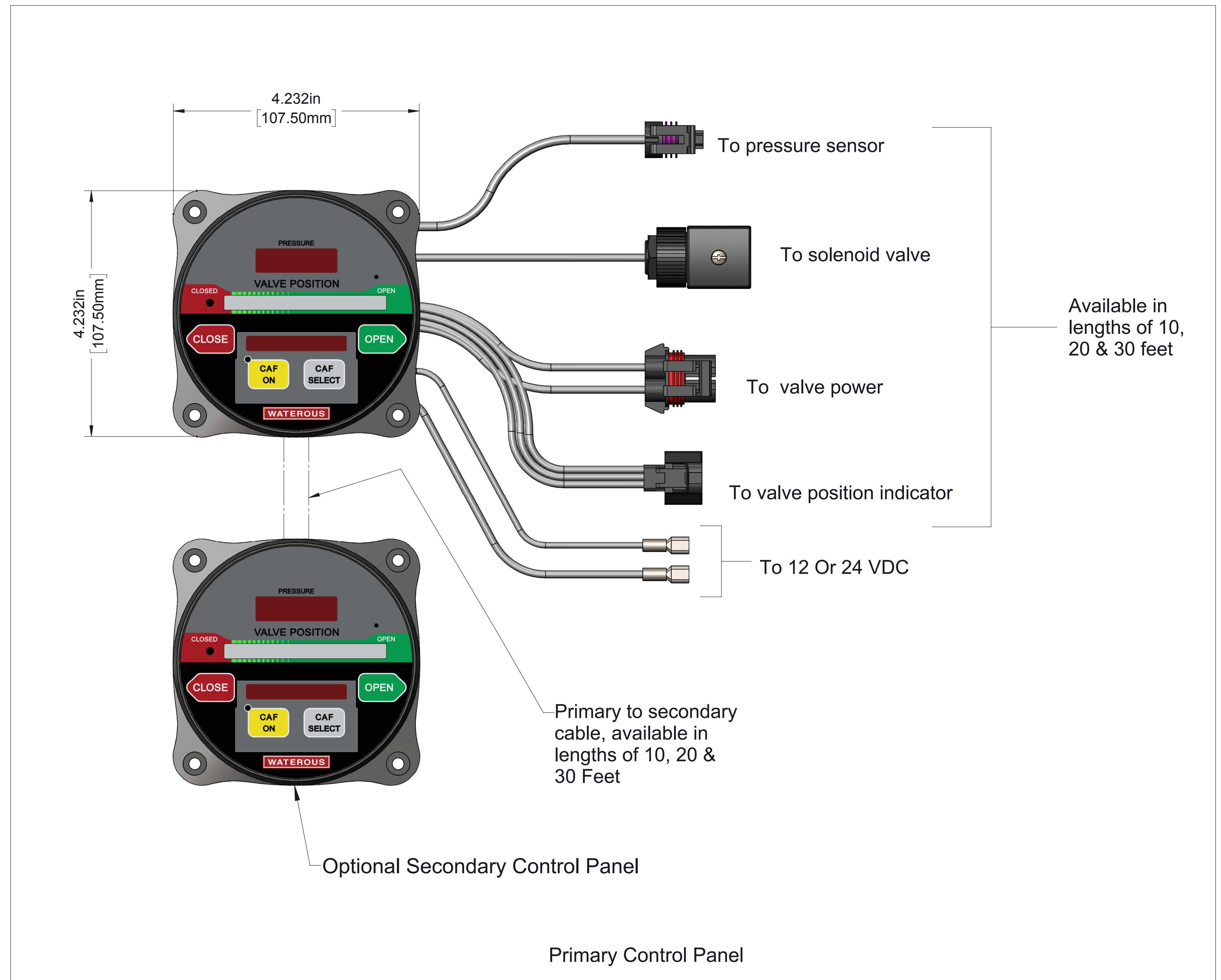

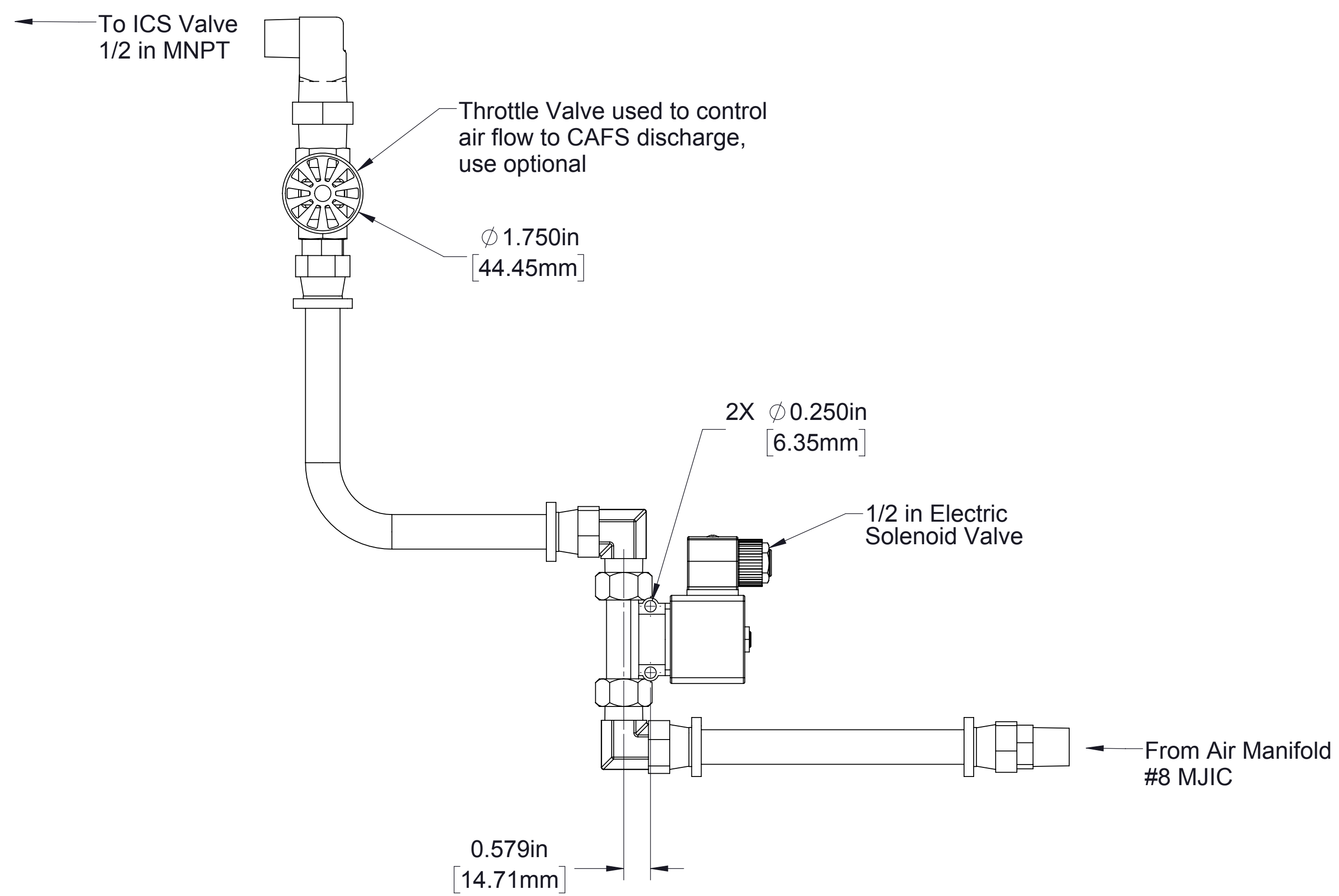

1.5 in and 2.0 in Valve, 1/2 in Hose and Fittings

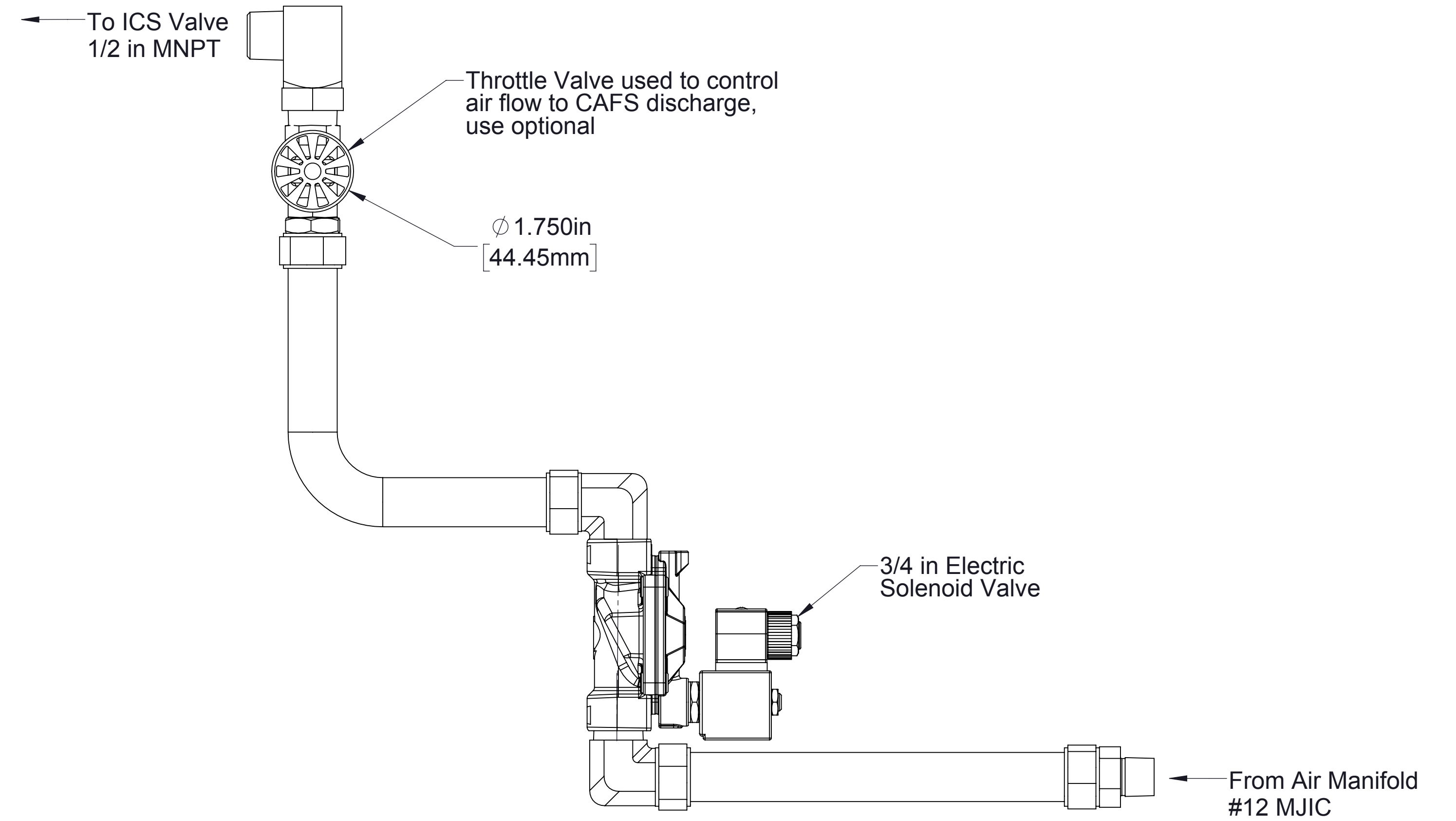

2.5 in Valve, 3/4 in Hose and Fittings

Note:
10 feet/3.04 meter length of hose furnished with each valve.