

Venturis Air Primer Dimensional Drawings

Component	Mounting	See Page	
		Single Primer	Dual Primers (Industrial Use)
Venturis Air Primer	On the Transmission by Waterous	2	--
	On the PTO by Waterous	3	
	By the OEM	4	5
Panel Activation		6, 7	
For Priming Valve Dimensions, see DPL82908			

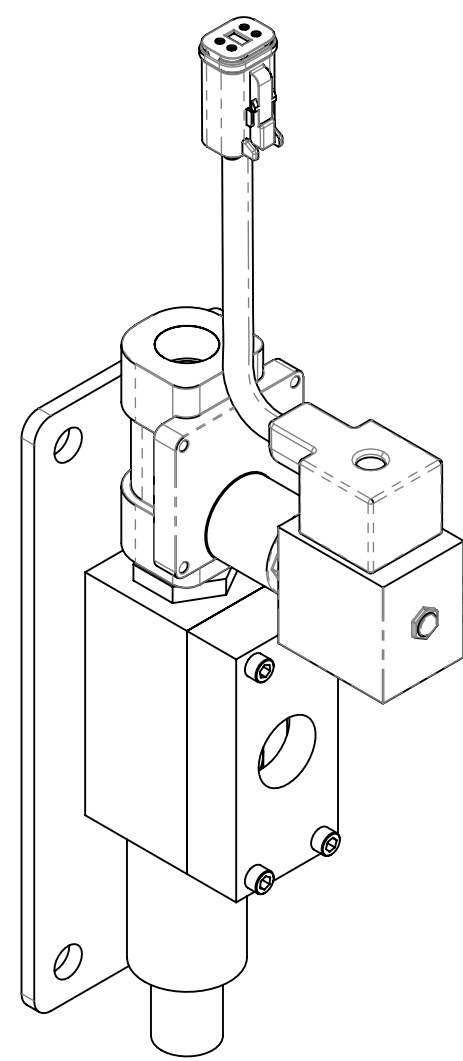

Single Primer

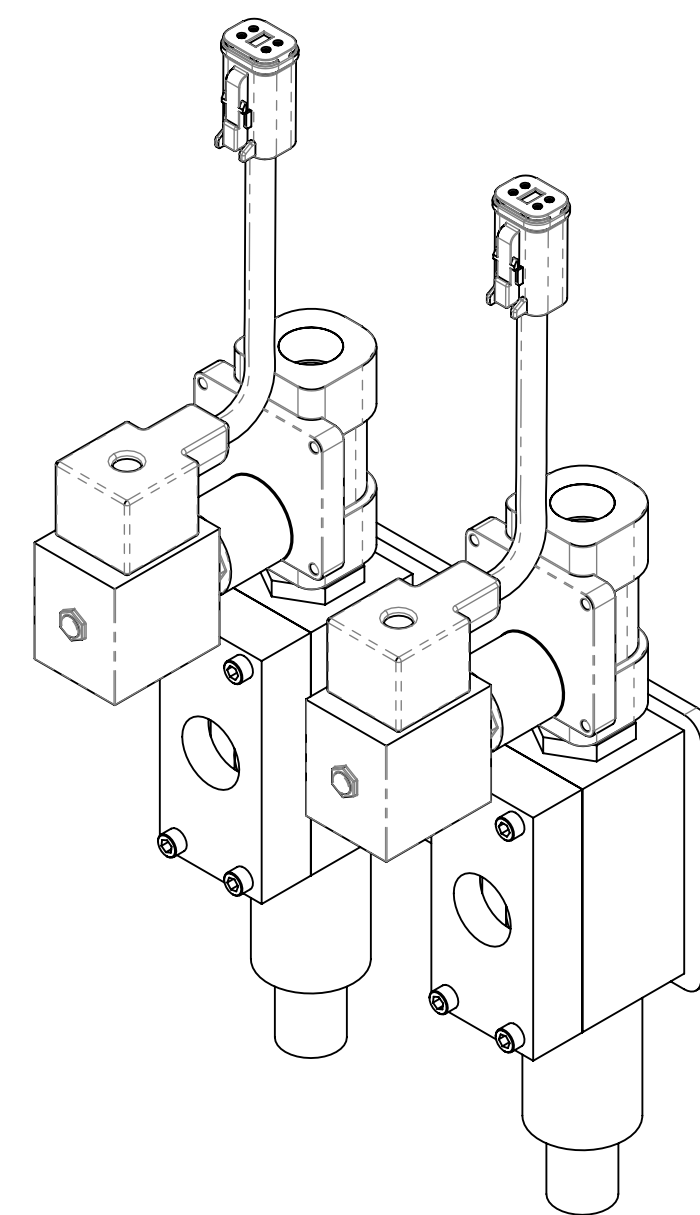

Dual Primers

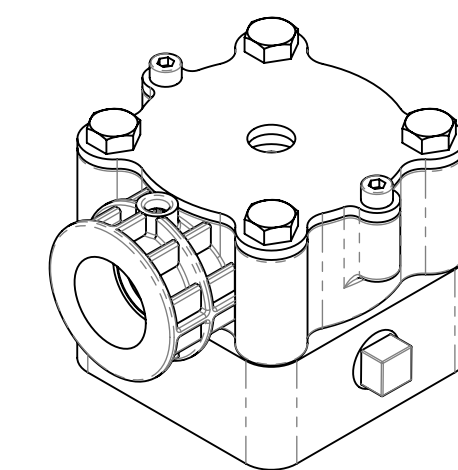

VAP Priming Valve

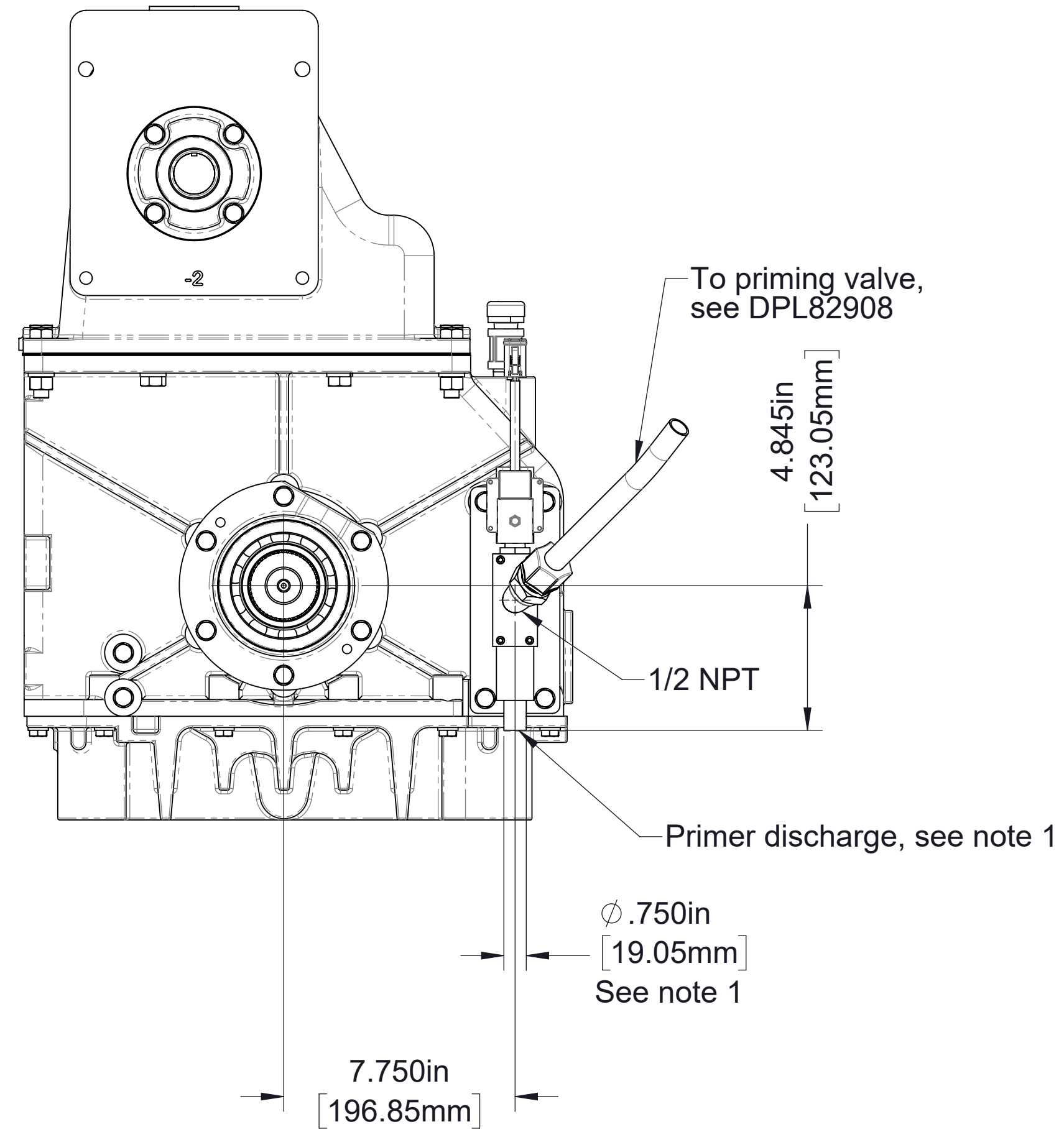
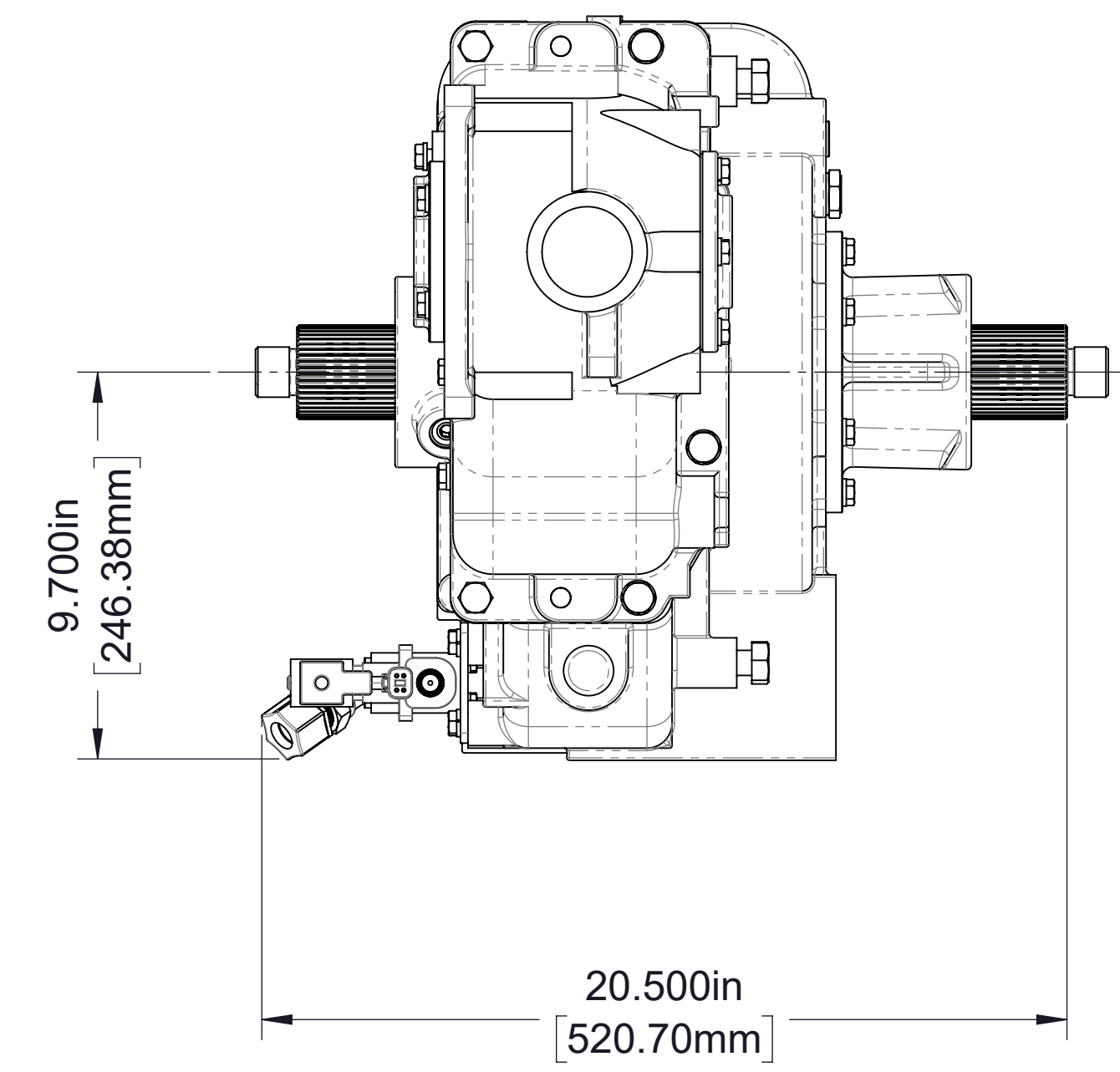

16.40 ft (5 meter)
Solenoid cable (furnished)

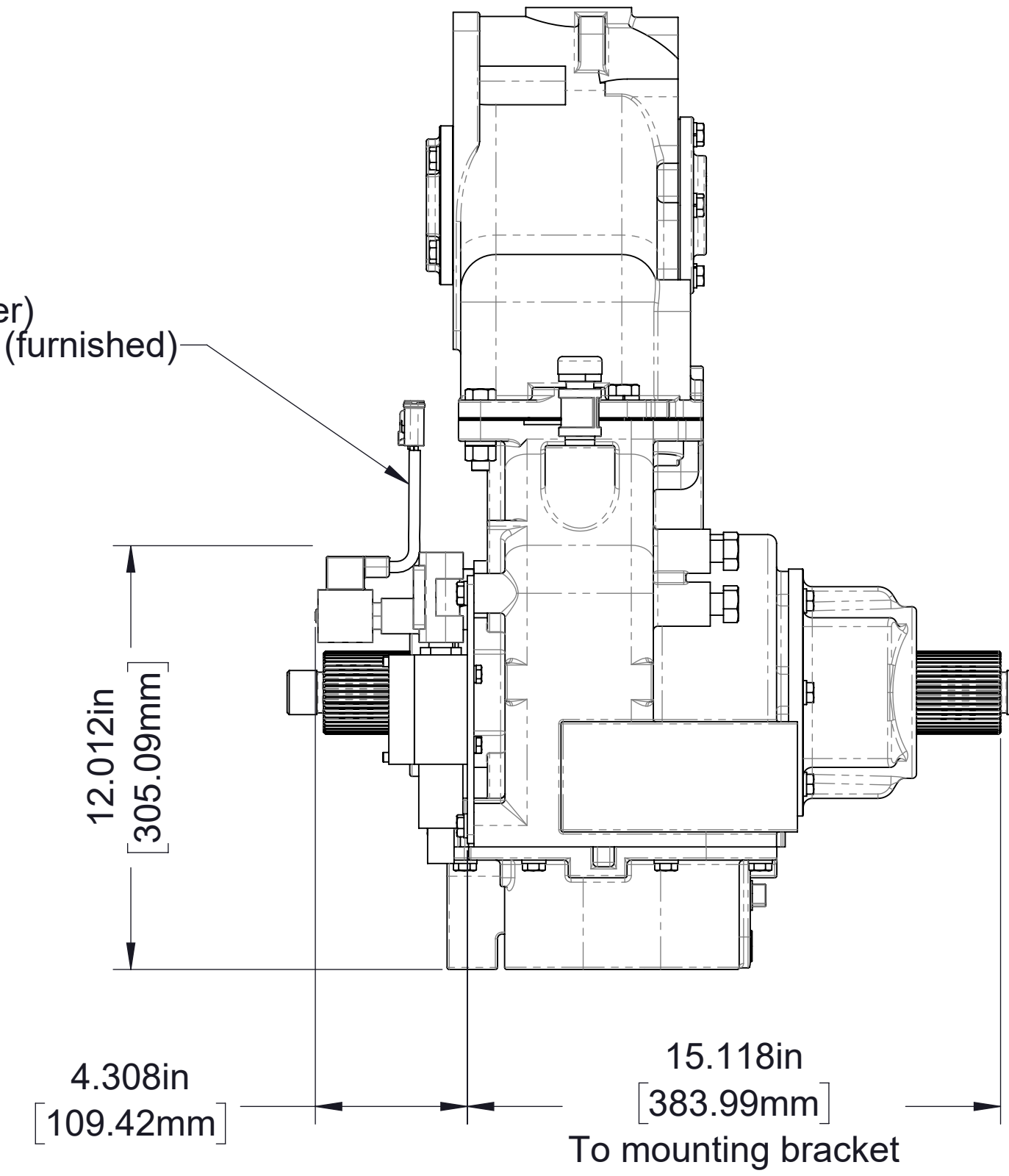

Note:
1. OEM may attach a 3/4 in I.D. hose to air primer to direct exhaust to a more suitable location. Make sure flow is not impeded.

Air Primer Mounted on Transmission
(C20, C21, C22, C23 Series Transmissions)

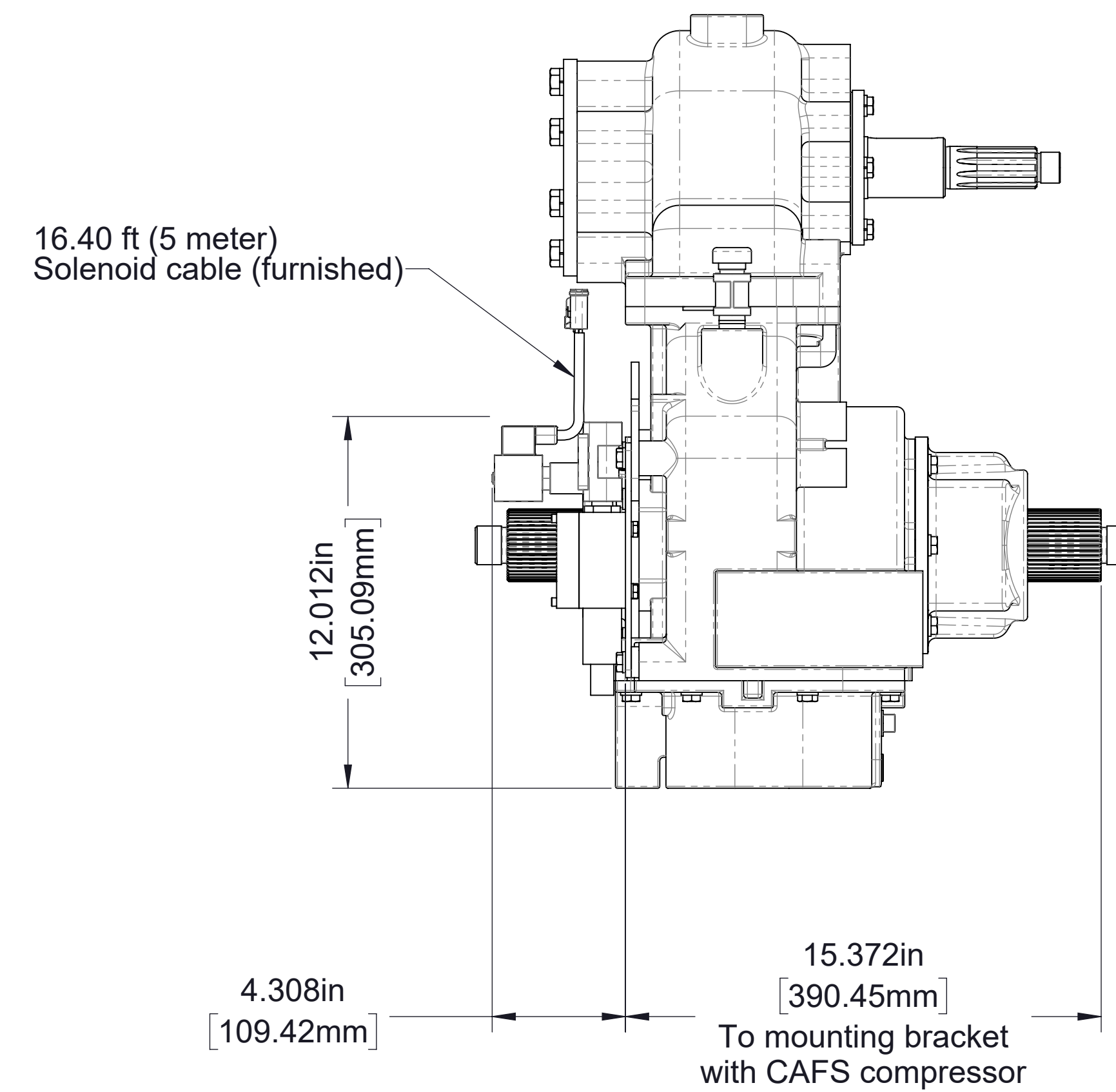
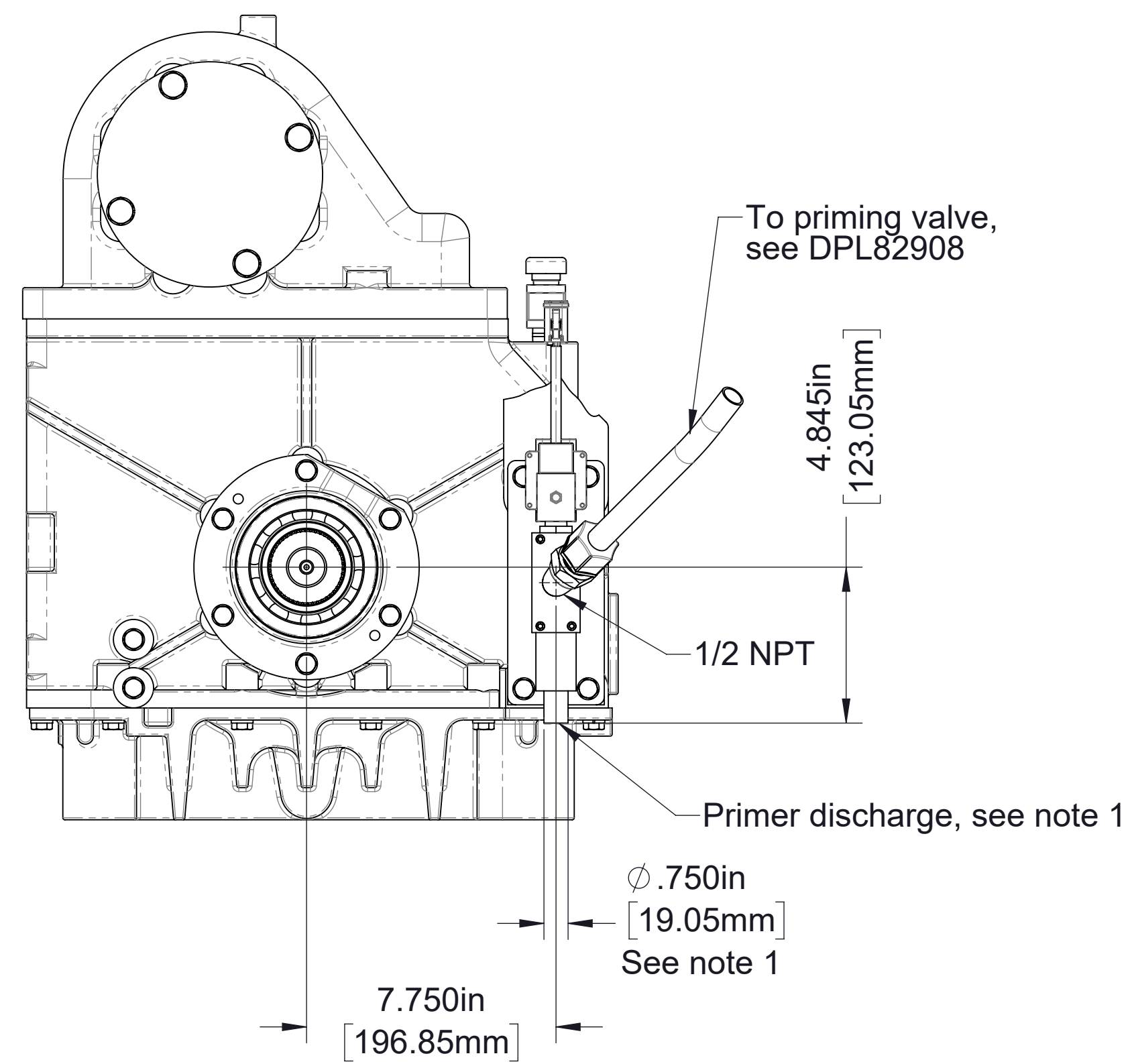
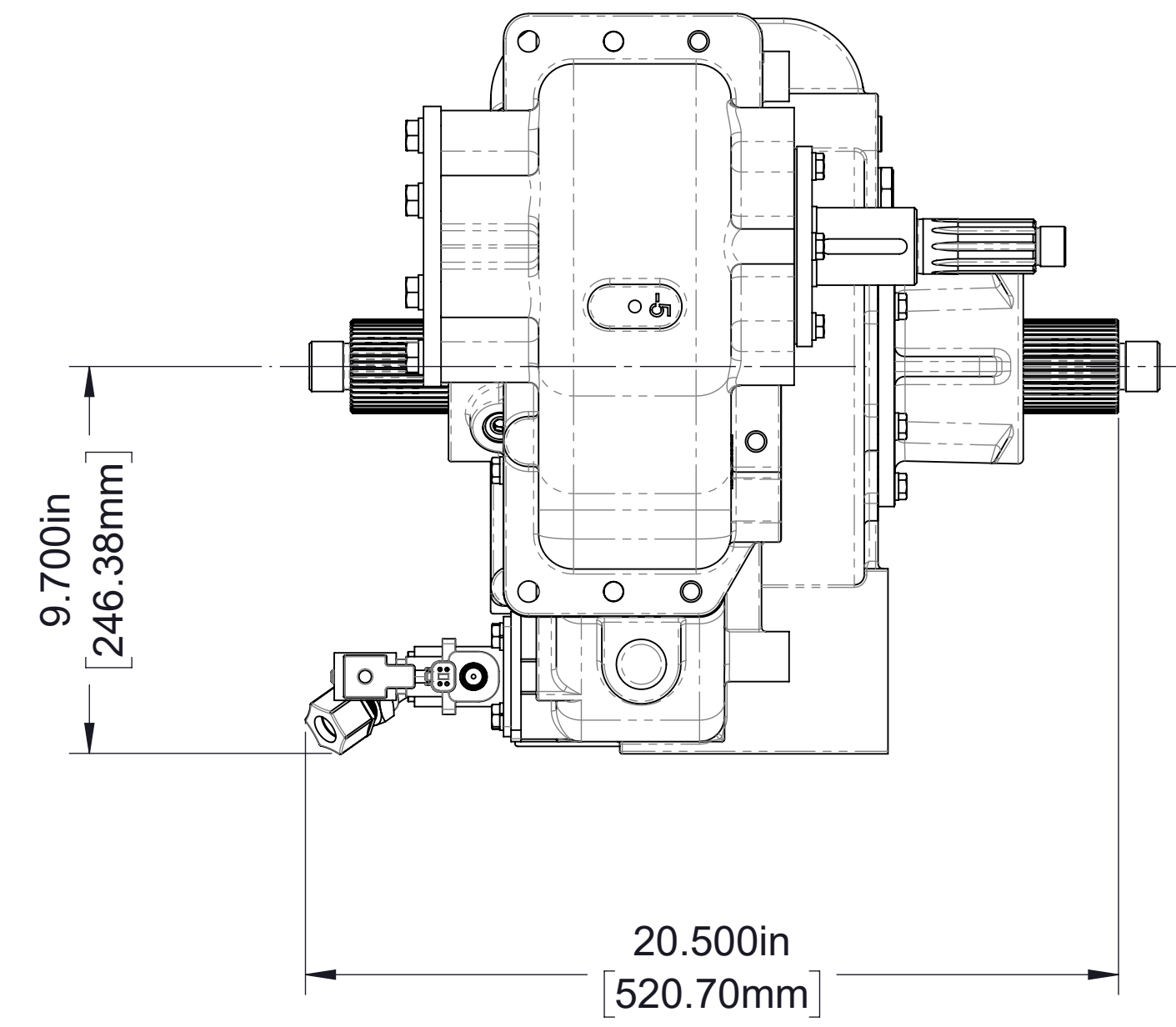

Note:
 1. OEM may attach a 3/4 in I.D. hose to air primer to direct exhaust to a more suitable location. Make sure flow is not impeded.

Air Primer Mounted on PTO
 (TC20, TC21, TC22, TC23 Series PTO's)

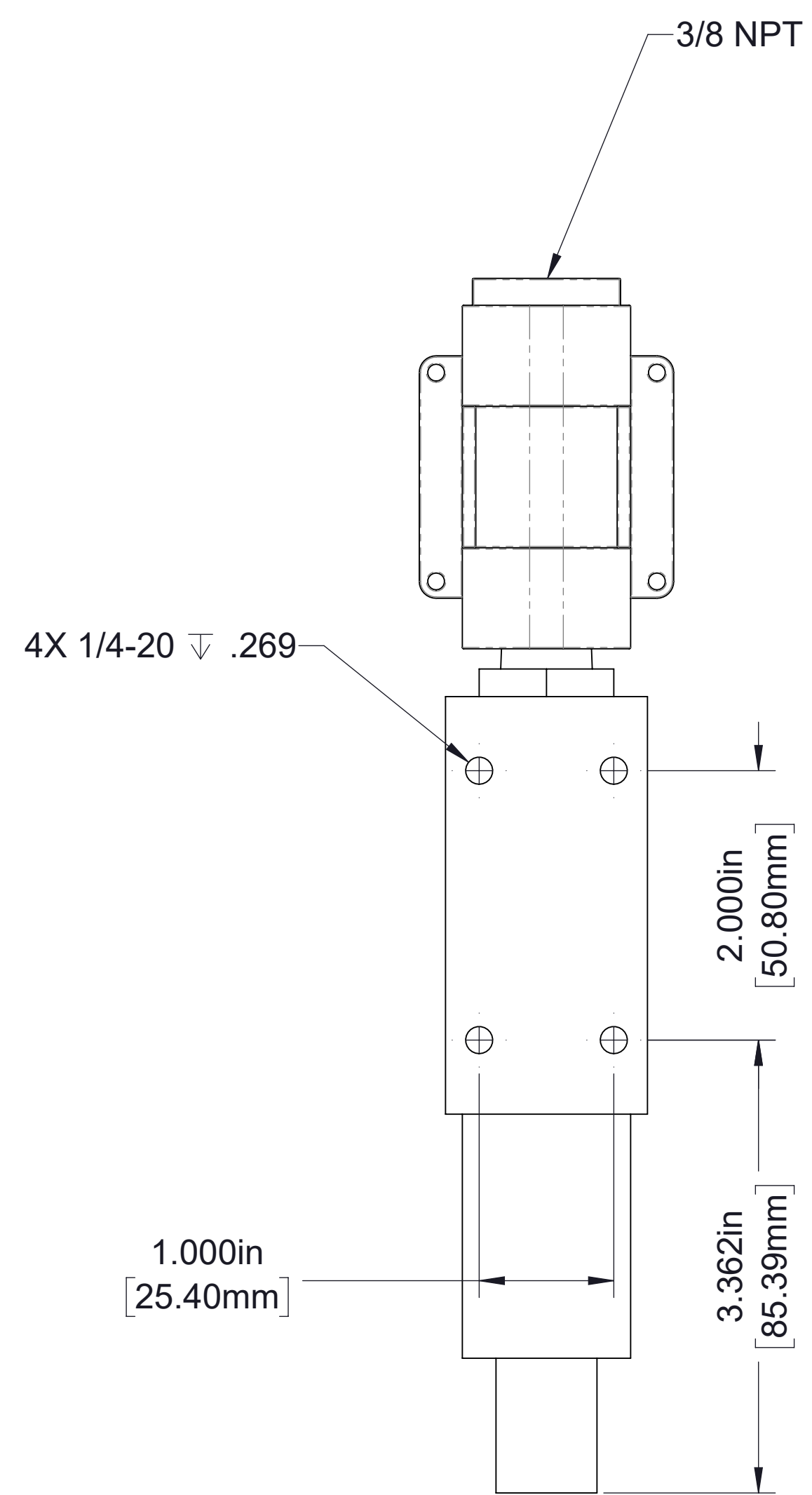

Up

Air Primer must be mounted in this orientation to allow for proper drainage

Down

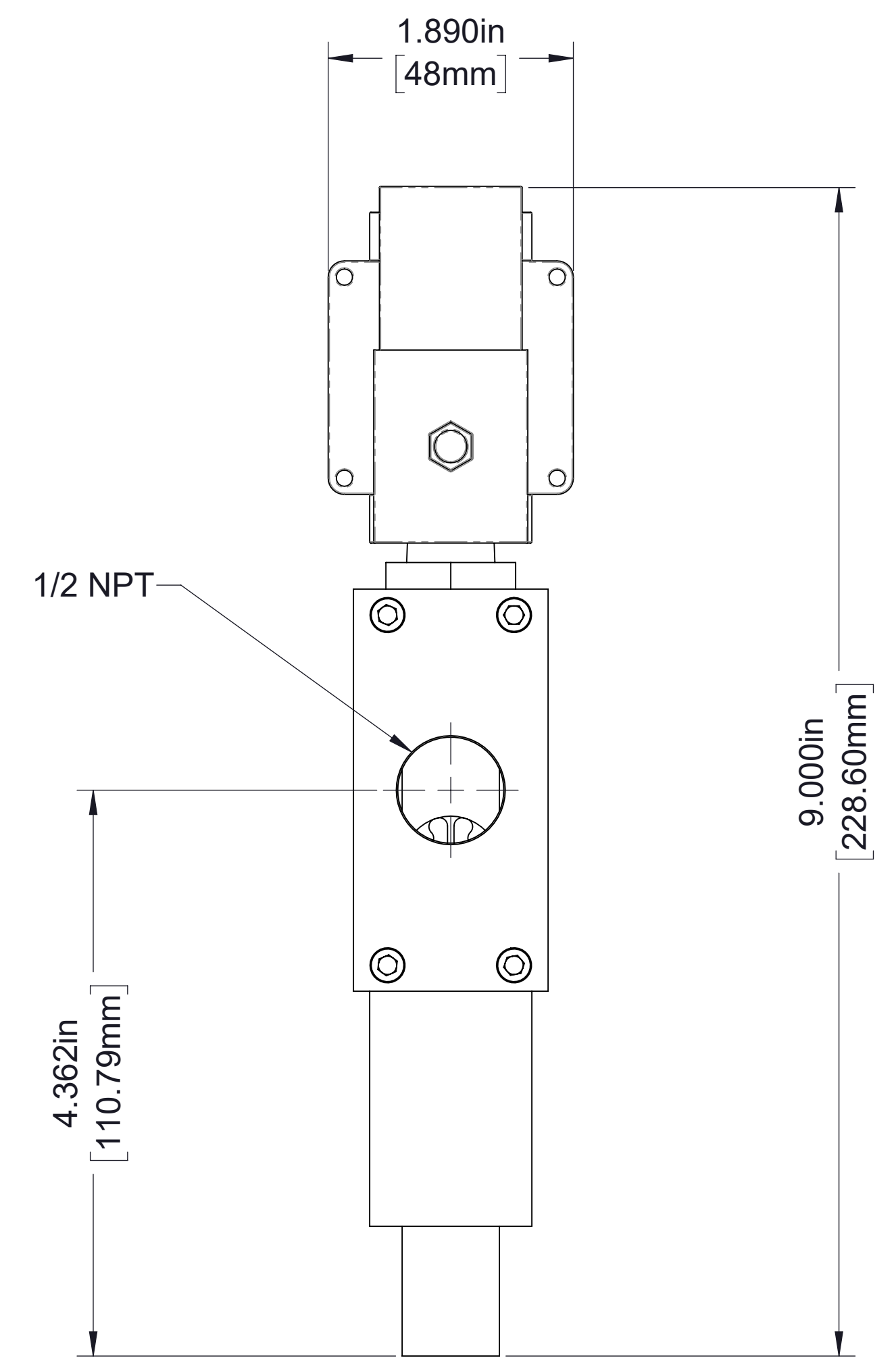
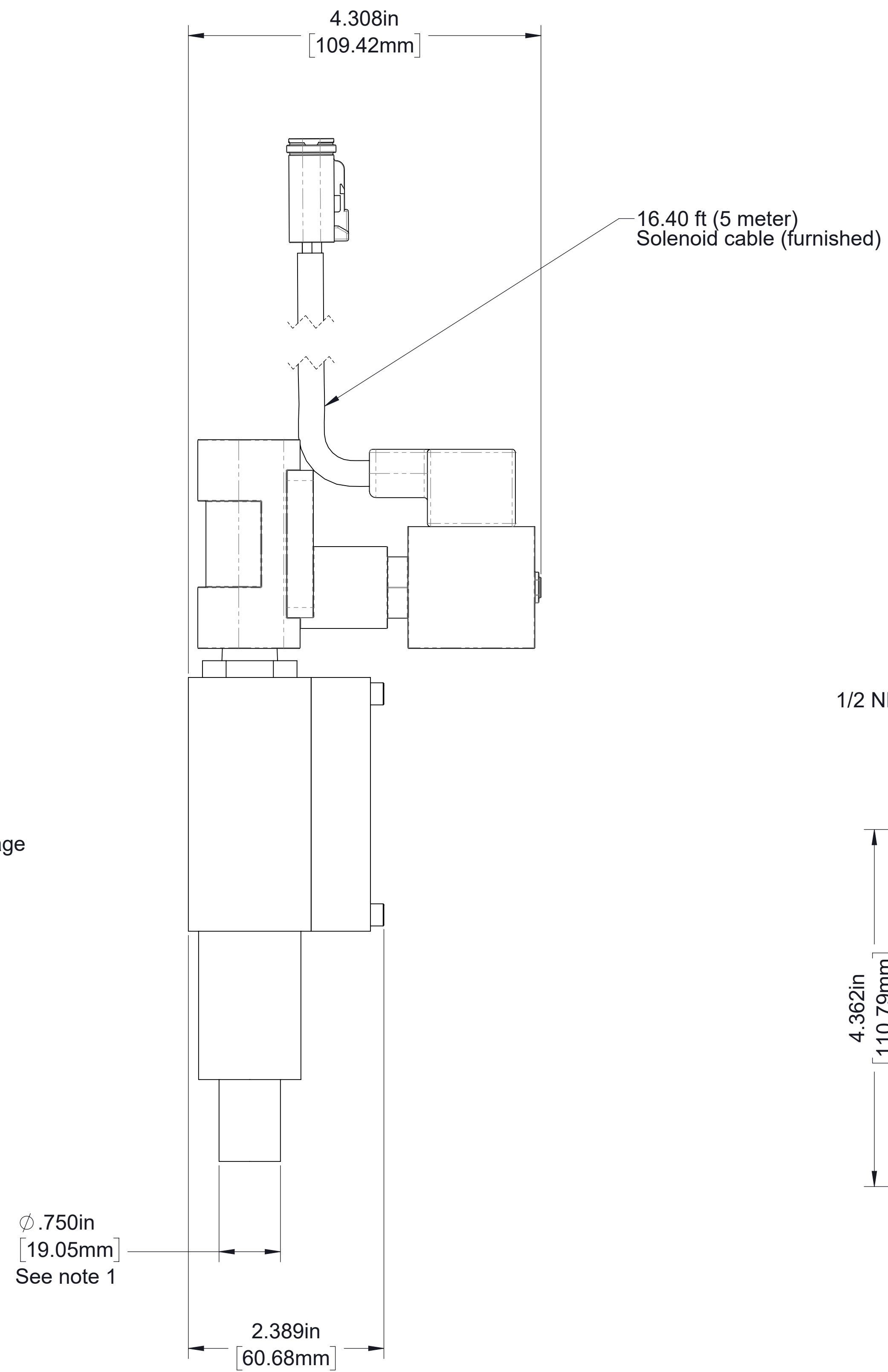

Air Primer Mounted by the OEM

Note:
 1. OEM may attach a 3/4 in I.D. hose to air primer to direct exhaust to a more suitable location. Make sure flow is not impeded.

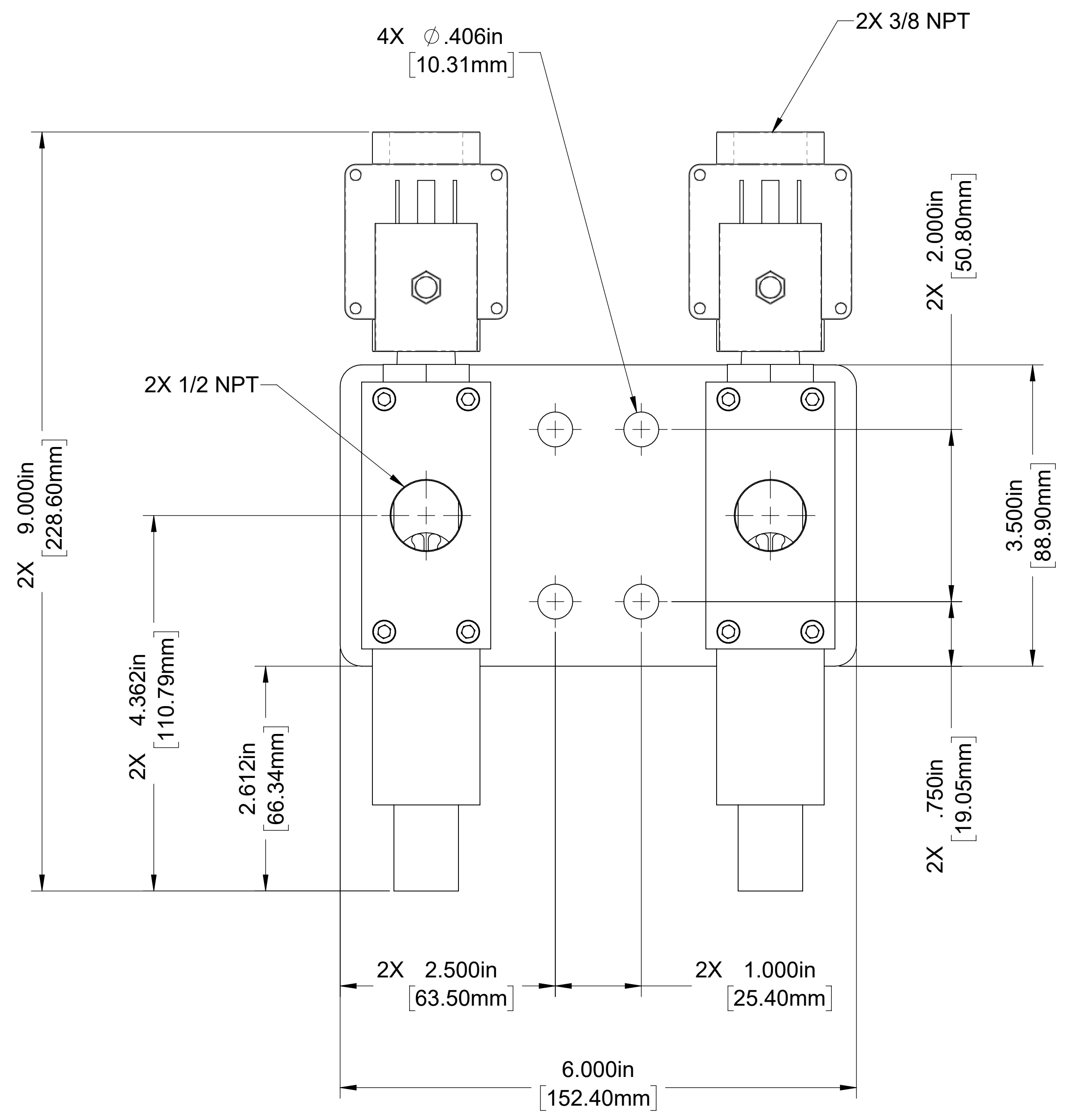

Up

Air Primer must be mounted in this orientation to allow for proper drainage

Down

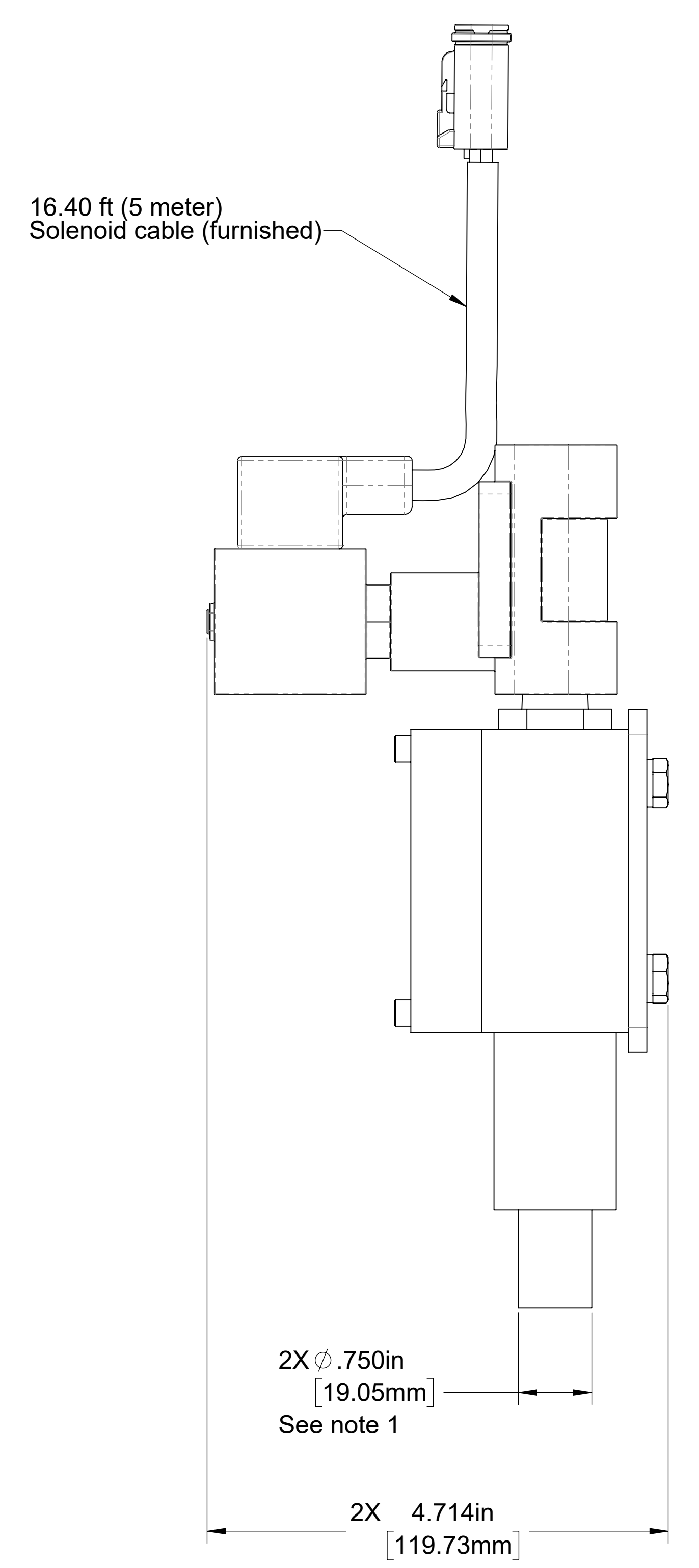

Air Primers Mounted by the OEM (Industrial Use)

Note:
 1. OEM may attach a 3/4 in I.D. hose to air primer to direct exhaust to a more suitable location. Make sure flow is not impeded.

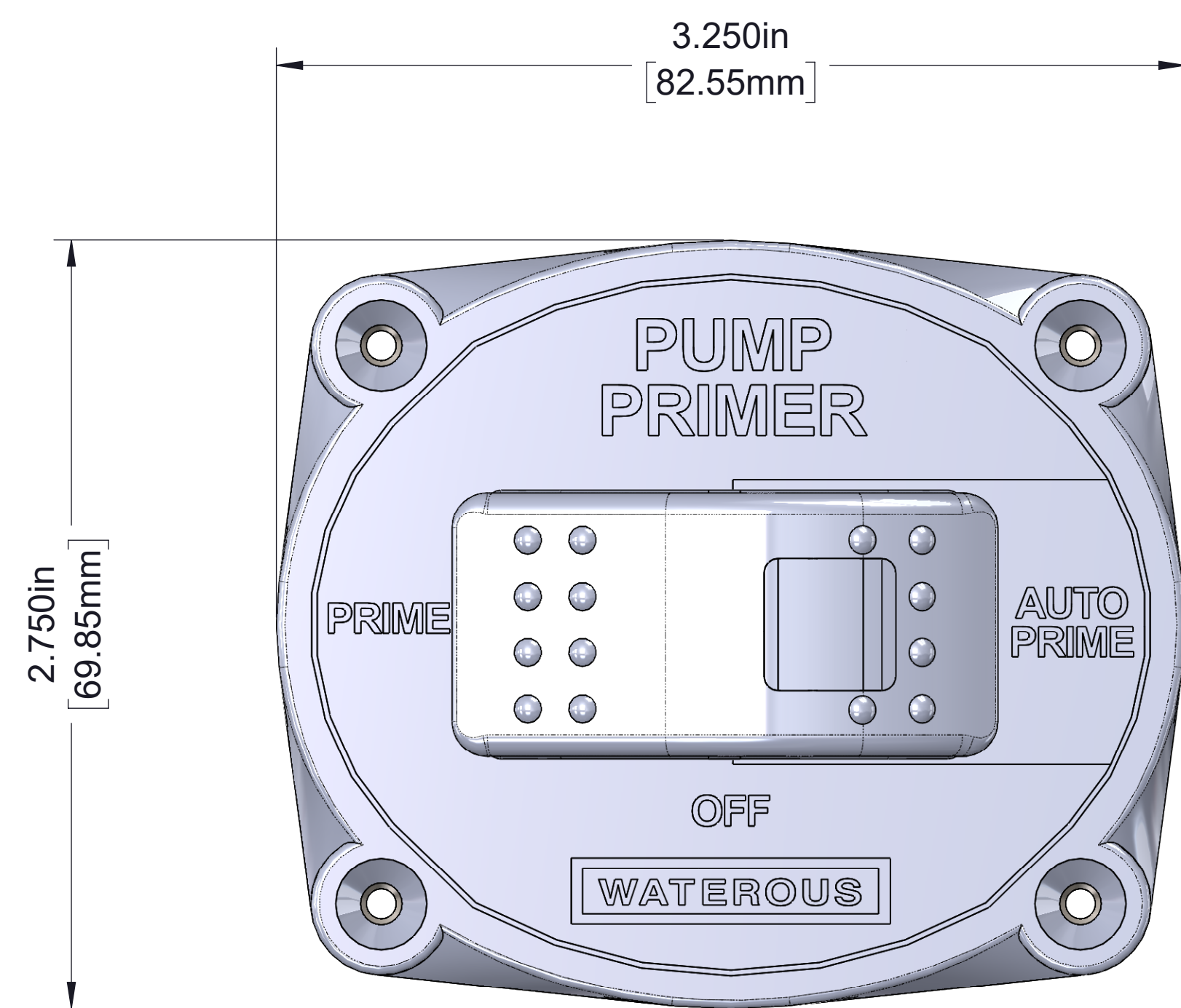

**Rocker Switch
(Mounting Hardware Included)**

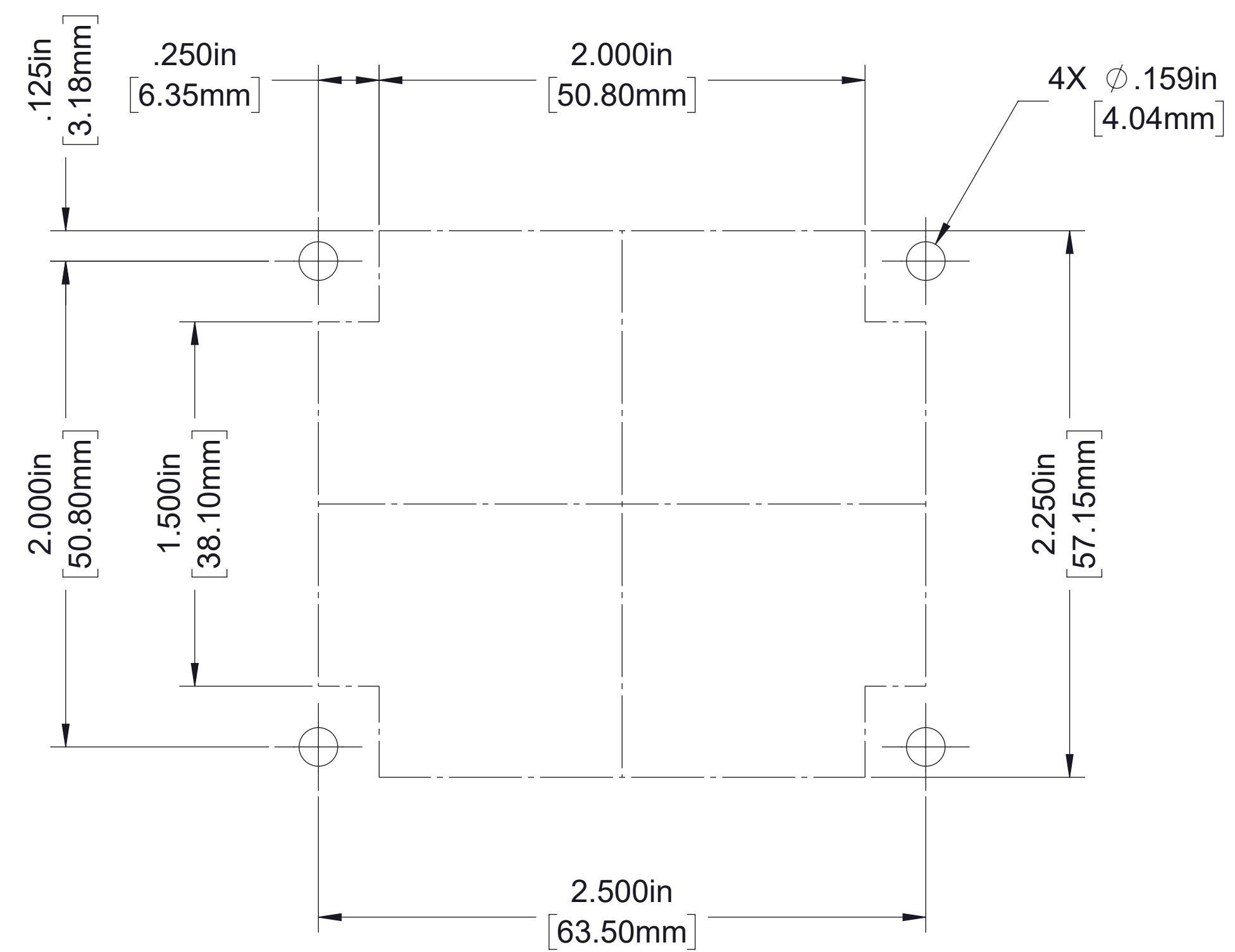

Panel Hole Layout

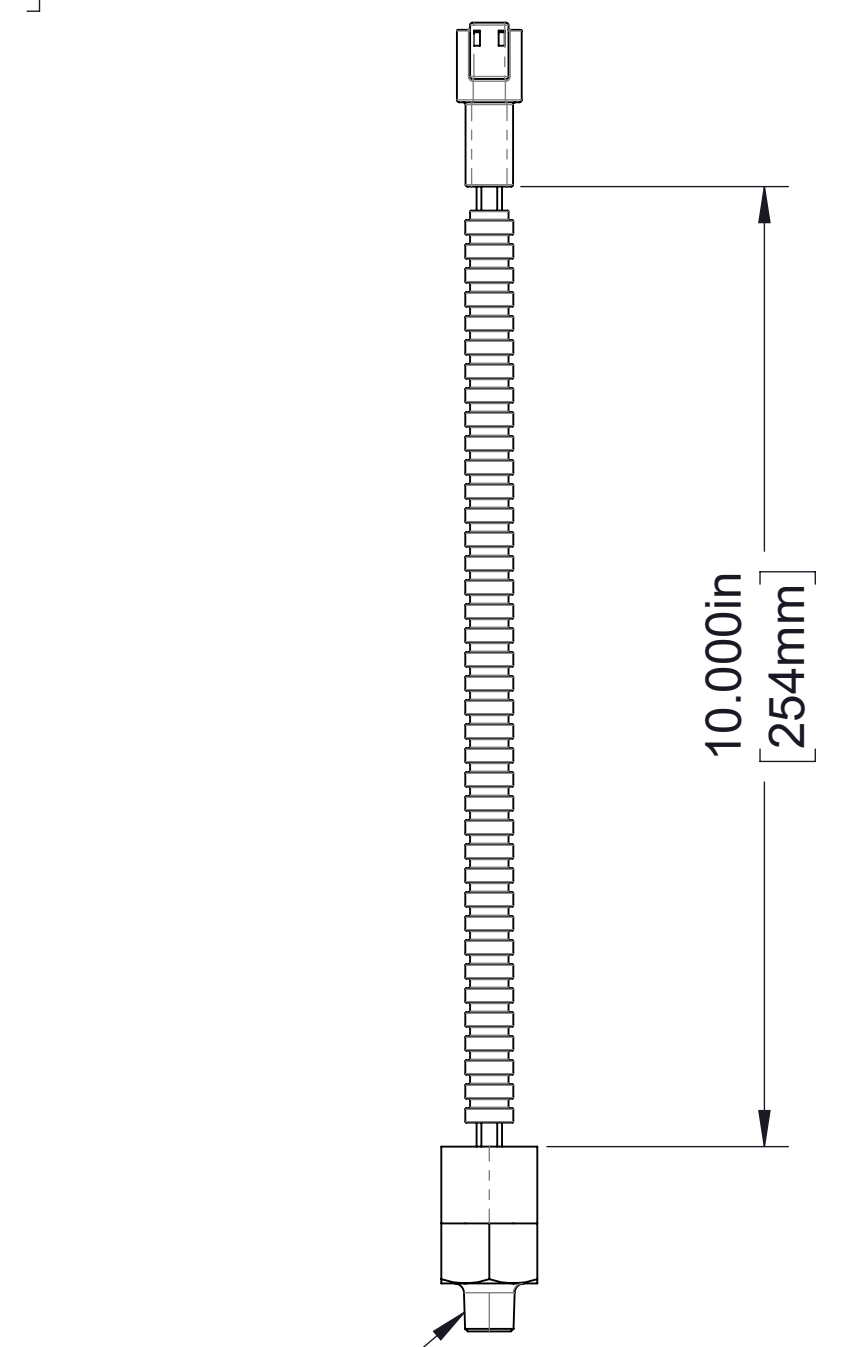

1/4 NPT

Pressure Switch

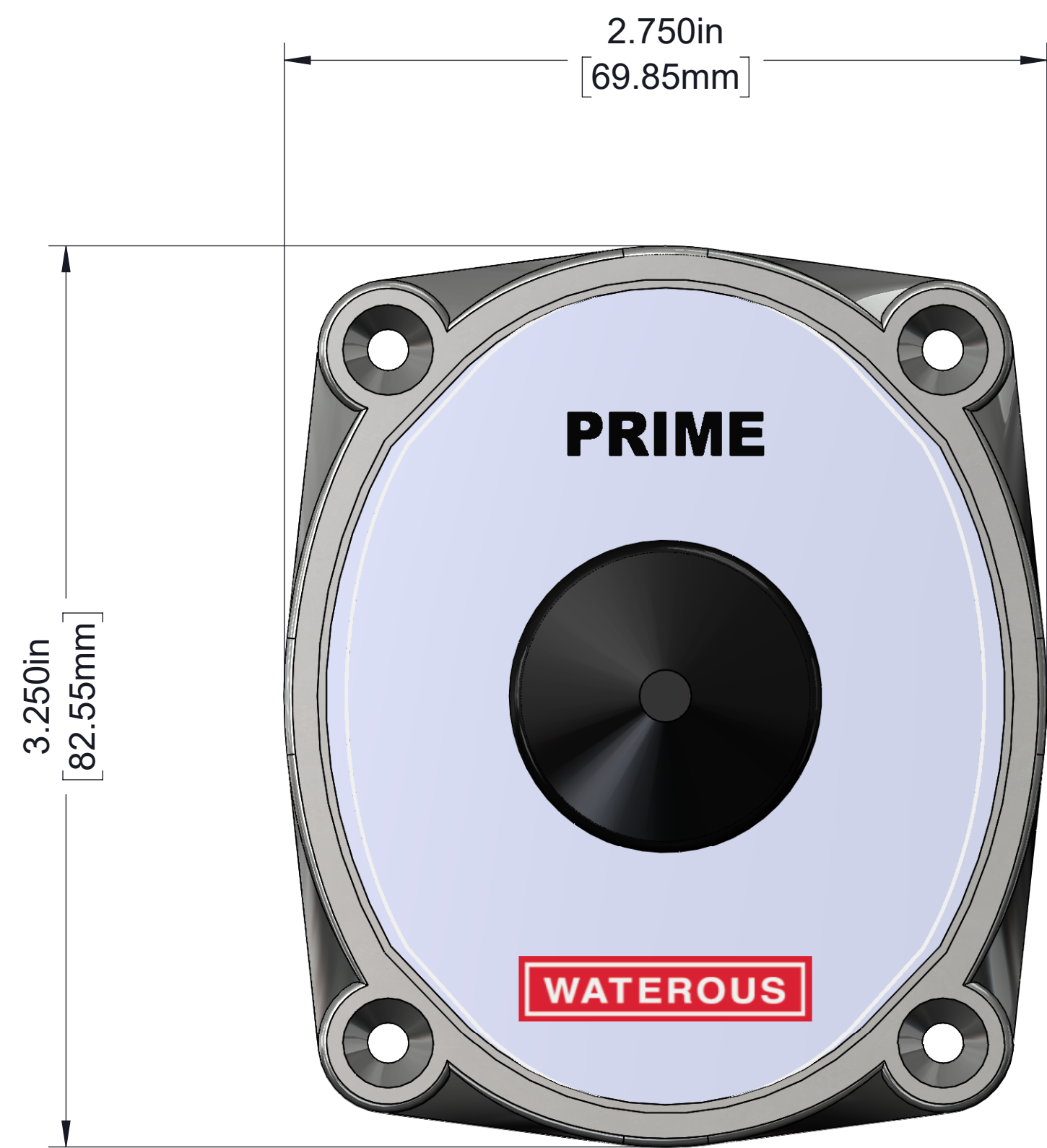

**Push-Button
(Mounting Hardware Included)**

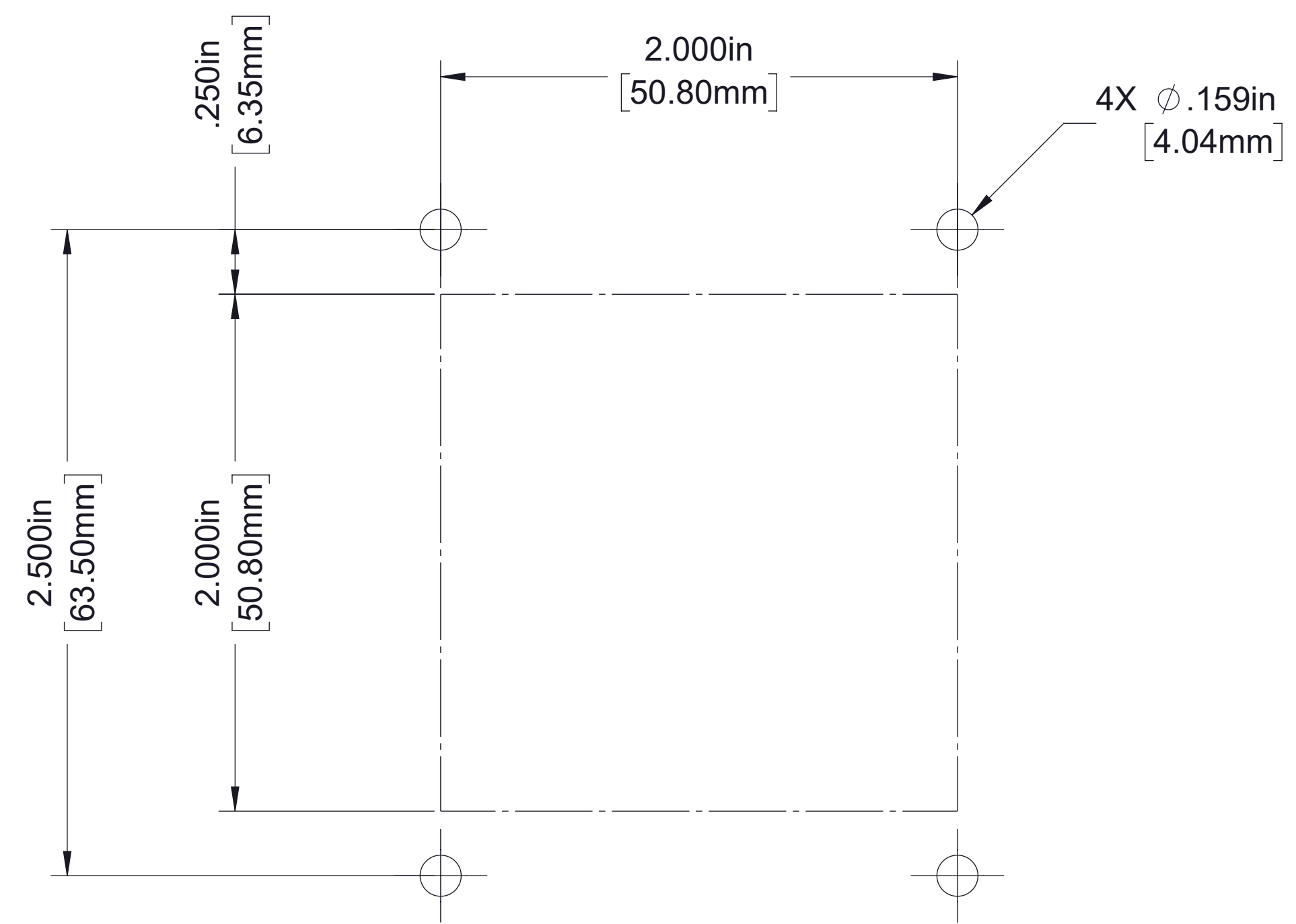

Panel Hole Layout

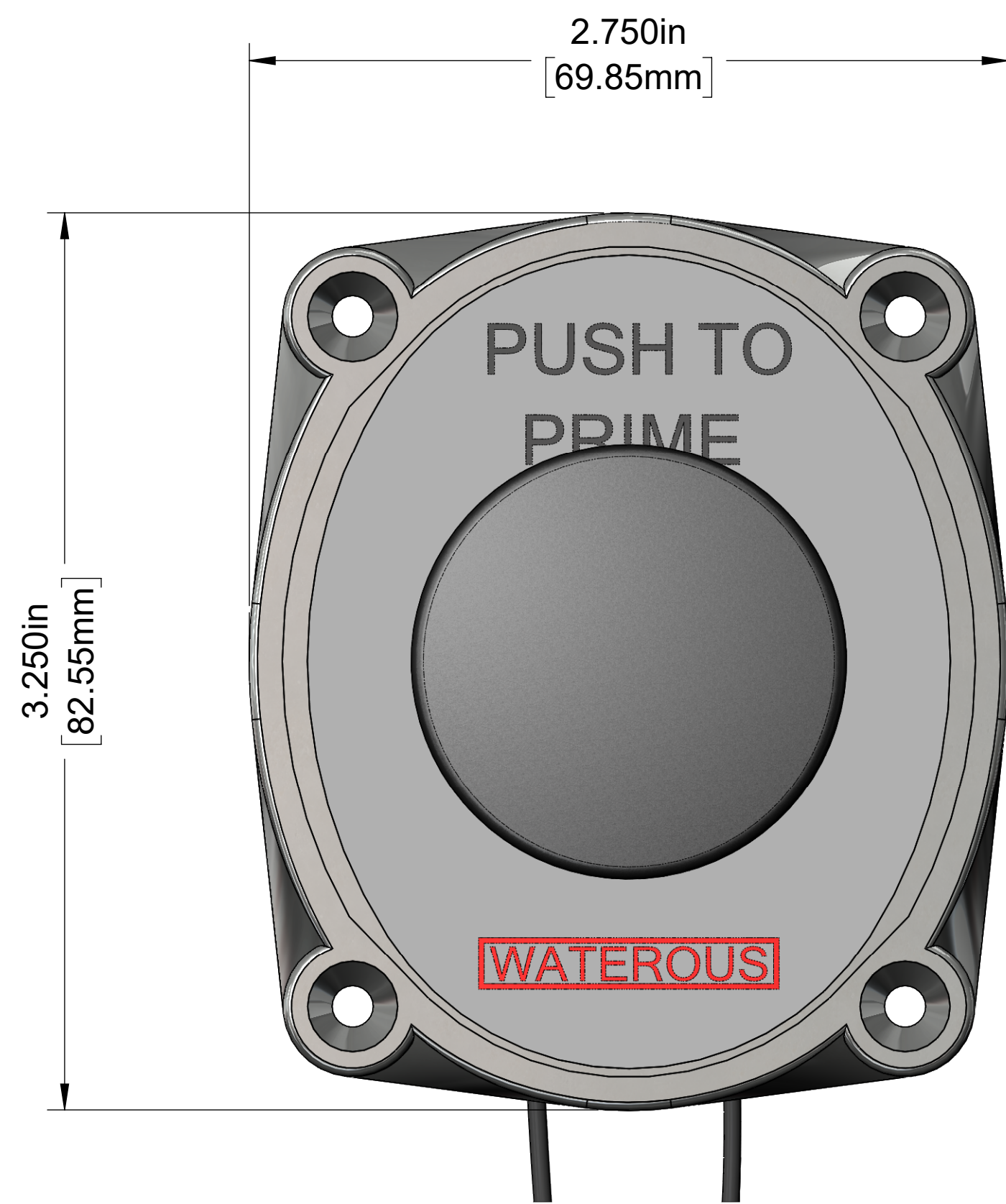

**Oversize Push-Button
(Mounting Hardware Included)**

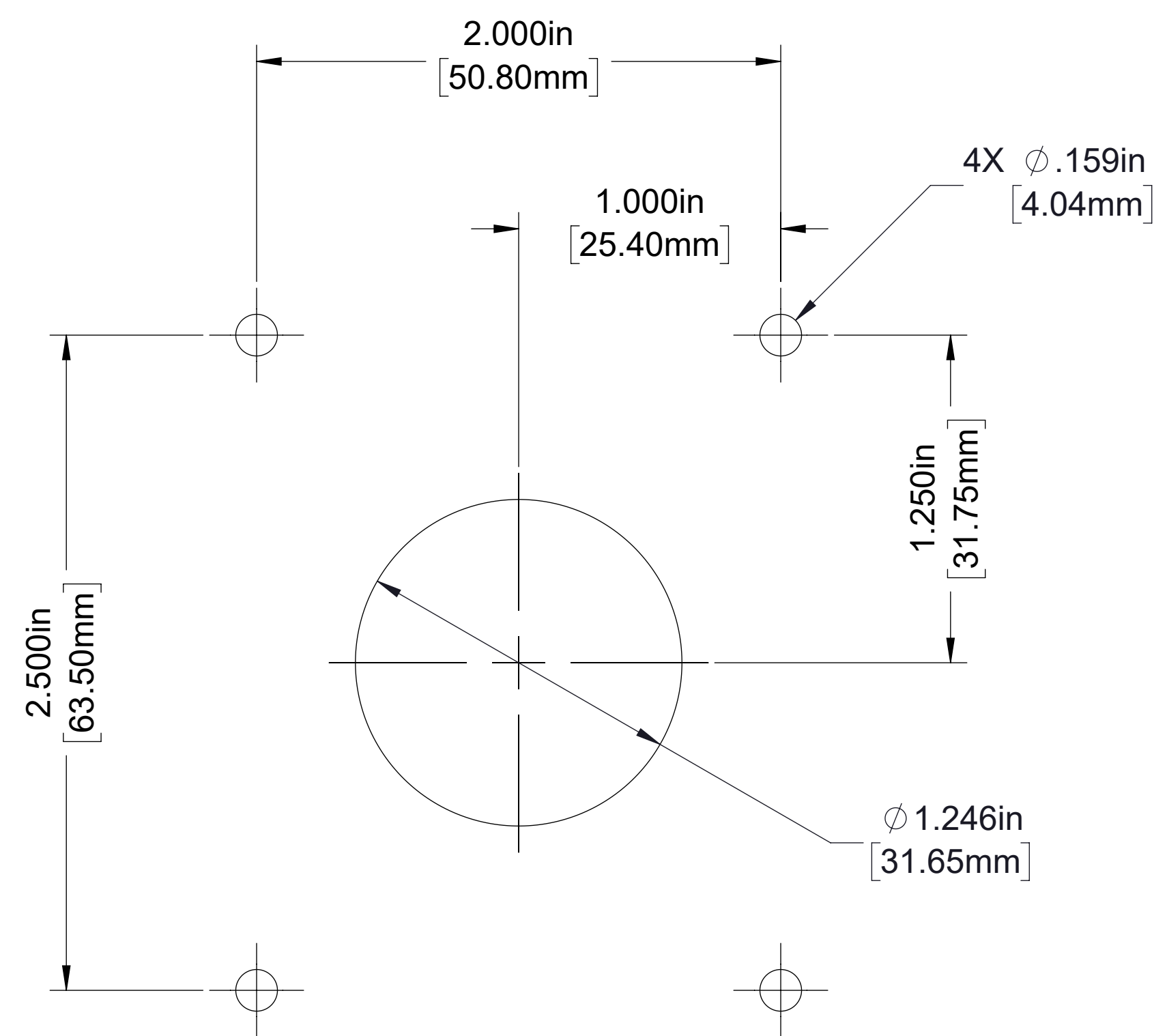

Panel Hole Layout