

MASTER WATERWAY CHECK VALVE

VALVE MANUFACTURER	VALVE SIZE	PAGE
AKRON	1.5	2
	2.0, 2.5, 3.0	3
ELKHART	1.5	4
	2.0, 2.5, 3.0	5

SPL83380

Released: 1/30/2015 DRN: JLB CHK: RAJ
Revised: 1/31/2018 REV BY: JLB REV CHK: RDE REV: A

REV DESC: CONVERTED TO SOLIDWORKS COMPOSER. ADDED ELKHART CHECK VALVES. ECR 13331

REF NO.	DESCRIPTION
450	Master Waterway Check Valve (Includes 451-458)
451	Check Valve, 1.5 in.
452	Flange-Adapter
453	Pipe Bushing 3/4" MNPT x 3/8" FNPT (Brass)
454	Elbow-90 Deg., 3/8 NPT (Brass)
455	Gasket, 1.5 in.
456	Hex Head Screw, 5/16-18 x 1-1/2 in.
457	Flat Washer, 5/16 in.
458	Hex Nut, 5/16-18

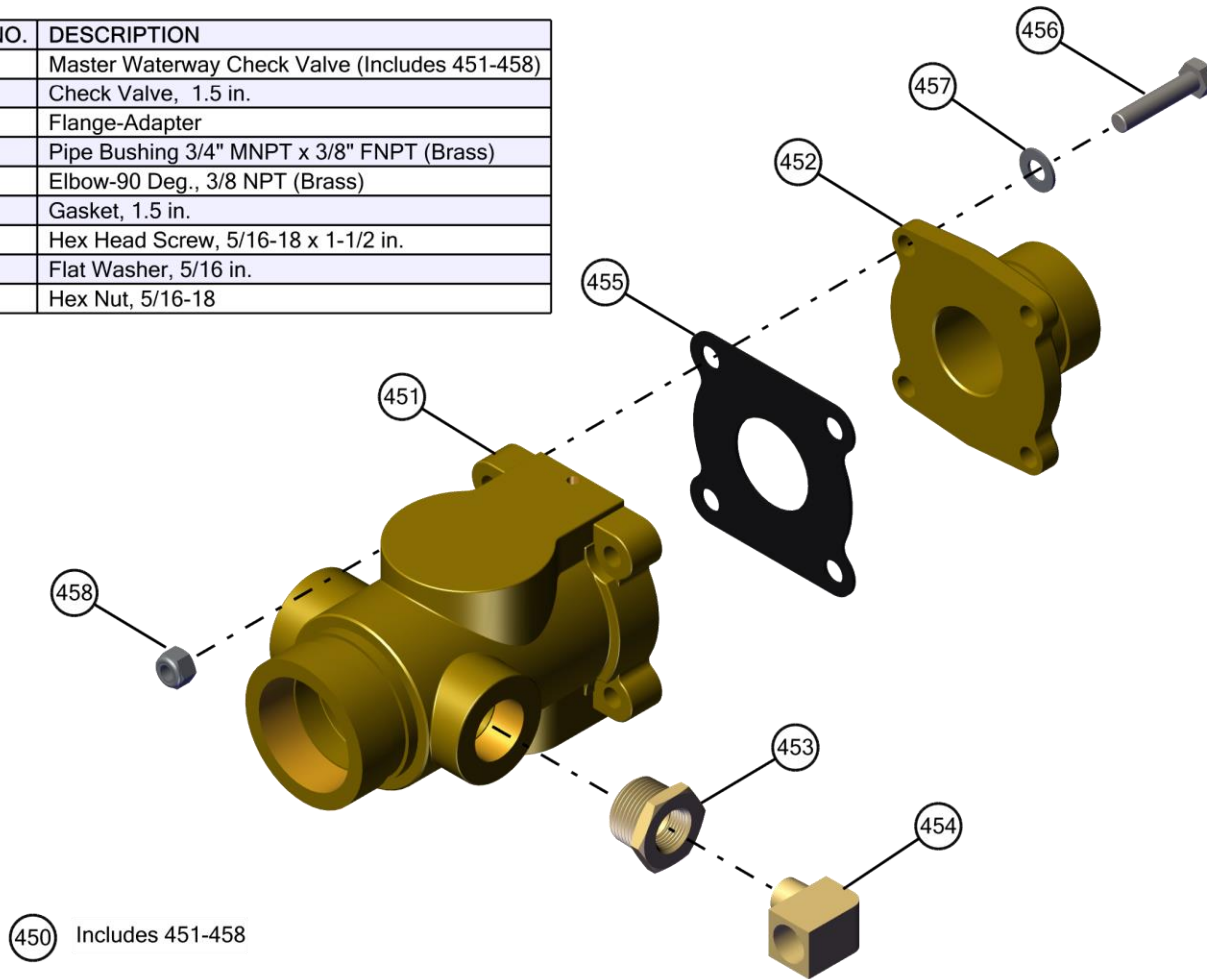

AKRON CHECK VALVE, 1.5 IN.

REF NO.	DESCRIPTION
450	Master Waterway Check Valve (Includes 451-459)
451	Check Valve, 2.0 or 2.5 or 3.0 in.
452	Flange-Adapter (Includes 456 & 459)
453	Pipe Bushing, 3/4 MNPT X 3/8 FNPT (Brass)
454	Street Elbow, 90 Deg., 3/8 NPT (Brass)
456	Hex Head Screw, 3/8-18 x 1-1/2 in.
457	Flat Washer, 3/8 in.
459	O-Ring

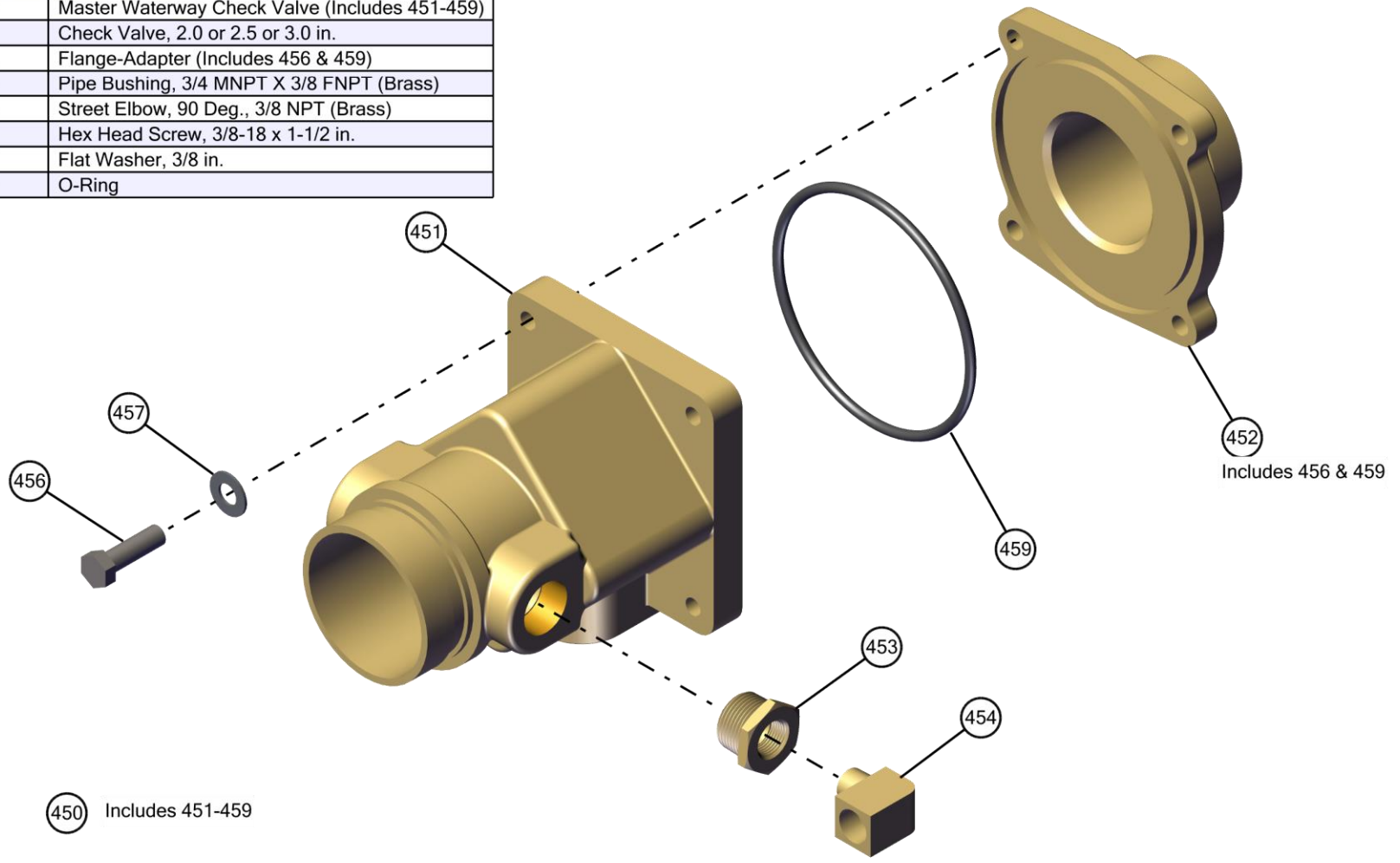

AKRON CHECK VALVE, 2.0, 2.5, 3.0

REF NO.	DESCRIPTION
450	Master Waterway Check Valve (Includes 451-458)
451	Check Valve, 1.5 in.
452	Flange-Adapter
453	Pipe Bushing, 3/4 MNPT x 3/8 FNPT (Brass)
454	Elbow-90 Deg., 3/8 NPT (Brass)
455	Gasket
456	Head Screw, 5/16-18 x 1-3/4 in.
457	Flat Washer, 5/16 in.
458	Hex Nut, 5/16-18

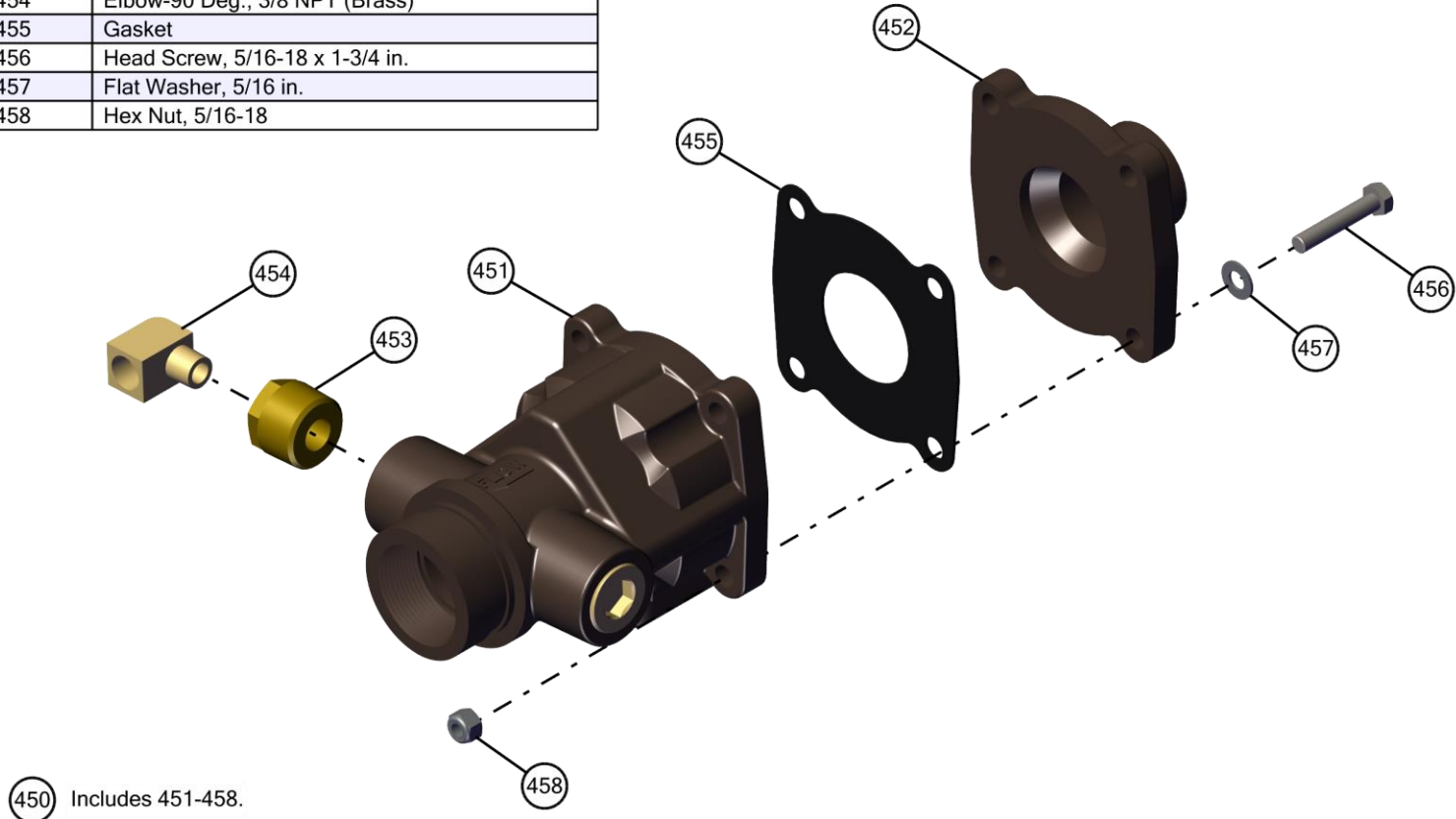

④50 Includes 451-458.

ELKHART CHECK VALVE, 1.5 IN.

REF NO.	DESCRIPTION
450	Master Waterway Check Valve (Includes 451-458)
451	Check Valve, 2.0 or 2.5 or 3.0 in.
452	Flange-Adapter
453	Pipe Bushing, 1 MNPT X 3/8 FNPT
454	Elbow- 90 Deg., 3/8 NPT
455	Gasket
456	Hex Head Screw 3/8-16 x 1-3/4 or 2-1/4 in.
457	Flat Washer, 3/8 in.
458	Hex Nut, 3/8-16

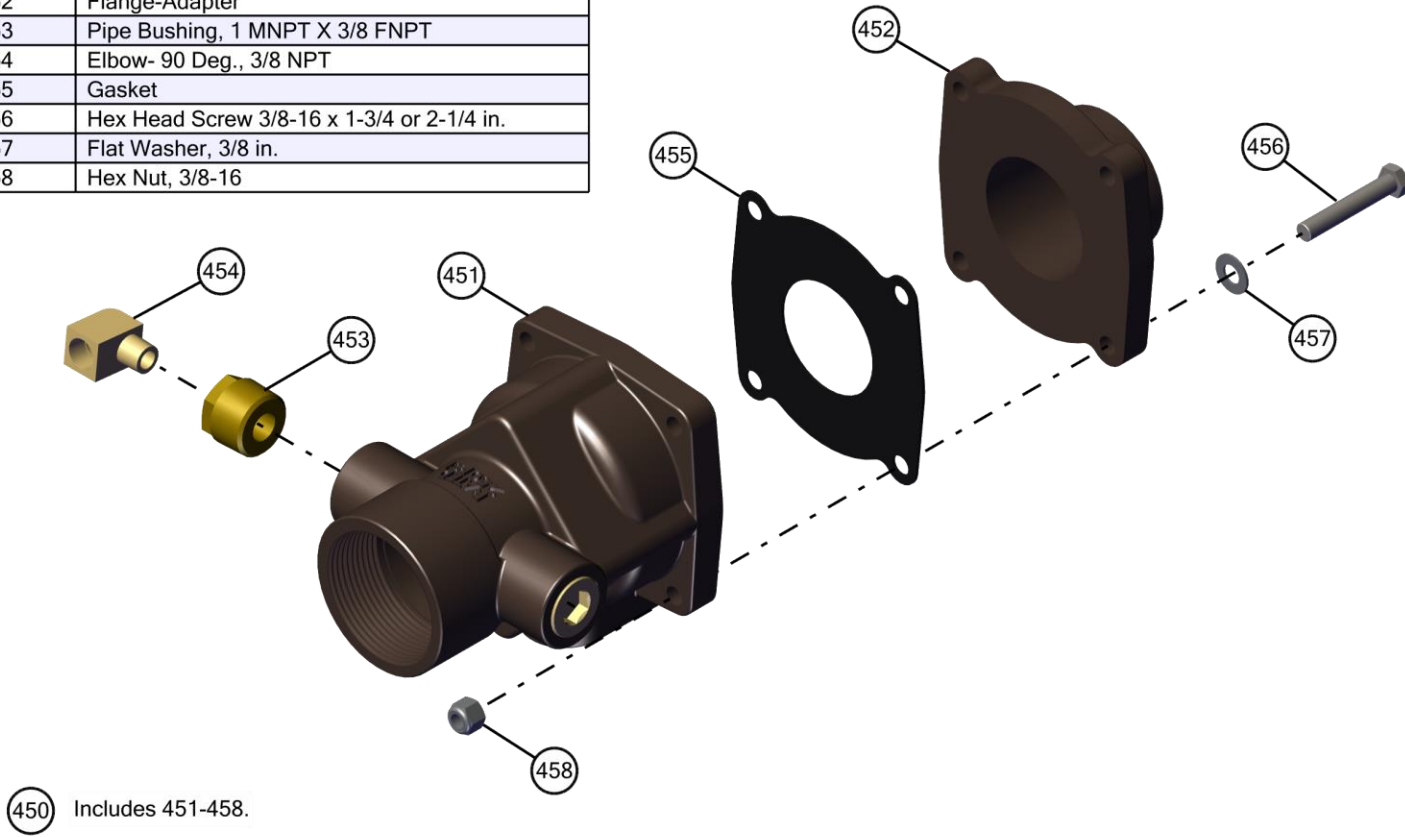

ELKHART CHECK VALVE, 2.0, 2.5, 3.0 IN.